

# FABRICATIONS - CLEATS

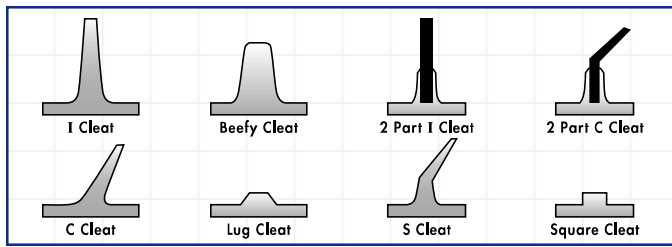

## BELTSERVICE CLEAT TYPES – AT A GLANCE

Cleats are available in white FDA or black oil-resisting nitrile, black SBR rubber, as well as black and white butyl. Two part cleats (page 28) consist of a rubber “foot” hot molded to the base belt and a bolted-in urethane cleat; these are for heavy-duty applications. High frequency PVC and PU cleats for thermoplastic belting are discussed on page 16.

## RUBBER, NITRILE, BUTYL, AND PVC CLEATS

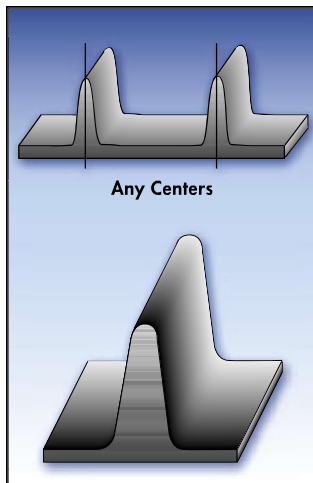

### STANDARD I CLEATS

- For conveying up steep inclines
- Available in white FDA or black oil-resisting nitrile, black SBR rubber, black and white butyl
- Cleats are hot molded into the belt surface (not cold bonded or cemented on)
- Smooth merging of cleat and belt cover for easy cleaning

Cleats can be molded to the belt surface on any center, to fit a wide variety of applications. Cleats come in heights from 1/2" to 5" (Beefy Cleats to 6"). [For taller cleats, a two-part construction is used -- see page 28.]

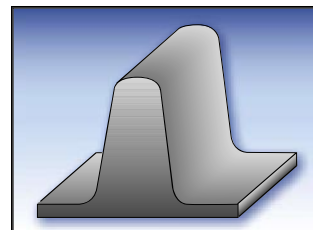

### BEEFY CLEATS

Beefy Cleats feature an extra-heavy cross section designed for heavy-duty, rugged applications. Thickness is double that of a standard I cleat. Available in heights from 1" - 6", with backup braces available with 2" and 3" heights.

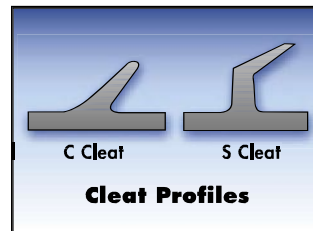

### HIGH INCLINE CLEATS

Aggressive scoop cleats for high-capacity conveying on steep inclines. C cleats are available in heights from 1" to 5", and S cleats come in heights from 4" to 4-1/2". Rugged cleats are hot vulcanized into the belt cover for long service.

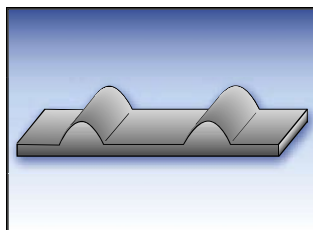

### MINI CLEATS

Mini-cleats are low-profile cleats ideal for moving products up inclines in light-duty applications. Unique shape allows for standard idler support on returns. Dimensions are 3/16" high, 3/16" wide at base and 1/8" radius.

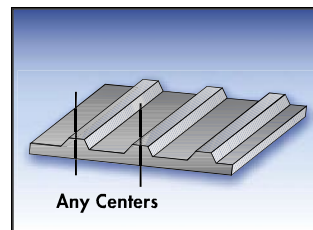

### LUG CLEATS

Lug construction features rugged V-belt shapes for impact resistance. Available in A (1/2" W x 5/16" H), B (5/8" W x 7/16" H), and C (7/8" W x 5/8" H) cross sections.

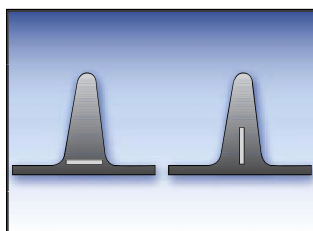

### STEEL-REINFORCED CLEATS

Super-strong cleat for the most rugged applications. Each cleat features a steel reinforcement oriented to best counter the forces encountered in a particular application.

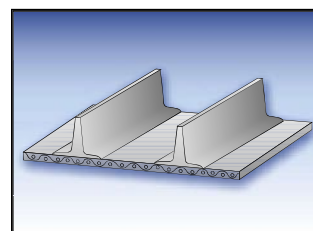

### PVC VINYL CLEATS

PVC cleats are welded to PVC belting to produce a rugged, economical combination ideal for wet, oily or acidic conditions. Available in black or white FDA compounds and can be spaced on any centers, indented, notched, cut down to intermediate heights and contain cut-outs.

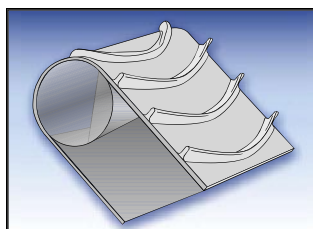

### CURVED PVC CLEATS

Ideal cleat for many incline applications requiring food-grade belting. Cleats up to 3" tall are available in 45° and 30° configurations. Cleats can be applied to belts 6" to 48" wide and on centers as close as 4-1/2" at 30° and 9" at 45°.

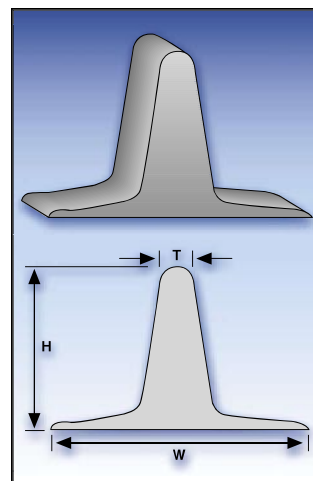

### PVC SCOOP CLEATS

White PVC cleats in an angled scoop form to improve capacity up steep inclines. Acceptable for food-handling applications. Available in 2", 2-1/2", and 3" heights, the cleats are hot welded into the belt surface for a smooth, seamless finish.

### PVC EXTRUDED CLEATS

Extruded PVC cleats conveniently packaged for distributors and OEMs to manufacture their own PVC cleated belt. PVC cleats are furnished in convenient 100-foot rolls.

(H) Height	(T) Thickness	(W) Base Width	Min. Pulley Diameter
1"	1/4"	1-1/2"	4"
1-1/2"	1/4"	1-5/8"	5"
2"	3/8"	1-3/4"	6"
3"	3/8"	1-3/4"	10"