

Tube Fittings & Adapters

Bore-MJ-MJ Tee 0702 Series

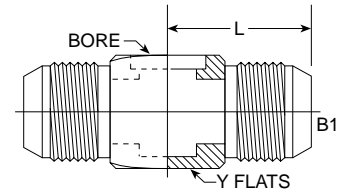

PART NO. SIZE	TUBE O.D.	B1 THREAD	BORE	L LGTH	M.M.	Y FLATS	Y FLATS	M.M.	Standard Material From Stock			
									S	FG	SS	B
0702-05-05-05	5/16	1/2-20	5/16	0.970	24.64	9/16	0.562	14.28	•			
0702-06-06-06	3/8	9/16-18	3/8	1.090	27.69	5/8	0.625	15.88	•			
0702-08-08-08	1/2	3/4-16	1/2	1.250	31.75	13/16	0.812	20.63	•			
0702-10-10-10	5/8	7/8-14	5/8	1.450	36.83	15/16	0.937	23.80	•			
0702-12-12-12	3/4	1 1/16	3/4	1.660	42.16	1 1/8	1.125	28.58	•			
0702-16-16-16	1	1 5/16	1	1.810	45.98	1 3/8	1.375	34.92	•			

Bore-FPS Straight 0800 Series

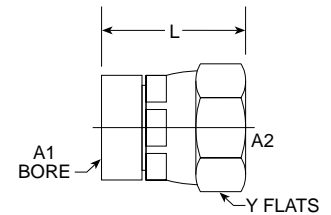

PART NO. SIZE	TUBE O.D.	A2 NPTF	A1 BORE	L LGTH	M.M.	Y FLATS	Y FLATS	M.M.	Standard Material From Stock			
									S	FG	SS	B
0800-08-06	1/2	3/8-18	1/2	1.023	25.99	7/8	0.875	22.22	•			

Bore-FPS 90° 0801 Series

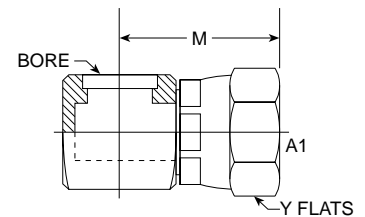

PART NO. SIZE	TUBE O.D.	A1 NPTF	BORE	M LGTH	M.M.	Y FLATS	Y FLATS	M.M.	Standard Material From Stock			
									S	FG	SS	B
0801-06-04	3/8	1/4-18	3/8	0.880	22.36	11/16	0.687	17.47	•			

Bore-FJS Straight 0900 Series

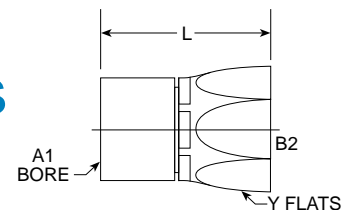

PART NO. SIZE	TUBE O.D.	B2 THREAD	A1 BORE	L LGTH	M.M.	Y FLATS	Y FLATS	M.M.	Standard Material From Stock			
									S	FG	SS	B
NEW 0900-04-04	1/4	7/16-20	1/4	0.900	22.86	9/16	0.562	14.28	•			
NEW 0900-08-08	3/8	1 1/16-12	3/4	1.625	41.28	1 1/4	1.250	31.75	•			
NEW 0900-12-12	3/4	1 1/16-12	3/4	1.625	41.28	1 1/4	1.250	31.75	•			
NEW 0900-16-16	1 1/4	1 5/8-12	1 1/4	1.950	49.54	2	2.000	50.80	•			