

FP-FPS Straight 1405 Series

SAE # 140131

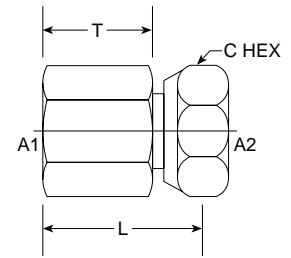

PART NO. SIZE	PIPE O.D.	A1 NPTF	A2 NPSM	L LGTH	M.M.	T WIDTH	M.M.	C HEX	C HEX	M.M.	Standard Material From Stock			
											S	FG	SS	B
1405-02-02	1/8	1/8-27	1/8-27	0.880	22.35	0.500	12.70	9/16	0.562	14.27	•		•	
1405-02-04	1/8 1/4	1/8-27	1/4-18	1.260	32.00	0.812	20.62	11/16	0.687	17.45	•		•	
1405-04-02	1/4 1/8	1/4-18	1/8-27	1.170	29.72	0.812	20.62	11/16	0.687	17.45	•		•	
1405-04-04	1/4	1/4-18	1/4-18	1.240	31.50	0.812	20.62	11/16	0.687	17.45	•		•	
1405-04-06	1/4 3/8	1/4-18	3/8-18	1.250	31.75	0.812	20.62	11/16	0.687	17.45	•		•	
NEW 1405-04-08											•		•	
1405-06-04	3/8 1/4	3/8-18	1/4-18	1.312	33.32	0.875	22.23	7/8	0.875	22.23	•		•	
1405-06-06	3/8	3/8-18	3/8-18	1.310	33.27	0.875	22.23	7/8	0.875	22.23	•		•	
1405-06-08	3/8 1/2	3/8-18	1/2-14	1.357	34.47	0.875	22.23	1	1.000	25.40	•		•	
1405-08-04	1/2 1/4	3/4-16	1/4-18	1.550	39.37	1.120	28.45	1	1.000	25.40	•		•	
1405-08-06	1/2 3/8	1/2-14	3/8-18	1.453	36.91	1.036	26.31	1	1.000	25.40	•		•	
1405-08-08	1/2	1/2-14	1/2-14	1.500	38.10	1.015	25.78	1	1.000	25.40	•		•	
1405-08-12	1/2 3/4	1/2-14	3/4-14	1.620	41.15	1.015	25.78	1 1/4	1.250	31.75	•		•	
1405-12-08	3/4 1/2	3/4-14	1/2-14	1.530	38.86	1.023	25.98	1 1/4	1.250	31.75	•		•	
1405-12-12	3/4	3/4-14	3/4-14	1.620	41.15	1.015	25.78	1 1/4	1.250	31.75	•		•	
1405-12-16	3/4 1	3/4-14	1-11 1/2	1.920	48.77	1.261	32.03	1 1/2	1.500	38.10	•		•	
1405-16-12	1 3/4	1-11 1/2	3/4-14	1.930	49.02	1.261	32.03	1 1/2	1.500	38.10	•		•	
1405-16-16	1	1-11 1/2	1-11 1/2	2.000	50.80	1.375	34.93	1 1/2	1.500	38.10	•		•	
1405-20-20	1 1/4	1 1/4-11 1/2	1 1/4-11 1/2	2.000	50.80	1.281	32.54	1 7/8	1.875	47.63	•		•	
1405-24-24	1 1/2	1 1/2-11 1/2	1 1/2-11 1/2	2.000	50.80	1.312	33.32	2 1/8	2.125	53.98	•		•	
1405-32-32	2	2-11 1/2	2-11 1/2	2.120	53.85	1.375	34.93	2 5/8	2.625	66.68	•		•	