

Tube Fittings & Adapters

MP-FPS 45° 1503 Series

SAE # 140330

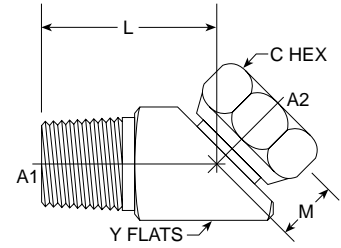

PART NO. SIZE	TUBE O.D.	A1 NPTF	A2 NPSM	L LGTH	M		C HEX	C HEX	Y FLATS	Y FLATS	Y FLATS	Standard Material From Stock					
					M.M.	LGTH M.M.						S	FG	SS	B		
1503-02-02	1/8	1/8-27	1/8-27	0.620	15.75	0.500	12.70	9/16	0.562	14.27	9/16	0.562	14.27	•	•	•	
1503-02-04	1/8 1/4	1/8-27	1/4-18	0.656	16.66	0.468	11.89	11/16	0.687	17.45	11/16	0.687	17.45	•			
1503-04-02	1/4 1/8	1/4-18	1/8-27	0.910	23.11	0.510	12.95	9/16	0.562	14.27	11/16	0.687	17.45	•			
1503-04-04*	1/4	1/4-18	1/4-18	0.940	23.88	0.690	17.53	11/16	0.687	17.45	11/16	0.687	17.45	•	•	•	
1503-04-06	1/4 3/8	1/4-18	3/8-18	0.750	19.05	1.062	26.97	7/8	0.875	22.23	7/8	0.875	22.23	•			
1503-04-08	1/4 1/2	1/4-18	1/2-14	1.310	33.27	0.690	17.53	1	1.000	25.40	1	1.000	25.40	•			
1503-06-04	3/8 1/4	3/8-18	1/4-18	0.625	15.88	1.062	26.97	11/16	0.687	17.45	7/8	0.875	22.23	•			
1503-06-06	3/8	3/8-18	3/8-18	1.060	26.92	0.750	19.05	7/8	0.875	22.23	7/8	0.875	22.23	•	•	•	
1503-06-08	3/8 3/8	3/8-18	1/2-14	0.781	19.84	1.187	30.15	1	1.000	25.40	1	1.000	25.40	•			
1503-08-04	1/2 1/4	3/4-16	1/4-18	0.734	18.64	1.375	34.93	11/16	0.687	17.45	1	1.000	25.40	•			
1503-08-06	1/2 3/8	1/2-14	3/8-18	0.828	21.03	1.375	34.93	7/8	0.875	22.23	1	1.000	25.40	•			
1503-08-08*	1/2	1/2-14	1/2-14	1.310	33.27	0.880	22.35	1	1.000	25.40	1	1.000	25.40	•	•	•	
1503-08-12	1/2 3/4	1/2-14	3/4-14	1.500	38.10	1.000	25.40	1 1/4	1.250	31.75	1 1/4	1.250	31.75	•			
1503-12-06	3/8	3/4-14	3/8-18	1.326	33.68	1.000	25.40	7/8	0.875	22.23	1 1/4	1.250	31.75	•			
1503-12-08	3/4 1/2	3/4-14	1/2-14	0.875	22.23	1.150	29.21	1	1.000	25.40	1 1/4	1.250	31.75	•	•	•	
1503-12-12	3/4	3/4-14	3/4-14	1.500	38.10	1.000	25.40	1 1/4	1.250	31.75	1 1/4	1.250	31.75	•	•	•	
1503-12-16	3/4 1	3/4-14	1-11 1/2	0.046	01.17	1.312	33.32	1 1/2	1.500	38.10	1 1/2	1.500	38.10	•			
1503-16-12	1 3/4	1-11 1/2	3/4-14	1.031	26.19	1.500	38.10	1 1/4	1.250	31.75	1 1/2	1.500	38.10	•			
1503-16-16	1	1-11 1/2	1-11 1/2	1.500	38.10	1.060	26.92	1 1/2	1.500	38.10	1 1/2	1.500	38.10	•	•	•	
1503-16-20	1 1 1/4	1-11 1/2	1 1/4-11 1/2	1.750	44.45	1.065	27.05	1 7/8	1.875	47.63	1 7/8	1.875	47.63	•			
1503-20-16	1 1/4 1	1 1/4-11 1/2	1-11 1/2	1.296	32.92	1.796	45.62	1 1/2	1.500	38.10	1 7/8	1.875	47.63	•			
1503-20-20	1 1/4	1 1/4-11 1/2	1 1/4-11 1/2	1.750	44.45	1.250	31.75	1 7/8	1.875	47.63	1 7/8	1.875	47.63	•			
1503-24-24	1 1/2	1 1/2-11 1/2	1 1/2-11 1/2	1.940	49.28	1.380	35.05	2 1/8	2.125	53.98	2 1/8	2.125	53.98	•	•	•	
1503-32-32	2	2-11 1/2	2-11 1/2	2.000	50.80	1.500	38.10	2 5/8	2.625	66.68	2 5/8	2.625	66.68	•			

*Note: Available in blanks.

FP-FPS 45° 1504 Series

SAE # 140331

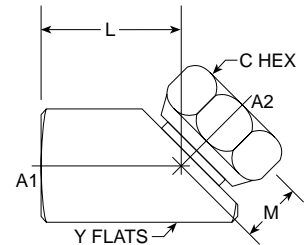

PART NO. SIZE	TUBE O.D.	A1 NPTF	A2 NPSM	L LGTH	M		C HEX	C HEX	Y FLATS	Y FLATS	Y FLATS	Standard Material From Stock					
					M.M.	LGTH M.M.						S	FG	SS	B		
1504-02-02	1/8	1/8-27	1/8-27	0.500	12.70	0.460	11.68	9/16	0.562	14.27	9/16	0.562	14.27				
1504-02-04	1/8 1/4	1/8-27	1/4-18	0.500	12.70	0.560	14.22	11/16	0.687	17.45	11/16	0.687	17.45				
1504-04-04	1/4	1/4-18	1/4-18	0.656	16.66	0.906	23.01	11/16	0.687	17.45	11/16	0.687	17.45				
1504-04-06	1/4 3/8	1/4-18	3/8-18	0.734	18.64	1.004	25.50	7/8	0.875	22.23	7/8	0.875	22.23				
1504-06-04	3/8 1/4	3/8-18	1/4-18	1.062	26.97	0.625	15.88	11/16	0.687	17.45	7/8	0.875	22.23				
1504-06-06	3/8	3/8-18	3/8-18	0.734	18.64	1.062	26.97	7/8	0.875	22.23	7/8	0.875	22.23				
1504-06-08	3/8 1/2	3/8-18	1/2-14	0.781	19.84	1.375	34.93	1	1.000	25.40	1	1.000	25.40				
1504-08-06	1/2 3/8	1/2-14	3/8-18	1.375	34.93	0.785	19.94	7/8	0.875	22.23	1	1.000	25.40				
1504-08-08	1/2	1/2-14	1/2-14	0.781	19.84	1.375	34.93	1	1.000	25.40	1	1.000	25.40				
NEW 1504-12-08																	
1504-12-12	3/4	3/4-14	3/4-14	1.000	25.40	1.250	31.75	1 1/4	1.250	31.75	1 1/4	1.250	31.75				
1504-16-12	1 3/4	1-11 1/2	3/4-14	1.500	38.10	1.031	26.19	1 1/4	1.250	31.75	1 1/2	1.500	38.10				
1504-16-16	1	1-11 1/2	1-11 1/2	1.046	26.57	1.500	38.10	1 1/2	1.500	38.10	1 1/2	1.500	38.10				
1504-20-20	1 1/4	1 1/4-11 1/2	1 1/4-11 1/2	1.328	33.73	1.781	45.24	1 7/8	1.875	47.63	1 7/8	1.875	47.63				
1504-24-24	1 1/2	1 1/2-11 1/2	1 1/2-11 1/2	1.250	31.75	1.968	49.99	2 1/8	2.125	53.98	2 1/8	2.125	53.98				