

Tube Fittings & Adapters

FPS-FPS-FPS Tee 1603 Series

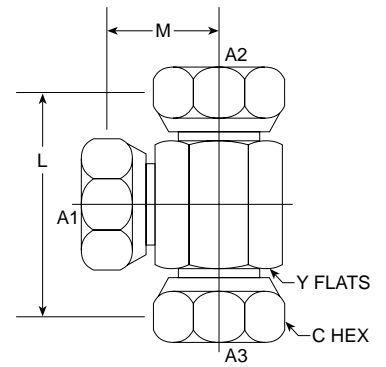

PART NO. SIZE	TUBE O.D.	A1 NPTF	A2 NPSM	A3 NPSM	L LGTH	M M.M.	C HEX	C HEX	Y M.M.	Y FLATS	Y M.M.	Standard Material From Stock						
												S	FG	SS	B			
1603-02-02-02	1/8	1/8-27	1/8-27	1/8-27	1.406	35.71	0.656	16.66	9/16	0.562	14.27	9/16	0.562	14.27	•			
1603-04-04-04	1/4	1/4-18	1/4-18	1/4-18	1.718	43.64	0.781	19.84	11/16	0.687	17.45	11/16	0.687	17.45	•		•	
1603-04-04-06	1/4	1/4-18	1/4-18	3/8-18	1.718	43.64	0.878	22.30	11/16	0.687	17.45	7/8	0.875	22.23	•			
1603-06-06-06	3/8	3/8-18	3/8-18	3/8-18	1.718	43.64	0.937	23.80	7/8	0.875	22.23	7/8	0.875	22.23	•			
1603-06-06-08	3/8	3/8-18	3/8-18	1/2-14	2.190	55.63	0.949	24.10	1	1.000	25.40	1	1.000	25.40	•			
1603-08-08-08	1/2	1/2-14	1/2-14	1/2-14	2.218	56.34	1.000	25.40	1	1.000	25.40	1	1.000	25.40	•	•		
1603-12-12-12	3/4	3/4-14	3/4-14	3/4-14	2.781	70.64	1.250	31.75	1 1/4	1.250	31.75	1 1/4	1.250	31.75	•			
1603-16-16-16	1	1-11 1/2	1-11 1/2	1-11 1/2	3.062	77.77	1.390	35.31	1 1/2	1.500	38.10	1 1/2	1.500	38.10	•			
1603-20-20-20	1 1/4	1 1/4-11 1/2	1 1/4-11 1/2	1 1/4-11 1/2	3.312	84.12	1.656	42.06	1 7/8	1.875	47.63	1 7/8	1.875	47.63	•			

MP-FPS-FPS-FPS Cross 1604 Series

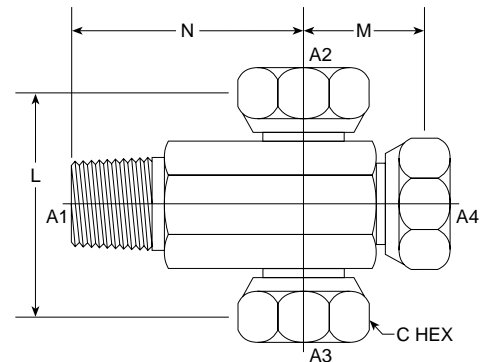

PART NO. SIZE	TUBE O.D.	A1 NPTF	A2 NPSM	A3 NPSM	A4 NPSM	L LGTH	M M.M.	N M.M.	C HEX	C HEX	M.M.	Standard Material From Stock						
												S	FG	SS	B			
1604-04-04-04-04	1/4	1/4-18	1/4-18	1/4-18	1/4-18	1.580	40.13	0.880	22.35	1.09	27.69	11/16	0.687	17.46	•			