

Tube Fittings & Adapters

MP-MJ Bulkhead Straight 2706 Series

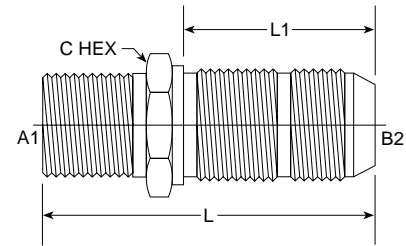

PART NO. SIZE	TUBE O.D.	A1 NPTF	B2 SAE 37	L LGTH M.M.	L1 LGTH M.M.	C HEX	C HEX	M.M.	PLATE MAX	Standard Material From Stock					
										S	FG	SS	B		
2706-02-04	1/4	1/8-27	7/16-20	1.840	46.74	1.200	30.48	11/16	0.687	17.45	27/64	•		•	
2706-04-04	1/4	1/4-18	7/16-20	2.040	51.82	1.200	30.48	11/16	0.687	17.45	27/64	•		•	
2706-04-06	3/8	1/4-18	9/16-18	2.190	55.63	1.280	32.51	13/16	0.812	20.62	27/64	•		•	
2706-06-06	3/8	3/8-18	9/16-18	2.190	55.63	1.280	32.51	13/16	0.812	20.62	27/64	•		•	
2706-06-08	1/2	3/8-18	3/4-16	2.350	59.69	1.440	36.58	1	1.000	25.40	31/64	•		•	
2706-08-08	1/2	1/2-14	3/4-19	2.570	65.28	1.440	36.58	1	1.000	12.70	31/64	•		•	
2706-08-10	5/8	1/2-14	7/8-14	2.720	69.09	1.580	40.13	1 1/8	1.125	28.58	29/64	•		•	
2706-08-12	3/4	1/2-14	1 1/16-12	2.920	74.17	1.750	44.45	1 3/8	1.375	34.93	???	•		•	
2706-12-12	3/4	3/4-14	1 1/16-12	2.920	74.17	1.750	44.45	1 3/8	1.375	34.93	33/64	•		•	
NEW 2706-12-16	1	1-11 1/2	1 5/16-12	3.100	78.74	1.750	44.45	1 5/8	1.625	41.28	27/64	•		•	
2706-16-16	1 1/4	1 1/4-11 1/2	1 5/8-12	3.230	82.04	1.800	45.72	1 7/8	1.875	47.63	27/64	•		•	
2706-20-20	1 1/2	1 1/2-11 1/2	1 7/8-12	3.450	87.63	1.810	45.97	2 1/8	2.125	53.97	21/64	•		•	
2706-24-24	2	2-11 1/2	2-11 1/2	3.890	98.81	2.090	53.09	2 3/4	2.750	69.85	9/16	•		•	

MP-FP Low Profile 90° 3051 Series

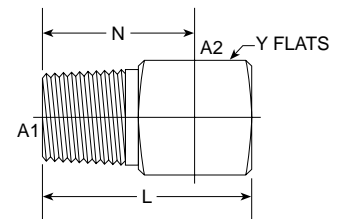

PART NO. SIZE	TUBE O.D.	A1 NPTF	A2 NPTF	L LGTH M.M.	N LGTH M.M.	Y FLATS	Y FLATS	M.M.	Standard Material From Stock					
									S	FG	SS	B		
3051-02-02	1/8	1/8-27	1/8-27	1.020	25.91	0.750	25.91	1/2	0.500	12.70	•		•	
3051-04-04	1/4	1/4-18	1/4-18	2.007	50.98	1.570	39.88	7/8	0.875	22.23	•		•	
3051-06-06	3/8	3/8-18	3/8-18	2.007	50.98	1.570	39.88	7/8	0.875	22.23	•		•	
3051-08-08	1/2	1/2-14	1/2-14	2.562	65.07	2.000	50.80	1 1/8	1.125	28.58	•		•	
3051-12-12	3/4	1 1/16-12	3/4-14	2.937	74.60	2.250	57.15	1 3/8	1.375	34.93	•		•	