

MORB-FPS Straight 6900-O Series

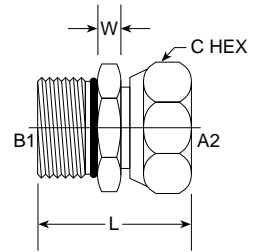

PART NO. SIZE	PORT O.D.	B1 SAE ORB	A2 NPSM	L LGTH	M.M.	W WIDTH	M.M.	C HEX	C HEX	M.M.	Standard Material From Stock			
											S	FG	SS	B
6900-04-02-O	1/4	7/16-20	1/8-27	1.060	26.92	0.363	9.22	9/16	0.562	14.27	•		•	
6900-04-04-O	1/4	7/16-20	1/4-18	1.109	28.17	0.280	7.11	9/16	0.562	14.27	•		•	
6900-04-06-O	1/4	7/16-20	3/8-18	1.150	29.21	0.340	8.64	11/16	0.687	17.45	•		•	
6900-04-08-O	1/4	7/16-20	1/2-14	1.210	30.73	0.310	7.87	7/8	0.875	22.23	•			
6900-05-04-O	5/16	1/2-20	1/4-18	1.092	27.74	0.280	7.11	5/8	0.625	15.88	•			
6900-05-08-O	5/16	1/2-20	1/2-14	1.210	30.73	0.310	7.87	7/8	0.875	22.23	•			
6900-06-04-O	3/8	9/16-18	1/4-18	1.062	26.97	0.310	7.87	11/16	0.687	17.45	•			
6900-06-06-O	3/8	9/16-18	3/8-18	1.171	29.74	0.310	7.87	11/16	0.687	17.45	•		•	
6900-06-08-O	3/8	9/16-18	1/2-14	1.234	31.34	0.310	7.87	7/8	0.875	22.23	•			
6900-08-04-O	1/2	3/4-16	1/4-18	1.217	30.91	0.340	8.64	7/8	0.875	22.23	•			
6900-08-06-O	1/2	3/4-16	3/8-18	1.234	31.34	0.340	8.64	7/8	0.875	22.23	•			
6900-08-08-O	1/2	3/4-16	1/2-14	1.240	31.50	0.340	8.64	7/8	0.875	22.23	•		•	
6900-08-12-O	1/2	3/4-16	3/4-14	1.406	35.71	0.340	8.64	1	1.000	25.40	•			
6900-10-06-O	5/8	7/8-14	3/8-18	1.358	34.49	0.410	10.41	1	1.000	25.40	•		•	
6900-10-08-O	5/8	7/8-14	1/2-14	1.330	33.78	0.410	10.41	1	1.000	25.40	•		•	
6900-10-12-O	5/8	7/8-14	3/4-14	1.482	37.64	0.410	10.41	1	1.000	25.40	•		•	
6900-12-06-O	3/4	1 1/16-12	3/8-18	1.530	38.86	0.500	12.70	1 1/4	1.250	31.75	•			
6900-12-08-O	3/4	1 1/16-12	1/2-14	1.438	36.53	0.470	11.94	1 1/4	1.250	31.75	•		•	
6900-12-12-O	3/4	1 1/16-12	3/4-14	1.578	40.08	0.470	11.94	1 1/4	1.250	31.75	•		•	
6900-12-16-O	3/4	1 1/16-12	1-11 1/2	1.630	41.40	0.470	11.94	1 1/2	1.500	38.10	•			
6900-14-12-O	7/8	1 3/16-12	3/4-14	1.683	42.75	0.470	11.94	1 3/8	1.375	34.93	•			
6900-14-16-O	7/8	1 3/16-12	1-11 1/2	1.733	44.02	0.500	12.70	1 3/8	1.375	34.93	•			
6900-16-08-O	1	1 5/16-12	1/2-14	1.610	40.89	0.530	13.46	1 1/2	1.500	38.10	•			
6900-16-12-O	1	1 5/16-12	3/4-14	1.710	43.43	0.500	12.70	1 1/2	1.500	38.10	•			
6900-16-16-O	1	1 5/16-12	1-11 1/2	1.710	43.43	0.500	12.70	1 1/2	1.500	38.10	•		•	
6900-16-20-O	1	1 5/16-12	1 1/4-11 1/2	1.900	48.26	0.580	14.73	1 7/8	1.875	47.63	•			
6900-20-12-O	1 1/4	1 5/8-12	3/4-14	1.780	45.21	0.650	16.51	1 7/8	1.875	47.63	•			
6900-20-16-O	1 1/4	1 5/8-12	1 1/4-11 1/2	1.828	46.43	0.580	14.73	1 7/8	1.875	47.63	•		•	
6900-20-20-O	1 1/4	1 5/8-12	1 1/4-11 1/2	1.710	43.43	0.580	14.73	1 7/8	1.875	47.63	•		•	
6900-24-20-O	1 1/2	1 7/8-12	1 1/4-11 1/2	1.980	50.29	0.650	16.51	2 1/8	2.125	53.98	•			
6900-24-24-O	1 1/2	1 7/8-12	1 1/2-11 1/2	1.953	49.61	0.650	16.51	2 1/8	2.125	53.98	•		•	
6900-32-32-O	2	2 1/2-12	2-11 1/2	2.156	54.76	0.810	20.57	2 3/4	2.750	69.85	•			