

# Metric MM Hollow Hex Plug 8555-H Series

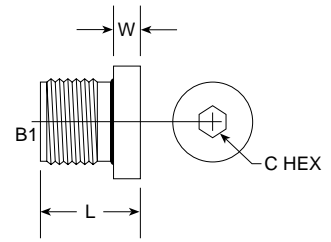

PART NO. SIZE	B1 MM	L LGTH M.M.	W WIDTH M.M.	C HEX M.M.	Standard Material From Stock			
					S	FG	SS	B
NEW 8555-H10-0					•			
NEW 8555-H12-0					•			
NEW 8555-H14-0					•			
NEW 8555-H16-0					•			
8555-H18-0	18 x 1.5	17.00	5	8	•			
8555-H22-0	22 x 1.5	19.10	5	10	•			
NEW 8555-H24-0					•			
NEW 8555-H26-0					•			

# Metric MM Plug 1.5 Pitch 8555-P Series

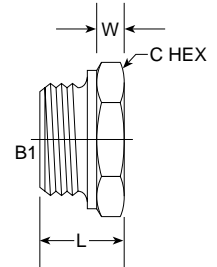

PART NO. SIZE	B1 MM	L LGTH M.M.	W WIDTH M.M.	C HEX M.M.	Standard Material From Stock			
					S	FG	SS	B
8555-P-10	10 x 1.0	12.00	4	11	•			
8555-P-12	12 x 1.5	16.70	7	18	•			
8555-P-14	14 x 1.5	17.40	8	19	•			
8555-P-16	14 x 1.5	16.40	8	22	•			
8555-P-18	18 x 1.5	17.10	8	23	•			
8555-P-20	20 x 1.5	16.80	8	26	•			
8555-P-24	24 x 1.5	17.60	8	33	•			
8555-P-26	26 x 1.5	17.60	8	33	•			
NEW 8555-P-36					•			

PART NO. SIZE	I.D. M.M.	O.D. M.M.	Standard Material From Stock			
			S	FG	SS	B
8800-06	6	10	•			
8800-08	8	13	•			
8800-10	10	18	•			
8800-12	12	20	•			
8800-14	14	22	•			
8800-16	16	24	•			
8800-18	18	26	•			
8800-20	20	28	•			
8800-22	22	30	•			
NEW 8800-24			•			
8800-26	26	35	•			
8800-27	27	36	•			
8800-30	30	39	•			
8800-33	33	43	•			
8800-36	36	46	•			
8800-42	42	53	•			
8800-52	52	64	•			

# Metric Bonded Seal 8800 Series

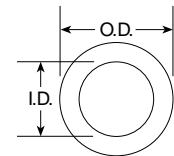

For metric threads.