

International Fittings

MBSPT-MBSPT Nipple 9000 Series

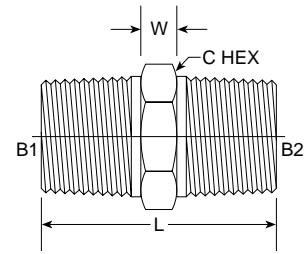

PART NO. SIZE	B1 BSPT	B2 BSPT	L LGTH M.M.	W LGTH M.M.	C HEX M.M.	Standard Material From Stock			
						S	FG	SS	B
9000-02-02	1/8-27	1/8-28	27.30	5	11.11	•			
9000-04-02	1/4-19	1/8-28	33.10	8	15.00	•			
9000-04-04	1/4-19	1/4-19	40.50	8	14.28	•			
9000-06-02	3/8-19	1/8-28	36.40	8	17.46	•			
9000-06-04	3/8-19	1/4-19	40.60	8	17.46	•			
9000-06-06	3/8-19	3/8-19	42.40	8	17.40	•			
9000-08-04	1/2-14	1/4-19	46.30	8	22.00	•			
9000-08-06	1/2-14	3/8-19	46.70	8	22.22	•			
9000-08-08	1/2-14	1/2-14	52.20	8	22.22	•			
9000-10-10	5/8-14	5/8-14	53.70	9	26.00	•			
9000-12-08	3/4-14	1/2-14	54.80	11	28.00	•			
9000-12-12	3/4-14	3/4-14	55.10	11	28.00	•			
9000-16-12	1-11	3/4-14	62.10	12.35	35.00	•			
9000-16-16	1-11	1-11	66.90	12	34.92	•			
9000-20-20	1 1/4-11	1 1/4-11	69.10	13	47.00	•			
9000-24-24	1 1/2-11	1 1/2-11	73.40	14	52.00	•			
9000-32-32	2-11	2-11	73.80	14	70.00	•			

MBSPT-FBSPT Bushing 9001 Series

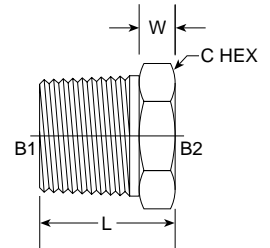

PART NO. SIZE	B1 BSPT	B2 BSPT	L LGTH M.M.	W WIDTH M.M.	C HEX M.M.	Standard Material From Stock			
						S	FG	SS	B
9001-04-02	1/4-19	1/8-28	23.80	8	14.28	•			
9001-06-04	3/8-19	1/4-19	25.85	8.57	17.46	•			
9001-08-06	1/2-14	3/8-19	25.30	6	22.02	•			
9001-12-08	3/4-14	1/2-14	31.90	10	28.00	•			
NEW 9001-16-12						•			
9001-20-16	1 1/4-11	1-11	40.60	12.70	47.22	•			

MBSPT-FBSPT 90° Elbow 9002 Series

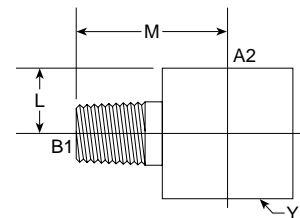

PART NO. SIZE	B1 BSPT	A2 BSPT	L LGTH M.M.	M LGTH M.M.	Y FLATS M.M.	Standard Material From Stock			
						S	FG	SS	B
9002-02-02	1/8-28	1/8-28	8	19	17.46	•			