

# DIN Metric Fittings

## Straight Male Stud Coupling Metric Parallel VS8051 Series

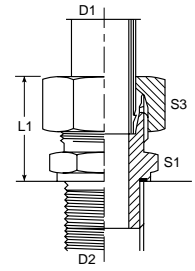

PRODUCT ID	DESCRIPTION	D1	D2	L1	S1	S3	Standard Material From Stock			
							S	FB	SS	B
VS8051-L06-10-PO	Straight Male Stud Coupling Metric Parallel	6	M 10X1	23	14	14	•			
VS8051-L08-12-PO	Straight Male Stud Coupling Metric Parallel	8	M 12X1.5	25	17	17	•			
VS8051-L10-14-PO	Straight Male Stud Coupling Metric Parallel	10	M 14X1.5	26	19	19	•			
VS8051-L12-16-PO	Straight Male Stud Coupling Metric Parallel	12	M 16X1.5	27	22	22	•			
VS8051-L15-18-PO	Straight Male Stud Coupling Metric Parallel	15	M 18X1.5	29	24	27	•			
VS8051-L18-22-PO	Straight Male Stud Coupling Metric Parallel	18	M 22X1.5	31	27	32	•			
VS8051-L22-26-PO	Straight Male Stud Coupling Metric Parallel	22	M 26X1.5	33	32	36	•			
VS8051-L28-33-PO	Straight Male Stud Coupling Metric Parallel	28	M 33X2	34	41	41	•			
VS8051-L35-42-PO	Straight Male Stud Coupling Metric Parallel	35	M 42X2	39	50	50	•			
VS8051-L42-48-PO	Straight Male Stud Coupling Metric Parallel	42	M 48X2	42	55	60	•			
VS8051-S06-12-PO	Straight Male Stud Coupling Metric Parallel	6	M 12X1.5	28	17	17	•			
VS8051-S08-14-PO	Straight Male Stud Coupling Metric Parallel	8	M 14X1.5	30	19	19	•			
VS8051-S10-16-PO	Straight Male Stud Coupling Metric Parallel	10	M 16X1.5	?	31	22	•			
VS8051-S12-18-PO	Straight Male Stud Coupling Metric Parallel	12	M 18x1.5	33	24	24	•			
VS8051-S14-20-PO	Straight Male Stud Coupling Metric Parallel	14	M 20x1.5	37	27	27	•			
VS8051-S16-22-PO	Straight Male Stud Coupling Metric Parallel	16	M 22x1.5	37	27	30	•			
VS8051-S20-27-PO	Straight Male Stud Coupling Metric Parallel	20	M 27x2	42.5	32	36	•			
VS8051-S25-33-PO	Straight Male Stud Coupling Metric Parallel	25	M 33x2	47	41	46	•			
VS8051-S30-42-PO	Straight Male Stud Coupling Metric Parallel	30	M 42x2	50	50	52	•			
VS8051-S38-48-PO	Straight Male Stud Coupling Metric Parallel	38	M 48x2	57	55	60	•			

## Straight Male Stud Coupling Metric Taper VS8052 Series

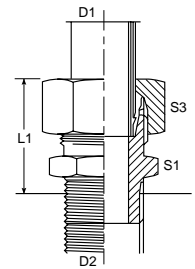

PRODUCT ID	DESCRIPTION	D1	D2	L1	S1	S3	Standard Material From Stock			
							S	FB	SS	B
VS8052-L06-10	Straight Male Stud Coupling Metric Taper	6	M 10x1 KEG	24.5	14	14	•			
VS8052-L08-12	Straight Male Stud Coupling Metric Taper	8	M 12x1.5 KEG	27	17	17	•			
VS8052-L10-14	Straight Male Stud Coupling Metric Taper	10	M 14x1.5 KEG	28	17	19	•			
VS8052-L12-16	Straight Male Stud Coupling Metric Taper	12	M 16x1.5 KEG	28.5	19	22	•			
VS8052-L15-18	Straight Male Stud Coupling Metric Taper	15	M 18x1.5 KEG	30	24	27	•			
VS8052-L18-22	Straight Male Stud Coupling Metric Taper	18	M 22x1.5 KEG	32	27	32	•			
VS8052-LL04-08	Straight Male Stud Coupling Metric Taper	4	M 8x1 KEG	20	10	10	•			
VS8052-S06-12	Straight Male Stud Coupling Metric Taper	3	M 12x1.5 KEG	30	17	17	•			
VS8052-S08-14	Straight Male Stud Coupling Metric Taper	8	M 14x1.5 KEG	32	17	19	•			
VS8052-S10-16	Straight Male Stud Coupling Metric Taper	10	M 16x1.5 KEG	32.5	19	22	•			
VS8052-S12-18	Straight Male Stud Coupling Metric Taper	12	M 18x1.5 KEG	34.5	22	24	•			
VS8052-S14-20	Straight Male Stud Coupling Metric Taper	14	M 20x1.5 KEG	38.5	27	27	•			
VS8052-S16-22	Straight Male Stud Coupling Metric Taper	16	M 22x1.5 KEG	38.5	27	30	•			