

DIN Metric Fittings

Straight Male Stud Coupling ISO VS8060 Series

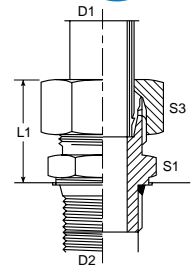

Standard Material From Stock

PRODUCT ID	DESCRIPTION	D1	D2	L1	S1	S3	Standard Material From Stock			
							S	FB	SS	B
VS8060-L08-12-ISO	Straight Male Stud Coupling ISO	8	M 12X1.5	25	17	17	•			
VS8060-L10-14-ISO	Straight Male Stud Coupling ISO	10	M 14X1.5	26	19	19	•			
VS8060-L28-33-ISO	Straight Male Stud Coupling ISO	28	M 33x2	34	41	41	•			
VS8060-S12-18-ISO	Straight Male Stud Coupling ISO	12	M 18x1.5	33	24	24	•			
VS8060-S20-27-ISO	Straight Male Stud Coupling ISO	20	M 27x2	42	27	30	•			
VS8060-S25-33-ISO	Straight Male Stud Coupling ISO	25	M 33x2	47	41	46	•			

Male Stud Elbow Metric Taper VS8202 Series

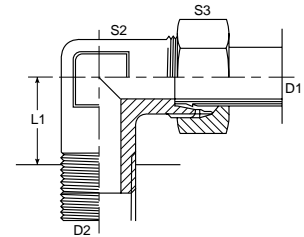

Standard Material From Stock

PRODUCT ID	DESCRIPTION	D1	D2	L1	S2	S3	Standard Material From Stock			
							S	FB	SS	B
VS8202-L06-10	Male Stud Elbow Metric Taper	6	M 10x1 KEG	21	14	12	•			
VS8202-L08-12	Male Stud Elbow Metric Taper	8	M 12x1.5 KEG	29	17	14	•			
VS8202-L10-14	Male Stud Elbow Metric Taper	10	M 14x1.5 KEG	30	19	17	•			
VS8202-L12-16	Male Stud Elbow Metric Taper	12	M 16x1.5 KEG	32	22	19	•			
VS8202-L15-18	Male Stud Elbow Metric Taper	15	M 18x1.5 KEG	36	27	19	•			
VS8202-L18-22	Male Stud Elbow Metric Taper	18	M 22x1.5 KEG	40	32	24	•			
VS8202-LL04-08	Male Stud Elbow Metric Taper	4	M 08x1.5 KEG	21	10	9	•			
VS8202-LL06-10	Male Stud Elbow Metric Taper	6	M 10x1.5 KEG	21	12	11	•			
VS8202-LL08-10	Male Stud Elbow Metric Taper	8	M 10x1.5 KEG	23	14	12	•			
VS8202-S06-12	Male Stud Elbow Metric Taper	6	M 12x1.5 KEG	31	17	14	•			
VS8202-S08-14	Male Stud Elbow Metric Taper	8	M 14x1.5 KEG	32	19	17	•			
VS8202-S10-16	Male Stud Elbow Metric Taper	10	M 16x1.5 KEG	34	22	19	•			
VS8202-S12-18	Male Stud Elbow Metric Taper	12	M 18x1.5 KEG	38	24	22	•			
VS8202-S14-20	Male Stud Elbow Metric Taper	14	M 20x1.5 KEG	40	27	19	•			
VS8202-S16-22	Male Stud Elbow Metric Taper	16	M 22x1.5 KEG	43	30	24	•			