

Gauge Coupling Male Stud Type VS9601 Series

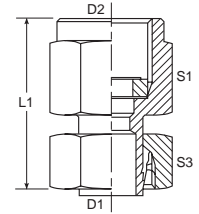

PRODUCT ID	DESCRIPTION	D1	D2	L1	S1	S3	Standard Material From Stock			
							S	FG	SS	B
VS9601-L06-04	Gauge Coupling Male Stud Type	8	G 1/4	38	19	17	•			
VS9601-L08-04	Gauge Coupling Male Stud Type	8	G 1/4	38	19	17	•			
VS9601-L10-04	Gauge Coupling Male Stud Type	10	G 1/4	39.5	19	19	•			
VS9601-L12-04	Gauge Coupling Male Stud Type	12	G 1/4	40.5	19	22	•			
VS9601-S06-08	Gauge Coupling Male Stud Type	6	G 1/2	45	27	17	•			
VS9601-S08-08	Gauge Coupling Male Stud Type	8	G 1/2	45	27	19	•			
VS9601-S10-08	Gauge Coupling Male Stud Type	10	G 1/2	47	27	22	•			
VS9601-S12-08	Gauge Coupling Male Stud Type	12	G 1/2	47.5	27	24	•			