

Plug NO304

INCH OD Tubes

Part No.	T Tube OD	G A/F
NO304-C-01	1/16	8
NO304-C-02	1/8	11
NO304-C-04	1/4	14
NO304-C-05	5/16	16
NO304-C-06	3/8	17
NO304-C-08	1/2	22
NO304-C-10	5/8	25
NO304-C-12	3/4	28.5
NO304-C-14	7/8	32
NO304-C-16	1	38
NO304-C-20	1-1/4	50
NO304-C-24	1-1/2	57
NO304-C-32	2	76

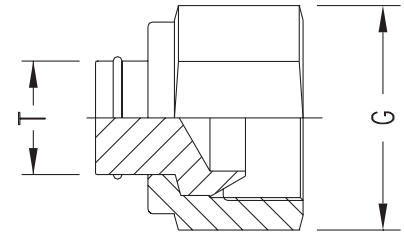

Special Installation Instructions For Adapters And Plugs

From finger-tight, tighten nut 1/4 turn only. Further connections are made by wrench tightening slightly after snugging nut by hand.

Nut NO318

INCH OD Tubes

Part No.	T Tube OD	L	G A/F
NO318-01	1/16	8.0	8
NO318-02	1/8	12.0	11
NO318-04	1/4	12.7	14
NO318-05	5/16	14.0	16
NO318-06	3/8	14.5	17
NO318-08	1/2	17.5	22
NO318-10	5/8	17.5	25
NO318-12	3/4	17.5	28.5
NO318-14	7/8	17.5	32
NO318-16	1	20.6	38
NO318-20	1-1/4	31.8	50
NO318-24	1-1/2	38.0	57
NO318-32	2	52.5	76

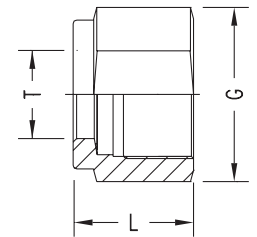

Back Ferrule NO319-B

INCH OD Tubes

Part No.	T Tube OD
NO319-B-01	1/16
NO319-B-02	1/8
NO319-B-04	1/4
NO319-B-05	5/16
NO319-B-06	3/8
NO319-B-08	1/2
NO319-B-10	5/8
NO319-B-12	3/4
NO319-B-14	7/8
NO319-B-16	1
NO319-B-20	1-1/4
NO319-B-24	1-1/2
NO319-B-32	2

