

# Push-To-Connect

## Male Run Tee – Fractional Inch Tube To Tube To Male NPT or UNF

ØD in	C NPT/UNF	Cat. No.	F mm	G in	H in	H1 in	L in	Scale oz
1/8	10-32	PCNY2605-02-10/32-02	8	.33	.92	.35	.57	.19
1/8	1/16	PCNY2605-02-01-02	10	.33	.93	.35	.57	.24
1/8	1/8	PCNY2605-02-02-02	11	.33	.93	.35	.57	.31
5/32	10-32	PCNY2605-02.5-10/32-02.5	8	.33	1.02	.45	.57	.18
5/32	1/8	PCNY2605-02.5-02-02.5	11	.33	.93	.53	.57	.32
5/32	1/4	PCNY2605-02.5-04-02.5	14	.33	.94	.37	.57	.64
3/16	1/8	PCNY2605-03-02-03	11	.45	1.31	.45	.85	.63
1/4	1/8	PCNY2605-04-02-04	11	.43	1.16	.45	.69	.39
1/4	1/4	PCNY2605-04-04-04	14	.43	1.12	.41	.69	.58
1/4	3/8	PCNY2605-04-06-04	18	.43	1.14	.43	.69	.84
5/16	1/8	PCNY2605-05-02-05	11	.53	1.38	.49	.91	.50
5/16	1/4	PCNY2605-05-04-05	14	.53	1.34	.45	.91	.69
5/16	3/8	PCNY2605-05-06-05	18	.53	1.36	.47	.91	.97
3/8	1/8	PCNY2605-06-02-06	15	.63	1.63	.60	1.04	.81
3/8	1/4	PCNY2605-06-04-06	15	.63	1.63	.60	1.04	.81
3/8	3/8	PCNY2605-06-06-06	18	.63	1.60	.55	1.04	1.19
3/8	1/2	PCNY2605-06-08-06	22	.63	1.63	.59	1.04	1.97
1/2	1/4	PCNY2605-08-04-08	20	.87	2.17	.79	1.38	1.85
1/2	3/8	PCNY2605-08-06-08	20	.87	2.17	.79	1.38	1.93
1/2	1/2	PCNY2605-08-08-08	24	.87	2.07	.79	1.38	2.19

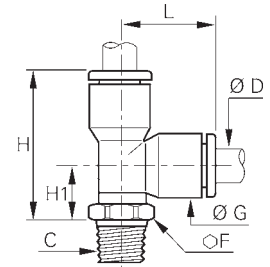

## Bulkhead Union – Tube To Tube

ØD in	Cat. No. (fractional inch)	F mm	K max in	L1 in	L2 in	T min in	Scale oz	Max Torque
1/8	PCNY2700-02-02	13	.22	.37	.61	.41	.64	11 lb. in.
5/32	PCNY2700-02.5-02.5	13	.22	.59	.39	.41	.67	11 lb. in.
1/4	PCNY2700-04-04	16	.35	.37	.81	.53	.24	13 lb. in.
5/16	PCNY2700-05-05	18	.57	.98	.53	.61	1.16	15 lb. in.
3/8	PCNY2700-06-06	22	.57	.51	1.18	.73	.65	22 lb. in.
1/2	PCNY2700-08-08	29	.81	.67	1.61	1.00	3.60	

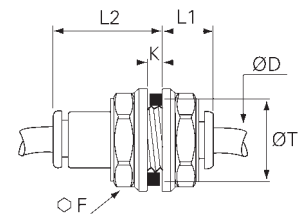

## Equal Bulkhead Elbow – Tube To Tube

ØD in	Cat. No. (fractional inch)	F1 mm	F2 mm	G in	H in	K max in	L in	T min in	Scale oz
1/8	PCNY2701-02-02	13	13	.35	.71	.28	.57	.41	.67
5/32	PCNY2701-02.5-02.5	–	13	.33	.83	.26	.67	.41	.67
1/4	PCNY2701-04-04	18	17	.43	.87	.32	.71	.61	.85
5/16	PCNY2701-05-05	–	18	.53	1.22	.31	.94	.61	1.23
3/8	PCNY2701-06-06	22	22	.63	1.08	.33	1.00	.73	2.80
1/2	PCNY2701-08-08	29	27	.87	1.54	.41	1.38	1.00	4.34

