

Clamp Ferrules

Tank Weld Ferrules (heavy wall) - 14MPW

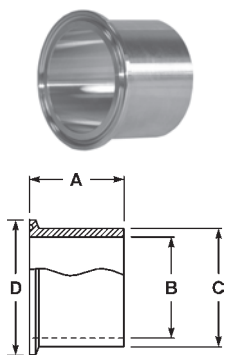

Tube OD	Dimensions				316L Stainless Steel	
	A	B	C	D	Part #	Price / Each
½"	1.625	.321	.502	.984	14MPW-R50	\$232.00
¾"	1.625	.574	.750	.984	14MPW-R75	232.00
1"	1.625	.870	1.160	1.984	14MPW-R100	37.60
1½"	1.625	1.370	1.676	1.984	14MPW-R150	37.60
2"	1.750	1.870	2.192	2.516	14MPW-R200	47.70
2½"	1.750	2.370	2.708	3.047	14MPW-R250	68.00
3"	1.813	2.870	3.224	3.579	14MPW-R300	91.40
4"	2.125	3.834	4.256	4.682	14MPW-R400	166.80
6"	2.500	5.758	6.192	6.562	14MPW-R600	1078.10

• ½" - 4" certified to ASME SA479; 6" certified to ASME SA312

Reducing Ferrules - B31WMP

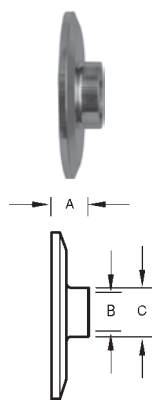

Tube OD	Dimensions			304 Stainless Steel	
	A	B	C	Part #	Price / Each
2" x 1"	.500	.870	1.000	B31WMP-G200100	\$138.70
2" x 1½"	.500	1.370	1.500	B31WMP-G200150	116.50
2½" x 1½"	.500	1.370	1.500	B31WMP-G250150	272.05
2½" x 2"	.500	1.870	2.000	B31WMP-G250200	272.35
3" x 2"	.500	1.870	2.000	B31WMP-G300200	328.25
4" x 2"	.625	1.870	2.000	B31WMP-G400200	592.95
4" x 3"	.625	2.870	3.000	B31WMP-G400300	593.50

Clamp Adapters

Clamp x Plain Bevel Seat Adapters with Hex Nut - 17MP-14

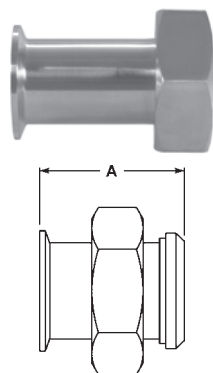

Tube O.D.	Dimension A	304 Stainless Steel	
		Part #	Price / Each
1"	3.000	17MP-14-G100	\$433.85
1½"	3.000	17MP-14-G150	402.55
2"	3.000	17MP-14-G200	515.95
2½"	3.500	17MP-14-G250	668.40
3"	3.750	17MP-14-G300	910.70
4"	4.000	17MP-14-G400	1129.60

Hex nut is CF8 (304 stainless)

Clamp x Threaded Bevel Seat Adapters - 17MP-15

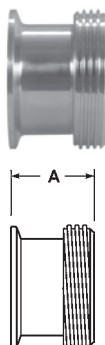

Size	Dimension A	304 Stainless Steel	
		Part #	Price / Each
1"	1.843	17MP-15-G100	\$272.40
1½"	1.843	17MP-15-G150	234.35
2"	1.875	17MP-15-G200	265.95
2½"	2.000	17MP-15-G250	402.10
3"	2.031	17MP-15-G300	481.25
4"	2.151	17MP-15-G400	1269.05