

## Bronze Sight Flow Indicators

- Verifies flow and monitors color and clarity in fluid lines
- Double window snap ring design
- Bronze body
- ABS indicator
- Tempered soda lime sight glass
- Buna-N seals
- Maximum pressure **125 PSI**
- Maximum temperature **200°F**
- Made in the USA

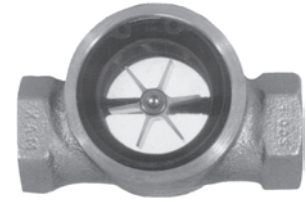

Female NPT x Female NPT

Size	Part #	Price / Each	Qty	Overall Length	Width	Height
1/2"	<b>SF1631-050</b>	<b>\$330.95</b>	1	3-13/16"	2-7/16"	2-7/16"
3/4"	<b>SF1631-075</b>	<b>354.55</b>	1	3-13/16"	2-7/16"	2-7/16"
1"	<b>SF1631-100</b>	<b>449.10</b>	1	4-3/8"	3"	3-1/8"
1 1/2"	<b>SF1631-150</b>	<b>685.50</b>	1	4-5/8"	3-13/16"	4"
2"	<b>SF1631-200</b>	<b>709.10</b>	1	4-5/8"	3-13/16"	4"

## Stainless Steel Sight Flow Indicators

- Features a radial sealing method and bolt-on body design that provides years of reliable service with no torquing maintenance required.
- Verify flow and monitor color and clarity in fluid lines
- A white Delrin® propeller style indicator is standard. Best for observations at a distance or with opaque liquids <sup>1</sup>.
- Tempered soda lime sight glass <sup>2</sup>
- Viton® seals are standard <sup>3</sup>
- Maximum pressure **200 PSI at 150°F**
- Maximum temperature **225°F at 150 PSI**
- Made in the USA

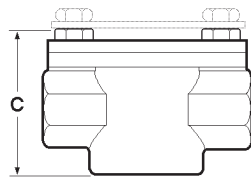
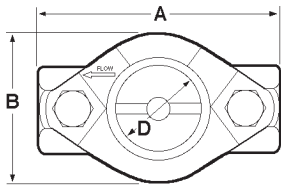
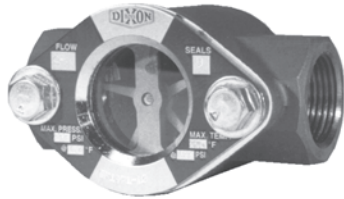

Sizes 1/2" - 1"

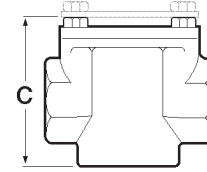
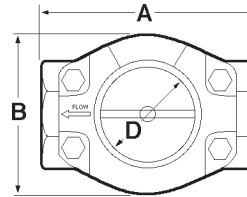

Sizes 1 1/2" - 2"

Female NPT x Female NPT <sup>4</sup>

Size	Part #	Price / E	Qty	Weight	A (Overall Length)	B (Width)	C (Height)	D (Diameter of Sight Opening)
1/2"	<b>SF1471-050</b>	<b>\$695.00</b>	1	1.4	3-1/4"	2"	2-3/8"	1-1/8"
3/4"	<b>SF1471-075</b>	<b>751.65</b>	1	3.0	4-1/4"	2-9/16"	3-1/4"	1-1/2"
1"	<b>SF1471-100</b>	<b>945.50</b>	1	2.7	4-1/4"	2-9/16"	3-1/4"	1-1/2"
1 1/2"	<b>SF1471-150</b>	<b>1252.75</b>	1	7.9	5-5/8"	3-5/16"	4-5/16"	2"
2"	<b>SF1471-200</b>	<b>1475.95</b>	1	6.6	5-5/8"	3-5/16"	4-5/16"	2"

- <sup>1</sup> Plain, flapper or drip tube style indicators are available, as are Teflon® indicators. Consult the Factory for price and availability.
- <sup>2</sup> Special units with tempered Borosilicate glass are available. Consult the Factory for price and availability.
- <sup>3</sup> Teflon®, EPR and Buna-N seals are available. Consult the Factory for price and availability.
- <sup>4</sup> 150# flanged units, as well as other metals, are also available. Consult the Factory for price and availability.

N  
Pipe &  
Welding