

Grooved End Fittings - Series 45  

- Designed to provide minimum pressure drop and uniform strength
- Maximum working pressure is **1000 PSI**
- Ductile iron body with rust inhibiting paint
- *Interchangeable with Victaulic and Grinnell*
- **Underwriters listed and Factory Mutual approved**

Interchangeable with:
 Victaulic's #110
 Grinnell's #7051

Nominal Size	C to E	Approx. Weight Lbs.	Part #	Price / Each
2"	2"	1.4	L2045	\$17.75
2½"	2¼"	2.3	L2545	17.70
3"	2½"	3.2	L3045	28.00
4"	3"	5.3	L4045	40.95
5"	3¼"	7.9	L5145	101.00
6"	3½"	11.0	L6045	84.00
8"	4¼"	20.0	L8045	165.00

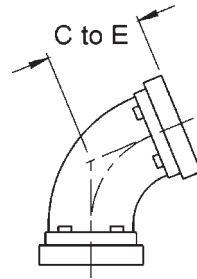

Grooved End Fittings - Series 90  

- Designed to provide minimum pressure drop and uniform strength
- Maximum working pressure is **1000 PSI**
- Ductile iron body with rust inhibiting paint
- *Interchangeable with Victaulic and Grinnell*
- **Underwriters listed and Factory Mutual approved**

Interchangeable with:
 Victaulic's #10
 Grinnell's #7050

Nominal Size	C to E	Approx. Weight Lbs.	Part #	Price / Each
2"	3¼"	2.1	L502	\$18.00
2½"	3¾"	3.0	L5025	20.70
3"	4¼"	4.7	L503	33.00
4"	5"	7.3	L504	43.35
6"	6½"	17.6	L506	103.00
8"	7¾"	31.9	L508	230.00

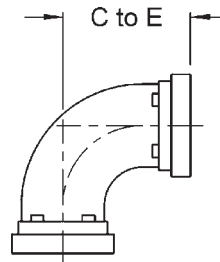

Grooved End Fittings - Series T  

- Designed to provide minimum pressure drop and uniform strength
- Maximum working pressure is **1000 PSI**
- Ductile iron body with rust inhibiting paint
- *Interchangeable with Victaulic and Grinnell*
- **Underwriters listed and Factory Mutual approved**

Interchangeable with:
 Victaulic's #20
 Grinnell's #7060

Nominal Size	C to E	Approx. Weight Lbs.	Part #	Price / Each
2"	3¼"	3.2	T602	\$26.00
2½"	3¾"	4.5	T6025	32.00
3"	4¼"	5.9	T603	44.00
4"	5"	11.0	T604	51.00
6"	6½"	24.6	T606	175.00
8"	7¾"	40.0	T608	337.00

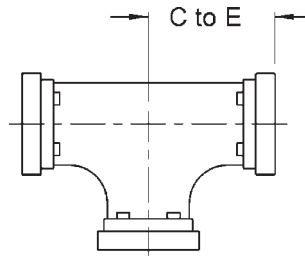

N
 Pipe &
 Welding