

CVV-Series European Screw-Together Interchange (Nipple)

Part Number	Body Size	Thread Size	Body Material	Weight (lb)	List Price	Bag Qty	Pack Qty
CVV2F2	1/4"	1/4"-18 NPTF	steel	0.25	\$24.42	10	50
CVV2BF2	1/4"	G 1/4" BSPP	steel	0.25	24.42	10	50
CVV2FM1415	1/4"	M14 x 15	steel	0.23	24.42	10	50
CVV3F3	3/8"	3/8" - 18 NPTF	steel	0.49	24.42	10	20
CVVBF3	3/8"	G 3/8" BSPP	steel	0.49	24.42	10	30
CVV3FM1615	3/8"	M16 x 15	steel	0.46	24.42	10	30
CVV4F4	1/2"	1/2" - 14 NPTF	steel	0.75	31.81	5	25
CVV4OF4	1/2"	3/4" - 16 ORB	steel	0.75	31.81	5	25
CVV4BF4	1/2"	G 1/2" BSPP	steel	0.76	31.81	5	25
CVV4FM1815	1/2"	M18 x 1.5	steel	0.78	31.81	5	25
CVV4OF5	1/2"	7/8" - 14 ORB	steel	0.78	31.81	5	25
CVV4FM2215	1/2"	M22 x 1.5	steel	0.75	31.81	5	25
CVV6F6	3/4"	3/4" - 14 NPTF	steel	1.28	53.43	---	10
CVV6BF6	3/4"	G 3/4" BSPP	steel	1.28	53.43	---	10
CVV6FM2215	3/4"	M22 x 1.5	steel	1.28	53.43	---	10
CVV8F8	1"	1" - 11 1/2" NPTF	steel	1.78	77.00	---	10
CVV8BF8	1"	G 1" BSPP	steel	1.78	77.00	---	10
CVV10F10	1-1/4"	1-1/4" - 11 1/2" NPTF	steel	2.64	191.33	---	10
CVV10BF10	1-1/4"	G 1-1/4"	steel	2.64	191.33	---	10
CVV10F12	1-1/4"	1-1/2" - 11 1/2" NPTF	steel	3.50	191.33	---	10
CVV10BF12	1-1/4"	G 1/2"	steel	3.50	191.33	---	10

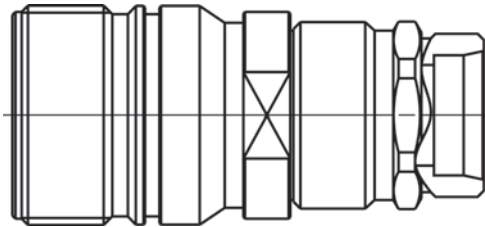

(Female Thread)



Nipple with Male Stud

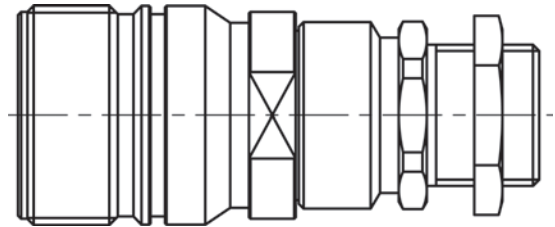

Nipple with Male Bulkhead

Available upon request, contact the factory for details

CVV-Series