

1032 Sanitary Pressure Gauges

2" Dial



- **Accuracy:** 3% upscale, up to 5% downscale (3)
- **Case and ring material:** 300 series stainless steel
- **Ring type:** stainless steel, push-in
- **Bourdon tube and socket material:** 316 stainless steel
- **Diaphragm material and surface finish:** 316L stainless steel and 12 to 20 RA
- **Process connection:** 3/4" single pin clamp
- **Connection location:** lower
- **System fill:** dry
- **Window material:** glass
- **Pointer:** black painted aluminum non-adjustable
- **Dial:** white with black markings
- **Movement:** 300 series stainless steel
- **Agency approvals:** 3A compliance (1)
- **Clean or steam in place (CIP or SIP):** temperature limit of 300°F (149°C)
- **Temperature error:** ± 0.16% / 10°F change at 70°F
- **Autoclave or sterilize:** temperature limit of 300°F (149°C) (2)

Lower Mount

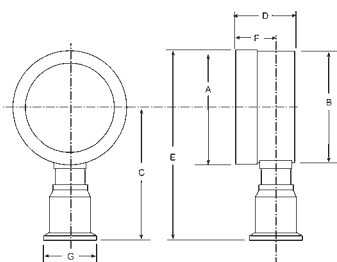

Size	Dimensions							Part Number
	A	B	C	D	E	F	G	
2"	2-3/32"	2-1/32"	2-7/16"	1-1/16"	3-27/32"	11/16"	1"	201032SD75L#

Pressure range of 15, 30, 60, 100, 160, 200, 300, 400 or 600

Options

Liquid filled case (2)

USP food grade glycerin

not applicable

Neobee-m20 (system fill)

not applicable

Shatterproof glass window

available

Polycarbonate window

available

Polysulphone window

not applicable

1½" I line connection

not applicable

1½" or 2" I line connection

not applicable

Connection at 3:00

available

Connection at 9:00

available

Serial number or service marking on dial

available

Tagging of instrument with stainless steel tag (wired)

available

External zero adjustment, tamper proof design

not applicable

Zero and span adjustments

not applicable

(1) Compliance to sanitary standard 74-00.

(2) It is recommended that the gauge case be drained of fill liquid prior to autoclave or sterilization.

(3) Gasket material and clamp torque tightness may effect gauge accuracy.

The Ashcroft type 1032 fractional sanitary pressure gauge is calibrated at the factory using a buna gasket.

A single pin clamp is tightened to 25 inch pounds during calibration as recommended by the clamp manufacturer.

Specify gasket material if other than buna when ordering the Ashcroft 1032 fraction pressure gauge.

See page 5 for detailed ordering instructions.