

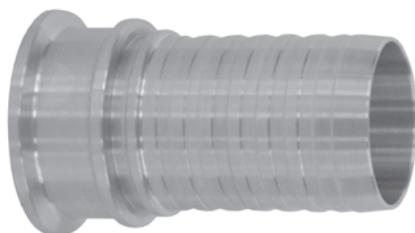



Couplings



316 Stainless Sanitary Stems



- 316L stainless
- Designed for use on silicone hose
- Stocked with clamp ends
– call for other end configurations
- Meets FDA, USDA, and  sanitary standards

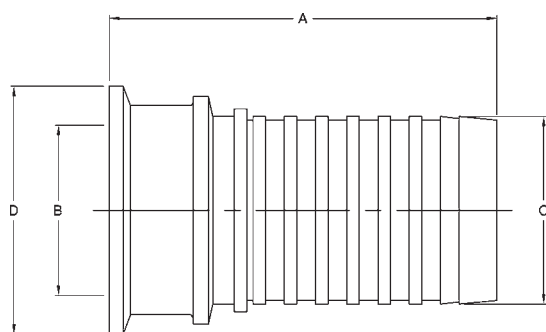

Hose Size	Dimensions				Part Number
	A	B	C	D	
½"	1.898	.370	.508	.992	BSC-R050
¾"	2.169	.635	.765	.992	BSC-R075
1"	2.450	.850	1.015	1.984	BSC-R100
1½"	3.100	1.370	1.515	1.984	BSC-R150
2"	3.670	1.750	2.015	2.516	BSC-R200

304 Stainless Crimp Ferrules



- 304 stainless steel crimp collar
- Designed to be used with the 316L sanitary stem
- Designed for use on silicone hose
- Meets FDA, USDA, and  sanitary standards

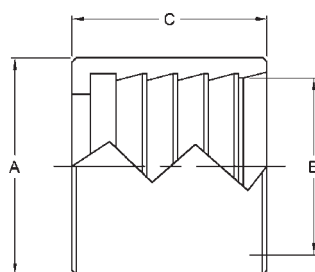

Hose I.D.	Part Number	Dimensions		
		A	B	C
½"	BHC-G050	1.232	.980	1.149
¾"	BHC-G075	1.486	1.225	1.347
1"	BHC-G100	1.736	1.484	1.485
1½"	BHC-G150	2.227	1.975	2.155
2"	BHC-G200	2.732	2.468	2.654

Contact the factory for hose OD ranges.