

**PUSH ON HOSE BARB****STAINLESS STEEL HOSE BARBS****304 STAINLESS STEEL  
HOSE NIPPLES**

Part #	Hose I.D. x Male Pipe	List Price
73-951	1/4"	5.37
73-952	3/8"	8.37
73-953	1/2"	8.11
73-954	3/4"	10.54
73-955	1"	13.46
73-956	1-1/4"	23.34
73-957	1-1/2"	24.36
73-958	2"	37.30
73-959	2-1/2"	70.44
73-960	3"	87.28

**304 STAINLESS STEEL  
REDUCING HOSE NIPPLES**

Part #	Hose I.D. x Male Pipe	List Price
73-970	1/4 X 1/8	5.47
73-971	3/8 X 1/4	6.32
73-972	1/2 X 3/8	9.44
73-973	1/2 X 1/4	9.76
73-974	3/4 X 1/2	12.46
73-975	1 X 3/4	14.07
73-976	1 X 1/2	16.26
73-977	1-1/4 X 1	22.67
73-978	1-1/4 X 3/4	23.94
73-979	1-1/2 X 1-1/4	35.63
73-980	1-1/2 X 1	25.67
73-981	2 X 1-1/2	44.27
73-982	2 X 1-1/4	35.40

**316 STAINLESS STEEL  
HOSE NIPPLES**

Part #	Hose I.D. x Male Pipe	List Price
973-951	1/4"	6.01
973-952	3/8"	7.71
973-953	1/2"	13.76
973-954	3/4"	12.57
973-955	1"	17.32
973-956	1-1/4"	23.54
973-957	1-1/2"	40.92
973-958	2"	43.59
973-959	2-1/2"	121.53
973-990	3"	149.72
973-991	4"	365.56

Dimension data can change without notice.  
Please call us when dimensions are critical.

**BRASS FITTINGS****PUSH ON BARB FITTINGS**

Starts on next page. ►

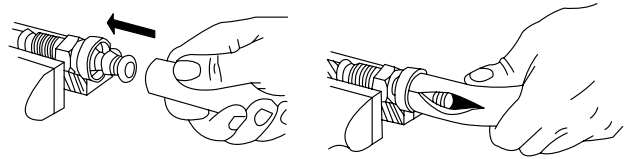

**Typical Application:** Low Pressure Air, Fuel, Lube, and Oil Lines

**Material:** CA360 Brass

**Advantages:** Easy assembly. No clamps needed!!

**ASSEMBLY INSTRUCTIONS:**

- 1- Lubricate insert.
- 2- Hold hose at angle as shown & push on and up over first barb.
- 3- Continue to push straight on until hose is seated under protective plastic cap. Keep hands back from hose end area so that hose can expand.

**DISASSEMBLING INSTRUCTIONS:**

- 1- Split hose as shown above. Do not cut completely through hose. Sealing edge of barb could be damaged.
- 2- Bend hose and remove with a quick pull

**ACTUAL PUSH ON BARB PROFILES**