

## MISC. VALVES

### STAINLESS TRIM BALL VALVES

Full Port 600 WOG Forged Brass Ball Valves

- Nickel plated body
- Stainless steel tee handle and nut



CSA AGA 3.88 5 PSIG



Also with lever handle option

### FEMALE X FEMALE

Part #	Size	List Price
948-154ST	3/4	16.18
948-154STL	3/4 Lever Handle	16.54
948-155ST	1	32.20
948-155STL	1 Lever Handle	30.87

Full Port 600 WOG Forged Brass Valves

- Nickel plated body
- Stainless steel lever handle and nut



CSA AGA 3.88 5 PSIG



### MALE X FEMALE

Part #	Size	List Price
948-104S	3/4	14.57

More options available ... just ask!

### FULL PORT

### AUTOMATIC DRAIN & LATCH LOCK HANDLE

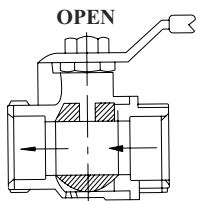

Valve - open position.  
Drain vent shut off.

200 PSI



CLOSED

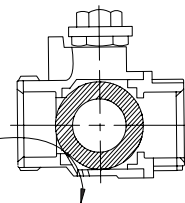

Valve - closed and draining occurs. Upstream seat prevents air flow.  
Downstream system is vented to atmosphere.

Part#	Size	Box	Case	List
948-131	1/4"	12	192	34.42
948-132	3/8"	12	192	34.42
948-133	1/2"	10	120	36.83
948-134	3/4"	10	90	50.19
948-135	1"	6	60	71.10

## BRASS VALVES

### ANGLE SILLCOCKS 3/4" Hose Thread Outlet

- Notched flange for convenient installation
- Heavy brass construction
- Cast Iron handle



### FEMALE IPS

Part #	Size	Box	List Price
942-142	1/2	12	8.30

### HOSE BIBBS 3/4" Hose Thread Outlet



### IPS

Part #	Size	Box	List Price
942-170	1/2 (1/2"C)	12	6.26
942-171	3/4	12	8.05

### BALL OPERATED HOSE BIBBS

- Quarter turn operation
- Manual spherical shut-off valve
- 150 PSI water, oil or air
- 20° to 150 °F in continuous usage
- Up to 200°F in discontinuous usage
- Steel handle black epoxy painted
- Available with butterfly handle
- ISO 9002
- Chrome plated brass ball

Made in Italy



### IPS

Part #	Size	Box	List Price
942-175	1/2 x 3/4	12	14.87
942-176	3/4 x 3/4	12	17.59

I'm not young enough to know everything.

- Oscar Wilde

