

**P-38
REPLACEMENT
PARTS**

Made in U.S.A.



D-285-A



D-289-A



D-298-A

Punch-Lok Tool Replacement Parts

| Item # | Part # | Description | List Price |
|--|----------|--|------------|
| P-1, P-3, P-1000 and P-3000 Replacement Parts | | | |
| P252010 | D-201 | Punch Head | \$50.82 |
| P252020 | D-202 | Punch | \$5.78 |
| P252030 | D-203 | Set Screw | \$1.77 |
| P252040 | D-204 | Punch Head Pin (1 7/8" long) | \$4.25 |
| P252060 | D-206 | Pusher Nose | \$28.34 |
| P252070 | D-207 | Holding Dog | \$29.52 |
| P252080 | D-208 | Pusher Nose (15/16" Long) | \$5.30 |
| P252090 | D-209 | Holding Dog Spring (Long) | \$2.15 |
| P252110 | D-211 | Puller Link (need 2) | \$16.80 |
| P252111 | D-2119 | *Puller Link (need 2) | \$16.80 |
| P252120 | D-212 | Puller Link Pin (5/8" long) | \$6.47 |
| P252140 | D-214 | Pulling Dog | \$35.20 |
| P252142 | D-2149 | *Pulling Dog | \$35.20 |
| P252150 | D-215 | Pulling Dog Pin (1 11/32") | \$4.97 |
| P252160 | D-216 | Release Lever | \$9.72 |
| P252161 | D-2169 | *Release Lever P-1000 | \$9.72 |
| P252170 | D-217 | Pulling Dog Spring (Short) | \$2.15 |
| P252180 | D-218 | Release Lever Pin | \$2.15 |
| P252200 | D-220-A | Ball Handle Assembly | \$62.78 |
| P252240 | D-224 | Wrench | \$2.29 |
| P252250 | D-225A | Mallet | \$41.39 |
| P252260 | D-226 | Limit Ring | \$3.18 |
| P252280 | D-228 | Formed Washer | \$2.15 |
| P252290 | D-229 | 3/8" Clamp Adapter | \$20.70 |
| P252310 | D-231-A | Pusher-Puller Assembly (for P-1 Tool Only) | \$97.91 |
| P252311 | D-231-AS | Pusher-Puller Assembly (for P-3 Tool Only) | \$114.30 |
| P252312 | D-231-A | Pusher - Puller Assembly (P-1000) | \$93.25 |
| P252420 | D-242 | Retaining Rings (need 4) | \$1.77 |

P-38 Replacement Parts

| | | | |
|---------|---------|---------------------------|---------|
| P252850 | D-285-A | Frame | \$14.19 |
| P252890 | D-289-A | Punch and Holder | \$8.49 |
| P252980 | D-298-A | Ratchet Wrench and Winder | \$35.39 |

PB-001 Replacement Parts

| | | | |
|---------|--------|----------------------------------|---------|
| P250067 | PB-006 | Tension Handle (Parts 7, 8, & 9) | \$38.12 |
| P252210 | PB-010 | Spindle Rod | \$17.28 |
| P252015 | PB-015 | Cutter Blade | \$32.34 |
| P252016 | PB-016 | Ball Bearing | \$11.55 |
| P252017 | PB-017 | Cutter Blade Lever | \$13.86 |
| P252220 | PB-020 | Gripper | \$24.33 |
| P252021 | PB-021 | Gripper Pivot Pin | \$4.62 |
| P252022 | PB-022 | Cutter Blade Set Screw | \$3.47 |

* Note: for P-1000 only

**PB-001
REPLACEMENT
PARTS**

Made in U.S.A.

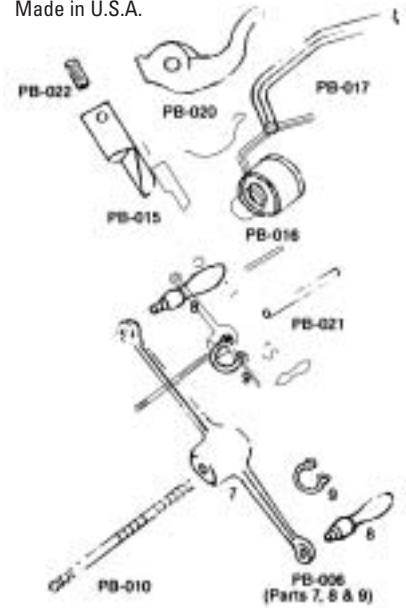

**P-1, P-3, P-1000, &
P-3000 REPLACEMENT
PARTS--*FOR
P-1000 ONLY**

Made in U.S.A.

