

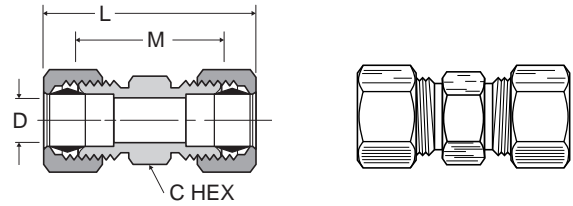

**Union 62C**

Ref. SAE 060101 BA

| PART NO. | TUBE SIZE | STRAIGHT THREAD | C HEX | L    | M    | FLOW DIA. D |
|----------|-----------|-----------------|-------|------|------|-------------|
| 62C-2    | 1/8       | 5/16-24         | 5/16  | 1.05 | .64  | .094        |
| 62C-3    | 3/16      | 3/8-24          | 3/8   | 1.21 | .72  | .125        |
| 62C-4    | 1/4       | 7/16-24         | 7/16  | 1.33 | .79  | .188        |
| 62C-5    | 5/16      | 1/2-24          | 1/2   | 1.39 | .85  | .250        |
| 62C-6    | 3/8       | 9/16-24         | 9/16  | 1.52 | .97  | .312        |
| 62C-7    | 7/16      | 5/8-24          | 5/8   | 1.70 | 1.02 | .312        |
| 62C-8    | 1/2       | 11/16-20        | 11/16 | 1.90 | 1.08 | .406        |
| 62C-10   | 5/8       | 13/16-18        | 13/16 | 2.06 | 1.23 | .500        |
| 62C-12   | 3/4       | 1-18            | 1     | 2.37 | 1.41 | .562        |
| 62C-14   | 7/8       | 1-1/8-18        | 1-1/8 | 2.07 | 1.19 | .766        |



**Union Reducers 62C**

Ref. SAE 060101 BA

| PART NO. | 1 TUBE SIZE | 2 TUBE SIZE | 1 STRAIGHT THREAD | 2 STRAIGHT THREAD | C HEX | L    | M    | FLOW DIA. D |
|----------|-------------|-------------|-------------------|-------------------|-------|------|------|-------------|
| 62C-4-3  | 3/16        | 1/4         | 3/8-24            | 7/16-24           | 7/16  | 1.29 | .78  | .125        |
| 62C-6-4  | 1/4         | 3/8         | 7/16-24           | 9/16-24           | 9/16  | 1.46 | .91  | .188        |
| 62C-8-6  | 3/8         | 1/2         | 9/16-24           | 11/16-20          | 11/16 | 1.71 | 1.03 | .312        |
| 62C-10-6 | 3/8         | 5/8         | 9/16-24           | 13/16-18          | 13/16 | 1.82 | 1.13 | .312        |

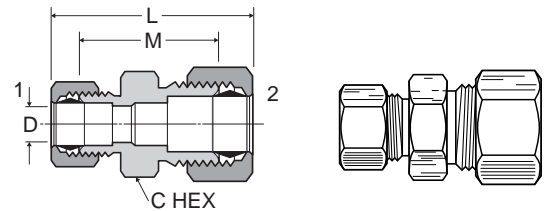

**Bulkhead Union 62CBH**

| PART NO. | TUBE SIZE | STRAIGHT THREAD | C HEX | L    | M    | BULKHEAD HOLE DIA. | FLOW DIA. D |
|----------|-----------|-----------------|-------|------|------|--------------------|-------------|
| 62CBH-4  | 1/4       | 7/16-24         | 9/16  | 2.29 | 1.75 | 7/16               | .188        |
| 62CBH-6  | 3/8       | 9/16-24         | 11/16 | 2.42 | 1.88 | 9/16               | .312        |

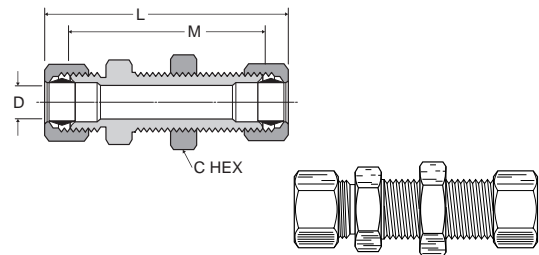

**Brass Insert 63PT**

(For industrial grade plastic tubing)

| PART NO.   | TUBE O.D. | TUBE WALL | L   | O.D. |
|------------|-----------|-----------|-----|------|
| 63PT-2-16  | 1/8       | .016      | .46 | .080 |
| 63PT-2-23  | 1/8       | .023      | .45 | .073 |
| 63PT-2-32  | 1/8       | .032      | .31 | .061 |
| 63PT-3-25  | 3/16      | .025      | .45 | .135 |
| 63PT-3-40  | 3/16      | .040      | .52 | .095 |
| 63PT-4-40  | 1/4       | .040      | .50 | .163 |
| 63PT-4-62  | 1/4       | .062      | .33 | .110 |
| 63PT-5-40  | 5/16      | .040      | .50 | .232 |
| 63PT-5-62  | 5/16      | .062      | .53 | .187 |
| 63PT-6-62  | 3/8       | .062      | .56 | .250 |
| 63PT-8-62  | 1/2       | .062      | .72 | .370 |
| 63PT-10-62 | 5/8       | .062      | .72 | .483 |

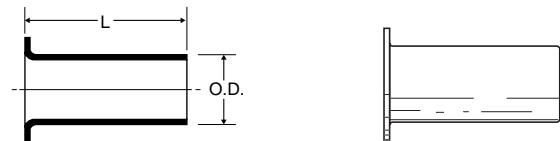

For plastic tubing

Derlin Sleeve 60PT and Brass Insert 63PT converts standard compression fittings for use with industrial grades of thermoplastic tubing.