

Parker Metru-Lok™ Fittings

Advantages

Metru-Lok™ is a one-piece, ready-to-use, bite-type fitting for use with either copper or plastic tubing. The ferrule is held captive in the nut. The fitting is designed to permit tube entry and fitting makeup without removal of the nut and ferrule, avoiding the assembly of the fitting components prior to use.

Fitting ready to use

- Compact fully assembled fitting, timesaving at makeup.
- Captive snap in ferrule.
- Simplified handling and stock-keeping.
- No presetting of the ferrule necessary.

Positive sealing and bite

- The wedging action of the nut when tightened causes the ferrule to bite into the outside diameter of the tube wall for a leakproof connection.
- With flexible tubing (polyurethane, PEBA or polyethylene), it is recommended to use a tube insert for a positive holding of the tube.

Safety

- Visible ferrule (extending to rear of nut) allows quality control checks for correct assembly.

Excellent vibration resistance

- Vibration is contained by the rear compression of the ferrule extending outside the nut.
- The tube is held at the bottom of the fitting.
- The tube is thus held between the above two points so that vibration running along the tube does not affect the sealing and bite area.

How to Use: Assembly

- Cut the tube square.
- De-burr (copper tube).
- Insert the tube through the nut and ferrule until it bottoms.
- Finger tighten the nut.
- Wrench tighten the nut one turn, or one and one half turns, according to size.

Disassembly - remake

- The Metru-Lok fitting can be assembled and disassembled at least 15 times. At each remake, hand tighten the nut, then wrench tighten 1/16 of a turn.

Technical Features

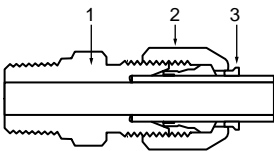

MATERIAL			WORKING TEMP.	WORKING PRESSURE* DEPENDING ON TUBE O.D.							
1	2	3		TUBE O.D. MM	4	6	8	10	12	14	16 to 20
BODY BRASS	NUT BRASS	FERRULE BRASS	FROM -65° TO +250° F	PSI	2600	2600	1800	1500	1300	1000	800

Fitting Dimensions

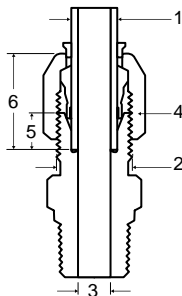

1 TUBE O.D. MM	2 METRIC STRAIGHT THREAD	3 INSIDE DIAMETER MM	4 HEX OF NUT MM	5 TUBE ENTRY BODY MM	6 TUBE ENTRY COMPL. FITTING MM	WRENCH TIGHTENING IN TURNS
4	M8x1	2	10	4	12	1 1/2
6	M10x1	4	12	5	13	1 1/2
8	M12x1	6	14	6	14	1 1/2
10	M14x1	8	17	6	14	1 1/2
12	M16x1	10	19	7	15	1 1/2
14	M18x1	12	22	8	16	1 1/2
16	M22x1.50	14	27	8	16	1
18	M24x1.50	16	30	9	21	1
20	M26x1.50	18	32	9	21	1
22	M28x1.50	20	36	10	22	1