

A

HBMB Equal Union

PART NO.	TUBE SIZE	C HEX	C1	L
HBMB4	4	8	10	31
HBMB6	6	10	12	34
HBMB8	8	12	14	37
HBMB10	10	14	17	37
HBMB12	12	17	19	39
HBMB14	14	19	22	41
HBMB16	16	22	27	41
HBMB18	18	24	30	51
HBMB20	20	27	32	51
HBMB22	22	30	36	54

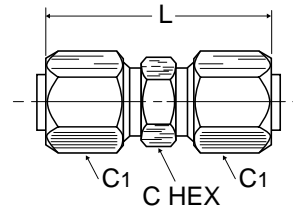

GBMB Female Connector NPT

PART NO.	TUBE SIZE	NPT THREAD	C HEX	C1	L
GBMB6-1/8	6	1/8	14	12	29
GBMB6-1/4	6	1/4	19	12	32
GBMB8-1/8	8	1/8	14	14	30
GBMB8-1/4	8	1/4	19	14	33
GBMB10-1/4	10	1/4	19	17	33
GBMB10-3/8	10	3/8	22	17	35
GBMB12-3/8	12	3/8	22	19	36
GBMB12-1/2	12	1/2	27	19	38
GBMB14-3/8	14	3/8	22	22	37
GBMB14-1/2	14	1/2	27	27	39
GBMB16-1/2	16	1/2	27	27	39

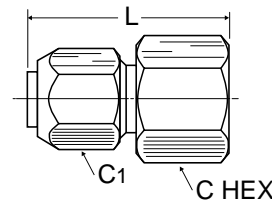

G4BMB Female Connector BSPP

PART NO.	TUBE SIZE	BSPP THREAD	C HEX	C1	L
G4BMB4-1/8	4	1/8	14	10	26
G4BMB6-1/8	6	1/8	14	12	27
G4BMB6-1/4	6	1/4	19	12	29
G4BMB8-1/8	8	1/8	14	14	28
G4BMB8-1/4	8	1/4	19	14	30
G4BMB10-1/4	10	1/4	19	17	30
G4BMB10-3/8	10	3/8	22	17	32
G4BMB12-3/8	12	3/8	22	19	33
G4BMB12-1/2	12	1/2	27	19	36
G4BMB14-3/8	14	3/8	22	22	34
G4BMB14-1/2	14	1/2	27	22	37
G4BMB16-1/2	14	1/2	27	27	37
G4BMB18-1/2	18	1/2	27	30	41

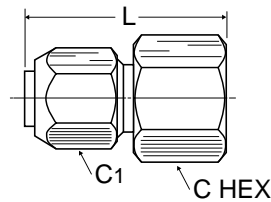

WBMB Bulkhead Union

PART NO.	TUBE SIZE	MM THREAD	C HEX	C1	L	L1	L2	BULKHEAD HOLE DIA.
WBMB4	4	M8x1	12	10	47	19	28	8mm
WBMB6	6	M10x1	14	12	49	20	29	10mm
WBMB8	8	M12x1	16	14	52	21	31	12mm
WBMB10	10	M14x1	19	17	53	22	31	14mm
WBMB12	12	M16x1	22	19	56	24	32	16mm
WBMB14	14	M18x1	24	22	60	26	34	18mm
WBMB16	16	M22x1.5	27	27	58	25	33	22mm
WBMB18	18	M24x1.5	30	30	70	31	39	24mm
WBMB20	20	M26x1.5	32	32	70	31	39	26mm
WBMB22	22	M28x1.5	36	36	74	33	41	28mm

