

**J663PK Adjustable Male Multiple Tee BSPT**

| PART NUMBER    | MOUNTING |   | HOLE DIA | BSPT | C HEX | H  | L     | L1 | N  |
|----------------|----------|---|----------|------|-------|----|-------|----|----|
|                | 1        | 2 |          |      |       |    |       |    |    |
| J663PK6-4-1/8  | 6        | 4 | 4.4      | 1/8  | 10    | 27 | 103.0 | 70 | 18 |
| J663PK6-4-1/4  | 6        | 4 | 4.4      | 1/4  | 14    | 27 | 106.5 | 70 | 18 |
| J663PK8-4-1/8  | 8        | 4 | 4.4      | 1/8  | 10    | 28 | 103.0 | 70 | 18 |
| J663PK8-4-1/4  | 8        | 4 | 4.4      | 1/4  | 14    | 28 | 106.5 | 70 | 18 |
| J663PK8-4-3/8  | 8        | 4 | 4.4      | 3/8  | 17    | 28 | 108.0 | 70 | 18 |
| J663PK8-6-1/8  | 8        | 6 | 4.4      | 1/8  | 10    | 30 | 103.0 | 70 | 18 |
| J663PK8-6-1/4  | 8        | 6 | 4.4      | 1/4  | 14    | 30 | 106.5 | 70 | 18 |
| J663PK8-6-3/8  | 8        | 6 | 4.4      | 3/8  | 17    | 30 | 108.0 | 70 | 18 |
| J663PK10-6-1/4 | 10       | 6 | 4.4      | 1/4  | 14    | 33 | 116.4 | 70 | 18 |
| J663PK10-6-3/8 | 10       | 6 | 4.4      | 3/8  | 17    | 33 | 117.9 | 70 | 18 |

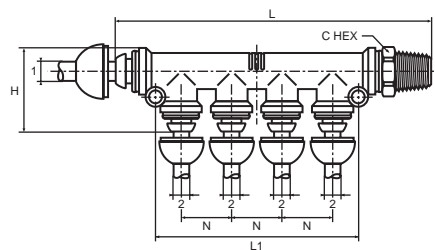

**J664PK Adjustable Male Multiple Tee BSPP**

| PART NUMBER    | MOUNTING |   | HOLE DIA | BSPP | C HEX | H  | J    | L     | L1 | N  |
|----------------|----------|---|----------|------|-------|----|------|-------|----|----|
|                | 1        | 2 |          |      |       |    |      |       |    |    |
| J664PK6-4-1/8  | 6        | 4 | 4.4      | 1/8  | 14    | 27 | 7.5  | 103.0 | 70 | 18 |
| J664PK6-4-1/4  | 6        | 4 | 4.4      | 1/4  | 19    | 27 | 11.0 | 108.0 | 70 | 18 |
| J664PK8-4-1/8  | 8        | 4 | 4.4      | 1/8  | 14    | 28 | 7.5  | 103.0 | 70 | 18 |
| J664PK8-4-1/4  | 8        | 4 | 4.4      | 1/4  | 19    | 28 | 11.0 | 108.0 | 70 | 18 |
| J664PK8-4-3/8  | 8        | 4 | 4.4      | 3/8  | 22    | 28 | 11.5 | 109.0 | 70 | 18 |
| J664PK8-6-1/8  | 8        | 6 | 4.4      | 1/8  | 14    | 30 | 7.5  | 103.0 | 70 | 18 |
| J664PK8-6-1/4  | 8        | 6 | 4.4      | 1/4  | 19    | 30 | 11.0 | 108.0 | 70 | 18 |
| J664PK8-6-3/8  | 8        | 6 | 4.4      | 3/8  | 14    | 30 | 11.5 | 109.0 | 70 | 18 |
| J664PK10-6-1/4 | 10       | 6 | 4.4      | 1/4  | 19    | 33 | 11.0 | 117.9 | 70 | 18 |
| J664PK10-6-3/8 | 10       | 6 | 4.4      | 3/8  | 22    | 33 | 11.5 | 118.9 | 70 | 18 |

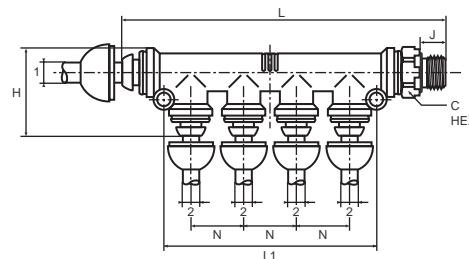

**BPK Double Male Union**

| PART NO. | TUBE SIZE | L  |
|----------|-----------|----|
| BPK4     | 4         | 38 |
| BPK6     | 6         | 41 |
| BPK8     | 8         | 41 |
| BPK10    | 10        | 51 |
| BPK12    | 12        | 54 |
| BPK14    | 14        | 55 |

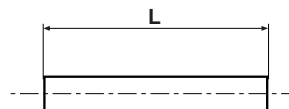

**FNPK Plug**

| PART NO. | TUBE SIZE | L    |
|----------|-----------|------|
| FNPK4    | 4         | 34.5 |
| FNPK6    | 6         | 35.0 |
| FNPK8    | 8         | 35.0 |
| FNPK10   | 10        | 42.0 |
| FNPK12   | 12        | 41.0 |
| FNPK14   | 14        | 40.0 |

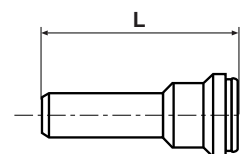

**T23FPK Tube End Male Adaptor BSPT**

| PART NUMBER  | TUBE SIZE | BSPT | C HEX | L  | N    |
|--------------|-----------|------|-------|----|------|
| T23FPK4-1/8  | 4         | 1/8  | 12    | 36 | 19.5 |
| T23FPK4-1/4  | 4         | 1/4  | 14    | 40 | 19.5 |
| T23FPK6-1/8  | 6         | 1/8  | 14    | 40 | 21.0 |
| T23FPK6-1/4  | 6         | 1/4  | 14    | 40 | 21.0 |
| T23FPK8-1/8  | 8         | 1/8  | 17    | 45 | 22.0 |
| T23FPK8-1/4  | 8         | 1/4  | 17    | 46 | 22.0 |
| T23FPK8-3/8  | 8         | 3/8  | 17    | 44 | 22.0 |
| T23FPK10-1/4 | 10        | 1/4  | 19    | 57 | 27.0 |
| T23FPK10-3/8 | 10        | 3/8  | 19    | 55 | 27.0 |
| T23FPK10-1/2 | 10        | 1/2  | 22    | 52 | 27.0 |

