

T24FPK Tube End Male Adaptor BSPP

PART NUMBER	TUBE SIZE	BSPP	C HEX	J	L	N
T24FPK4-1/8	4	1/8	14	6	38	19.0
T24FPK4-1/4	4	1/4	16	9	38	19.5
T24FPK6-1/8	6	1/8	14	6	41	21.0
T24FPK6-1/4	6	1/4	16	9	41	20.5
T24FPK8-1/8	8	1/8	14	6	45	22.0
T24FPK8-1/4	8	1/4	16	9	45	22.0
T24FPK8-3/8	8	3/8	19	9	45	22.0
T24FPK10-1/4	10	1/4	19	9	57	27.0
T24FPK10-3/8	10	3/8	19	9	51	26.0
T24FPK10-1/2	10	1/2	27	12	50	27.0

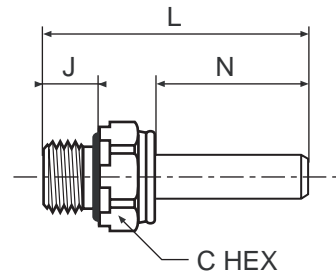

B

T28FPK Tube End Male Adaptor Metric Straight Thread

PART NUMBER	TUBE SIZE	MM THREAD	C HEX	J	L	N
T28FPK4M5	4	M5X0.8	12	5	43	19.5
T28FPK6M5	6	M5X0.8	14	5	43	21.0

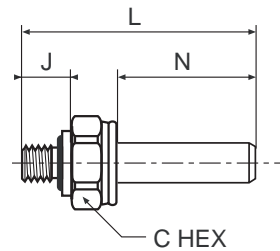

TR2PK Tube End Reducer

PART NO.	TUBE SIZE 2	TUBE SIZE 1	L
TR2PK6-4	6	4	38
TR2PK8-4	8	4	36
TR2PK8-6	8	6	39
TR2PK10-4	10	4	41
TR2PK10-6	10	6	43
TR2PK10-8	10	8	47
TR2PK12-6	12	6	36
TR2PK12-8	12	8	38
TR2PK12-10	12	10	48
TR2PK14-8	14	8	39
TR2PK14-10	14	10	42
TR2PK14-12	14	12	51

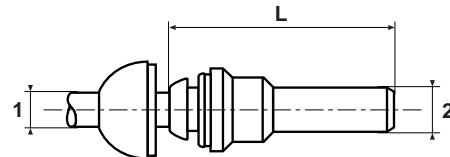

TS2PK Pressure Indicator

PART NO.	TUBE SIZE	L
TS2PK4	4	36
TS2PK6	6	37
TS2PK8	8	36

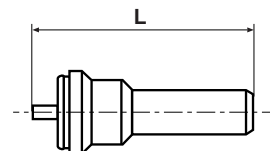

Protective Cap

PART NO.	1
C4*	4
C6*	6
C8*	8
C10*	10
C12*	12
C14*	14

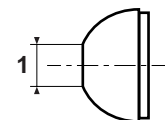

*Add the following code, corresponding to the chosen color W: white; BU: blue; G: green; R: red; Y: yellow; BL: black. Example: cap red suitable for tube Δ 4mm: C4R. In case of no color specification, we will deliver yellow cap (standard color).