

Nut 41IF

Ref. SAE 040110

PART NO.	TUBE SIZE	STRAIGHT THREAD	C HEX	L	D
41IF-2	1/8	5/16-28	5/16	.52	.133
41IF-3	3/16	3/8-24	3/8	.56	.197
41IF-4	1/4	7/16-24	7/16	.56	.259
41IF-5	5/16	1/2-20	1/2	.62	.321
41IF-6	3/8	5/8-18	5/8	.66	.384
41IF-8	1/2	3/4-18	3/4	.74	.508

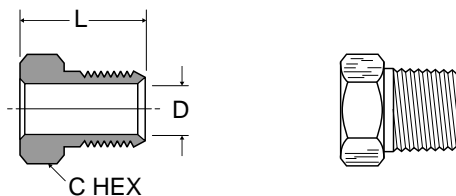

Steel Nut-Zinc Chromate 41IFS

Ref. SAE 040110

PART NO.	TUBE SIZE	STRAIGHT THREAD	C HEX	L	D
41IFS-3	3/16	3/8-24	3/8	.56	.196
41IFS-4	1/4	7/16-24	7/16	.56	.259
41IFS-5	5/16	1/2-20	1/2	.62	.321
41IFS-6	3/8	5/8-18	5/8	.66	.384
41IFS-8	1/2	3/4-18	3/4	.74	.508
41IFS-10	5/8	7/8-18	7/8	.80	.633
41IFS-12	3/4	1-1/16-16	1-1/16	.88	.759
41IFS-14	7/8	1-3/16-16	1-3/16	1.06	.890

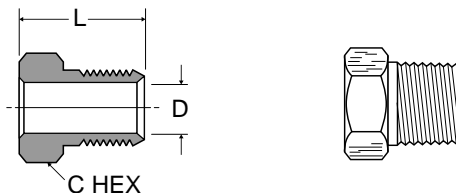

Piloted Nut 41IFF for Single Flared Tubing

Ref. SAE 040110

PART NO.	TUBE SIZE	STRAIGHT THREAD	C HEX	L	D
41IFF-2	1/8	5/16-28	5/16	.52	.133
41IFF-3	3/16	3/8-24	3/8	.56	.197
41IFF-4	1/4	7/16-24	7/16	.56	.259
41IFF-5	5/16	1/2-20	1/2	.62	.321
41IFF-6	3/8	5/8-18	5/8	.66	.384
41IFF-8	1/2	3/4-18	3/4	.74	.508

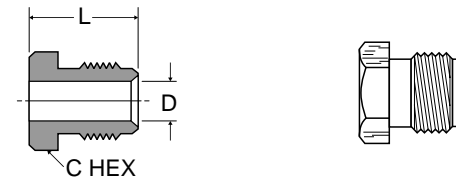

Union 42IFHD

Ref. SAE 040101

PART NO.	TUBE SIZE	STRAIGHT THREAD	C HEX	L	D
42IFHD-2	1/8	5/16-28	13/32	.60	.078
42IFHD-3	3/16	3/8-24	15/32	.65	.125
42IFHD-4	1/4	7/16-24	17/32	.63	.189
42IFHD-5	5/16	1/2-20	19/32	.71	.220
42IFHD-6	3/8	5/8-18	3/4	.81	.283
42IFHD-8	1/2	3/4-18	29/32	.92	.408

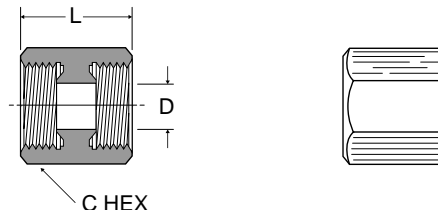

Female Connector 46IFHD

Ref. SAE 040103

PART NO.	TUBE SIZE	PIPE THREAD	STRAIGHT THREAD	C HEX	L	FLOW DIA. D
46IFHD-3-2	3/16	1/8	3/8-24	1/2	.76	.125
46IFHD-4-2	1/4	1/8	7/16-24	17/32	.76	.189
46IFHD-5-2	5/16	1/8	1/2-20	19/32	.79	.220
46IFHD-6-4	3/8	1/4	5/8-18	3/4	1.04	.283
46IFHD-8-6	1/2	3/8	3/4-18	29/32	1.10	.408

