

**Hose Barb to Swivel 45° Female Flare 146HBLFSV**

PART NO.	I.D. HOSE SIZE	STRAIGHT THREAD	C HEX	L	M	O.D.	FLOW DIA. D
146HBLFSV-4-4	1/4	7/16-20	9/16	1.55	.97	.290	.187
146HBLFSV-4-6	1/4	5/8-18	3/4	1.72	.97	.290	.187
146HBLFSV-6-6	3/8	5/8-18	3/4	1.72	.97	.415	.281

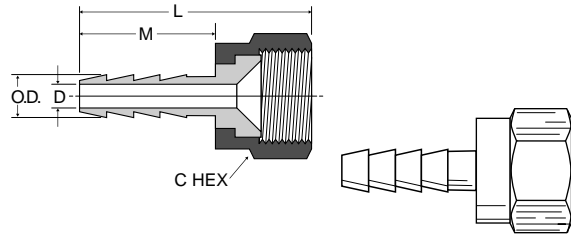

**Beaded Hose Barb Elbow to SAE Straight Thread 1695HB**

PART NUMBER	HOSE SIZE	STRAIGHT THREAD	HEX	L	M	N	D
1695HB-8-6	1/2	9/16-18	9/16	1.10	.78	1.11	.30
1695HB-12-8	3/4	3/4-16	7/8	1.47	.97	1.47	.40
1695HB-12-10	3/4	7/8-14	1	1.60	.97	1.62	.50
1695HB-16-12	1	1 1/16-12	1 3/16	1.60	.97	1.75	.60

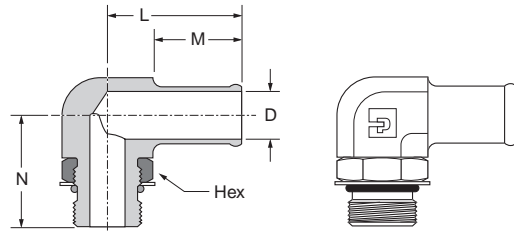

**Beaded Elbow to Metric Adaptor 169HB-X-MIX**

PART NUMBER	HOSE SIZE	METRIC THREAD	HEX	L	M	N	D
169HB-10-MI27	5/8	M27 x 2.0	7/8	1.41	.78	1.63	.50
169HB-16-MI27	1	M27 x 2.0	1	1.67	.97	1.68	.71

Note: Viton o-ring is standard

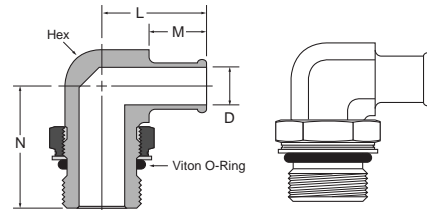

**Hose Barb Tee to Male Pipe 171HB**

PART NO.	I.D. HOSE SIZE	PIPE THREAD	L	L1	M	N	O.D.	FLOW DIA. D
171HB-4-4	1/4	1/4	1.10	.85	.76	1.10	.290	.187

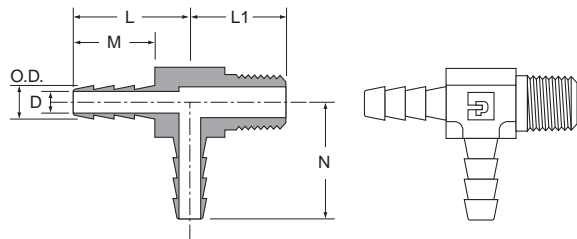

**Beaded Hose Barb 45° Elbow Tube to Male Pipe 179HB**

PART NO.	I.D. HOSE SIZE	NPTF THREAD	C HEX	L	M	N	O.D.	FLOW DIA. D
179HB-6-4	3/8	1/4-18	.75	1.09	.78	.93	.45	.28
179HB-6-6	3/8	3/8-18	.75	1.09	.78	.93	.45	.28
179HB-10-8	5/8	1/2-14	.81	1.19	.78	1.13	.70	.50
179HB-12-8	3/4	1/2-14	.81	1.19	.78	1.13	.83	.56

