

# INDUSTRIAL 91N FITTINGS

## 19291N Female BSP Swivel

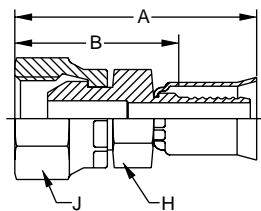

### 91N Series Permanent

*Part Number	B	C	Thread Size	Inch	Tube Size	A		Cutoff Allow. B		H Hex	J Hex
Hose Fitting	B	C	Thread Size	Inch	Inch	Inch	MM	Inch	MM	MM	MM
19291N-8-8	+	+	1/2-14	8	1/2	1.99	51	1-5/16	33	27	27
19291N-12-12	+	+	3/4-14	12	3/4	2.35	60	1-9/16	40	36	36

- \* Steel nipple, nut and shell.
- B - Brass nipple, brass nut, shell.
- C - All components 303 stainless steel.

## 1B291N Female BSP Swivel 90° Elbow

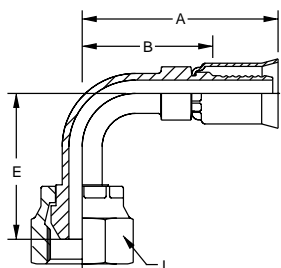

### 91N Series Permanent

*Part Number	B	C	Thread Size	Inch	Tube Size	A		Cutoff Allow. B		H Hex	J Hex
Hose Fitting	B	C	Thread Size	Inch	Inch	Inch	MM	Inch	MM	Inch	MM
1B291N-8-8	+	+	1/2-14	8	1/2	2.04	52	1-3/8	35	1.57	40
1B291N-12-12	+	+	3/4-14	12	3/4	2.93	74	2-1/8	54	2.54	65

- \* Steel nipple, tube, nut and shell.
- B - Brass nipple, brass nut, shell.
- C - All components 303 stainless steel.

1	03	55	8	6	N/A
Type	End Configuration Code	Series of Fitting	End Size	Hose Size	Material
1=Crimp 2=Field Attachable					Blank=Steel B=All Brass C=Stainless Steel S= All Carbon Steel-Used only with PTFE fittings

This example describes a permanent crimp 1/2" Male SAE JIC 37° hose end with a 3/8" hose end-this commonly referred to as a "jump size". This fitting is constructed from carbon steel since the designated material is blank.

The callout is: **10355-8-6**

(+) Non Standard. See page 2 for information on non-standard products.

Smoothbore PTFE Hose  
Convuluted PTFE Hose  
Flare Seal Hose  
Silicone Hose  
Specialty Hoses  
Fittings Permanent  
Accessories  
Technical Help  
Warranty



Parker Hannifin, Parflex Division



Call Toll Free: **1-866-711-4673**  
WebSales@GoodyearRubberProducts.com

**We Ship World Wide**