

FOOD TRANSFER HOSES

6663 X-treme Plus Food UF Series

The Ultra-Flexible X-treme Food hose is designed to handle the delivery of fatty and non-fatty foods. This FDA-approved product is designed to be used as the flexible connection between pipes or fixed equipment. The X-treme Plus Food hose is specifically for food, wine, beer, beverages and pharmaceutical industries where it is necessary to have a high-performance, tasteless and odorless hose.

TUBE COLOR: White

REINFORCEMENT: High-temperature-resistant plies with helical wires

COVER COLOR: Blue

BRANDING: PARKER SILICONE SERIES 6663 -76° to +392°F (DATE CODE) MADE IN ITALY

TEMP. RANGE: -76° to +392°F

APPLICATIONS: Food, wine, beer and beverage transfer

SPECIFICATIONS: USA FDA CFR 21 Part 177.2600, USA 3A Sanitary Standard Class II, ISO 1307-1997

MAX. WORKING PRESSURE: 1/3 of the Burst Pressure

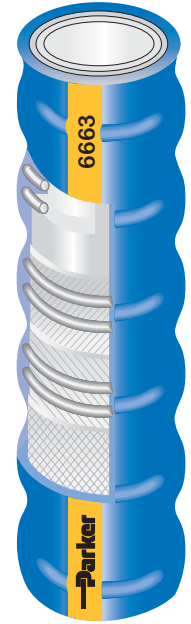

| PART NUMBER | SIZE INCH | INSIDE DIAMETER | | OUTSIDE DIAMETER | | LENGTH FT | BURST PRESSURE PSI | WEIGHT LBS/100FT | BEND RADIUS | |
|--------------|-----------|-----------------|------|------------------|-----|-----------|--------------------|------------------|-------------|-----|
| | | INCH | MM | INCH | MM | | | | INCH | MM |
| 6663-0750130 | 3/4 | 0.748 | 19 | 1.260 | 32 | 130 | 600 | 38 | 3.5 | 90 |
| 6663-1000130 | 1 | 0.984 | 25 | 1.496 | 38 | 130 | 480 | 48 | 4.0 | 100 |
| 6663-1250130 | 1-1/4 | 1.260 | 32 | 1.772 | 45 | 130 | 375 | 56 | 4.5 | 115 |
| 6663-1500130 | 1-1/2 | 1.496 | 38 | 2.087 | 53 | 130 | 330 | 64 | 5.1 | 130 |
| 6663-1563130 | 1-9/16 | 1.575 | 40 | 2.205 | 56 | 130 | 300 | 67 | 5.3 | 135 |
| 6663-2000130 | 2 | 2.008 | 51 | 2.598 | 66 | 130 | 240 | 83 | 6.3 | 160 |
| 6663-2500130 | 2-1/2 | 2.500 | 63.5 | 3.110 | 79 | 130 | 180 | 122 | 6.7 | 170 |
| 6663-2750130 | 2-3/4 | 2.756 | 70 | 3.386 | 86 | 130 | 150 | 133 | 7.9 | 200 |
| 6663-3000130 | 3 | 2.992 | 76 | 3.622 | 92 | 130 | 150 | 143 | 8.7 | 220 |
| 6663-3125130 | 3-1/8 | 3.150 | 80 | 3.819 | 97 | 130 | 150 | 150 | 9.8 | 250 |
| 6663-4000130 | 4 | 4.016 | 102 | 4.843 | 123 | 130 | 150 | 264 | 11.0 | 280 |

Parker Hannifin Corporation
Industrial Hose Division
Strongsville, OH

