

TECHNICAL AND DIMENSIONAL INFORMATION

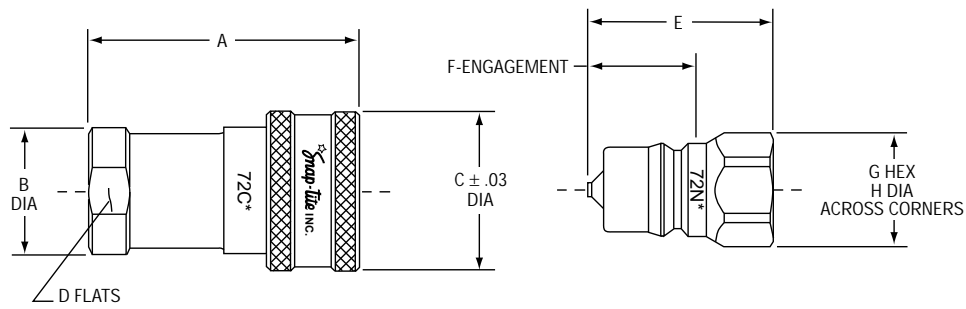

SIZE	A		A (SAE)		B		C		D		E		E (SAE)		F		G		H	
	IN	MM	IN	MM	IN	MM	IN	MM	IN	MM	IN	MM	IN	MM	IN	MM	IN	MM	IN	MM
1/8"	2.02	51.30			.82	20.65	.93	23.62	.69	17.45	1.38	35.05			.85	21.59	.56	14.22	.62	15.75
1/8" x 1/4"			2.06	52.29	.82	20.65	.93	23.62	.69	17.45			1.42	36.07	.85	21.59	.68	17.27	.76	19.30
1/4"	2.25	57.15			.88	22.35	1.12	28.45	.75	19.05	1.51	38.35			.95	24.13	.75	19.05	.83	21.08
1/4" x 3/8"			2.41	61.22	.88	22.35	1.12	28.45	.75	19.05			1.67	42.42	.95	24.13	.88	22.35	.96	24.38
3/8"	2.57	65.28			1.13	28.70	1.38	35.05	1.00	25.40	1.74	44.20			1.13	28.70	.88	22.35	.96	24.38
3/8" x 1/2"			2.77	70.36	1.13	28.70	1.38	35.05	1.00	25.40			1.94	49.28	1.13	28.70	1.00	25.40	1.10	27.94
1/2"	2.95	74.93	2.95	74.93	1.37	34.80	1.75	44.45	1.25	31.75	2.01	51.05	2.01	51.05	1.27	32.26	1.13	28.70	1.24	31.50
1/2" x 5/8"			3.02	76.71	1.37	34.80	1.75	44.45	1.25	31.75			2.08	52.83	1.27	32.26	1.19	30.23	1.31	33.27
3/4"	3.48	88.39	3.69	97.73	1.75	44.45	2.13	54.10	1.50	38.10	2.33	59.18	2.54	64.52	1.64	41.66	1.38	35.05	1.51	38.35
1"	4.14	105.16	4.14	105.16	2.00	50.80	2.50	63.50	1.75	44.45	2.81	71.37	2.81	71.37	1.87	47.50	1.63	41.40	1.79	45.47

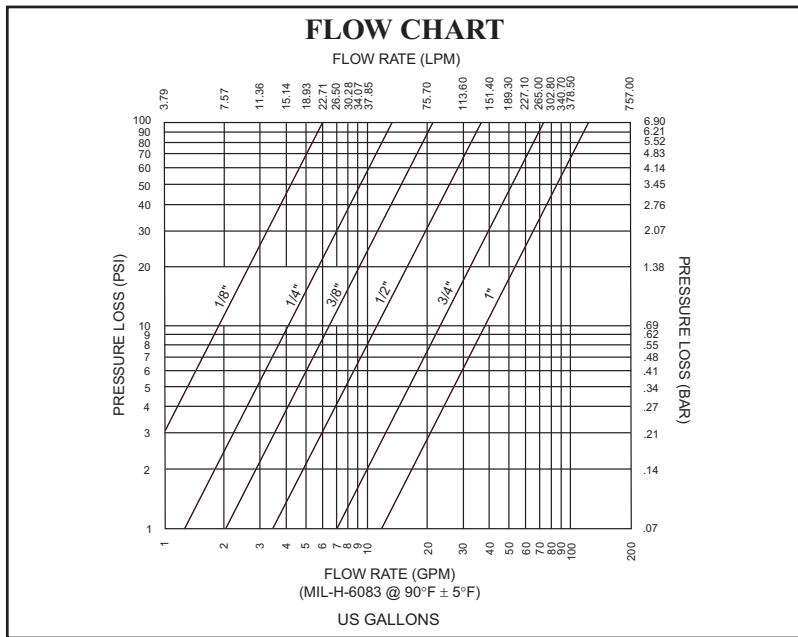

HOW TO ORDER

PART NO. S 72 C 4- 4 F

Material	Series	Coupling Half	Coupling Size	End Fitting Size	End Fitting Type	Seals	Options
No letter Steel, plated S 303 Stainless Steel SS 316 Stainless Steel B Brass	72	C Coupler N Nipple	2 = 1/8" 4 = 1/4" 6 = 3/8" 8 = 1/2" 12 = 3/4" 16 = 1"	2 = 1/8" 4 = 1/4" 6 = 3/8" 8 = 1/2" 10 = 5/8" 12 = 3/4" 16 = 1"	F* Female NPTF RP Female British Parallel BS2779 EF† Female SAE (Steel & 303 SST Only)	No letter for Buna-N (nitrile) V Viton E Ethylene Propylene Rubber	SL Sleeve Lock

ACCESSORIES

	DUST PLUG	DUST CAP
1/8"	72PDP-2	72PDC-2
1/4"	72PDP-4	72PDC-4
3/8"	72PDP-6	72PDC-6
1/2"	72PDP-8	72PDC-8
3/4"	72PDP-12	72PDC-12
1"	72PDP-16	72PDC-16

- †SAE Threads:
- 1/8" is supplied with 1/4" SAE (2-4EF) only
 - 1/4" is supplied with 3/8" SAE (4-6EF) only
 - 3/8" is supplied with 1/2" SAE (6-8EF) only
 - 1/2" can be supplied with 5/8" SAE (8-10EF) if required
 - All others are size for size (8-8EF, 12-12EF, 16-16EF)