

Safety First... We've got a handle on it!

Introducing a revolutionary new product

Safety Bump™



Problem



Solution

Protects your Transport Hose Fittings

- More than doubles the life of Transport Hoses
 - Protects your drivers' hands
 - Protects expensive hose fittings from damage
 - Eliminates damage to hose trays and tubes
 - Resistant to all hazardous liquid products
 - Available in 3 inch & 4 inch, Male & Female, Hazardous materials and food grade models
 - 2 inch models available by December 2007
-

Safety Bump Saves Money

After tires and batteries, hoses are the most replaced item on tankers



The typical tanker has five to six transport hoses, each with two expensive fittings. When the hoses are pulled from the transport tubes, often by the ring on the Kamlock ear, they bump against the tarmac or other parts of the truck, damaging the hose fittings and other equipment.

Safety Bump not only provides a handle to enable safe removal of the hoses, but its protective design ensures that the fittings do not hit the ground, eliminating the possibility of damage. Broken ears and nicked or gouged sealing surfaces require expensive repairs, or worse, not being able to unload at a customer site.

Safety Bump

- Extends the life of \$2K worth of hoses per truck
- Gives the driver complete control of his hoses
- Anti-static glass-filled or FDA-certified composite
- Tagging system to prevent the risk of cross contamination
- Patent pending design



Safety First... We've got a handle on it!

Introducing Safety Lock™

MADE IN U.S.A.



Problem

Keeps Cam & Groove Ears from Opening

- Prevents spills due to ears opening up
- Easy to install and remove
- Rugged construction for long life
- Companion product with Safety Bump™
- Can be tethered to Safety Bump™ or hose fitting to prevent loss
- Unique, Patent Pending design

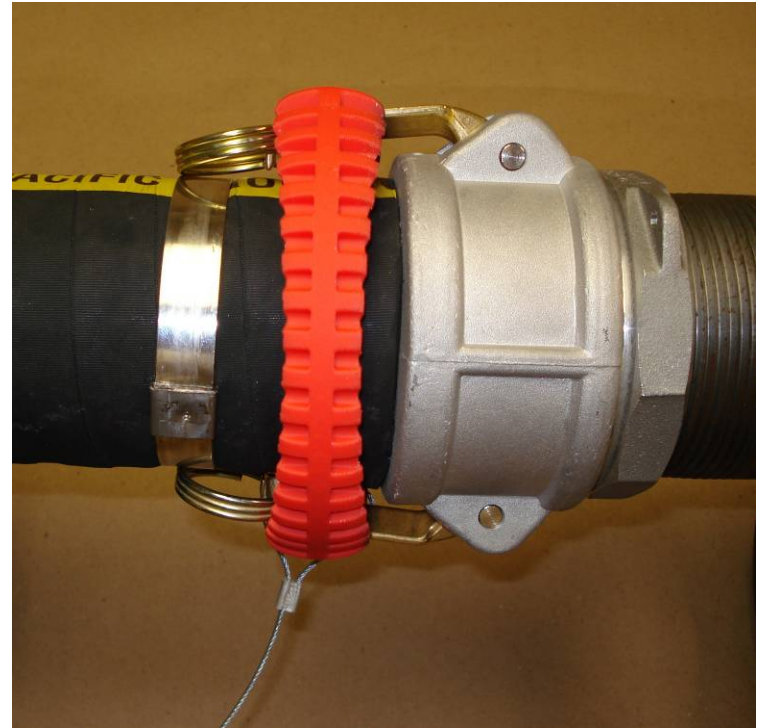

Solution

SAFETY LOCK™

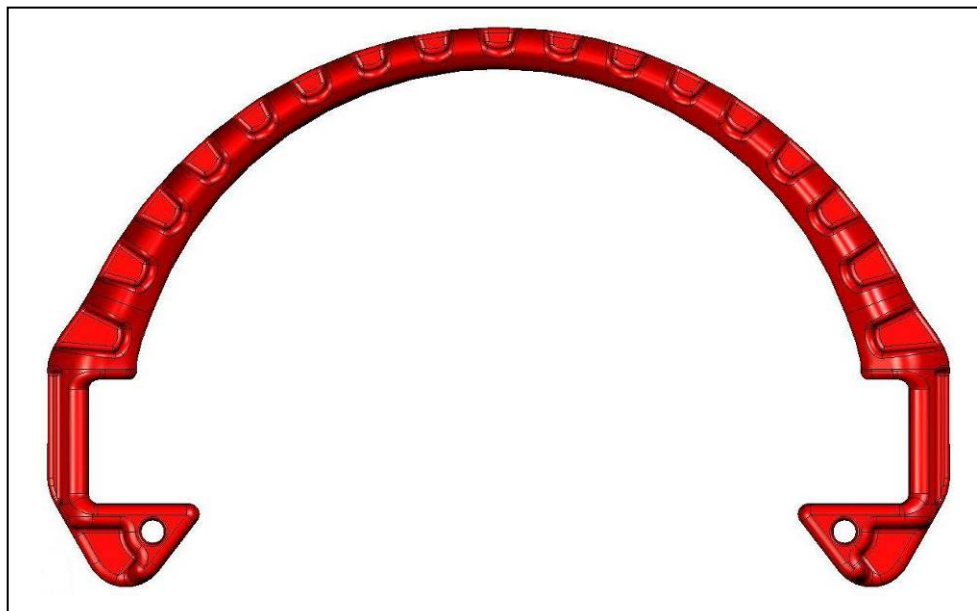

Safety Locks™, patent pending, are available for industry standard female cam and groove fittings equipped with ears and split rings. Safety Locks™ work with most brands of cam and groove fittings from leading manufacturers. Select the correct Safety Lock™ model for your application from the table below.

Safety Lock™ Model	Description	Size	Availability
SL-2	Safety Lock, Cam & Groove, 2 inch	2 inch	Now
SL-3	Safety Lock, Cam & Groove, 3 inch	3 inch	Now
SL-4	Safety Lock, Cam & Groove, 4 inch	4 inch	Now
SL-6	Safety Lock, Cam & Groove, 6 inch	6 inch	TBD

Tether options: SPS recommends that Safety Locks™ be tethered to either a Safety Bump™ or the hose fitting's split rings using a 1/16th inch braided cable and cable ferrules threaded through one of the holes in the Safety Lock™.

CAUTION: Safety Locks must be used with functioning cam lock ears AND split rings. Using Safety Locks with bent or damaged cam lock ears or missing split rings MAY RESULT IN A SPILL OR INJURY.