

Industrial Sheet Rubber, Matting & Specialty Items Catalog



General Properties of Neoprene†

- Good weather-resistance
- Moderate resistance to petroleum-based fluids
- Good physical properties.

† Properties shown based on Rubber Manufacturers Association Sheet Rubber Handbook, second edition.

NEOPRENE SHEET

SPECIFICATIONS:

Commercial grade black neoprene sheet, available in four styles:

Style N40: 40 Duro hardness (Shore Durometer A)

Style N50: 50 Duro hardness (Shore Durometer A)

Style N60: 60 Duro hardness (Shore Durometer A)

Style N70: 70 Duro hardness (Shore Durometer A)

Polymer: Chloroprene

Common Name: Neoprene

ISO/ASTM Designation: CR

All prices and specifications subject to change without notice.

NEOPRENE SHEET

Neoprene (continued)

| Style | ASTM Specification (SI units) | Temp. Range | Durometer | Tensile Strength (PSI) | Elongation (%) | Finish |
|-------|----------------------------------|-----------------|-----------|---------------------------|-------------------|--------|
| N40 | D 2000 M2BC 407 | -20°F to +180°F | 35 - 45 | 900 | 400% | Plate |
| N50 | D 2000 M2BC 507 | -20°F to +180°F | 45 - 55 | 1,000 | 400% | Plate |
| N60 | D 2000 M2BC 607 | -20°F to +180°F | 55 - 65 | 1,000 | 350% | Plate |
| N70 | D 2000 M2BC 707 | -20°F to +180°F | 65 - 75 | 1,000 | 350% | Plate |

ORDERING INFORMATION:

| Item Number | Gauge x Width (Inches) | Avg. Length (Linear Ft./Roll) | Approx. Wt./Roll |
|---------------------|---------------------------|----------------------------------|---------------------|
| N40-02 x 36 x 67 | 1/16" x 36" | 67 ft. | 96 lbs. |
| N40-04 x 36 x 67 | 1/8" x 36" | 67 ft. | 195 lbs. |
| N40-06 x 36 x 36 | 3/16" x 36" | 36 ft. | 158 lbs. |
| N40-08 x 36 x 36 | 1/4" x 36" | 36 ft. | 210 lbs. |
| N50-02 x 48 x 67 | 1/16" x 48" | 67 ft. | 132 lbs. |
| N50-04 x 48 x 36 | 1/8" x 48" | 36 ft. | 142 lbs. |
| N50-06 x 48 x 36 | 3/16" x 48" | 36 ft. | 213 lbs. |
| N50-08 x 48 x 18 | 1/4" x 48" | 18 ft. | 142 lbs. |
| N60-01 x 36 x 67 | 1/32" x 36" | 67 ft. | 52 lbs. |
| N60-02 x 36 x 67 | 1/16" x 36" | 67 ft. | 99 lbs. |
| * N60-02 x 36 x 100 | 1/16" x 36" | 100 ft. | 147 lbs. |
| N60-03 x 36 x 67 | 3/32" x 36" | 67 ft. | 149 lbs. |
| N60-04 x 36 x 67 | 1/8" x 36" | 67 ft. | 198 lbs. |
| * N60-04 x 36 x 100 | 1/8" x 36" | 100 ft. | 295 lbs. |
| N60-06 x 36 x 36 | 3/16" x 36" | 36 ft. | 161 lbs. |
| * N60-06 x 36 x 40 | 3/16" x 36" | 40 ft. | 179 lbs. |
| * N60-06 x 36 x 50 | 3/16" x 36" | 50 ft. | 223 lbs. |
| N60-08 x 36 x 36 | 1/4" x 36" | 36 ft. | 214 lbs. |
| * N60-08 x 36 x 40 | 1/4" x 36" | 40 ft. | 238 lbs. |
| * N60-08 x 36 x 50 | 1/4" x 36" | 50 ft. | 297 lbs. |
| N60-12 x 36 x 18 | 3/8" x 36" | 18 ft. | 160 lbs. |
| N60-16 x 36 x 18 | 1/2" x 36" | 18 ft. | 214 lbs. |
| N60-24 x 36 x 18 | 3/4" x 36" | 18 ft. | 319 lbs. |
| N60-32 x 36 x 18 | 1" x 36" | 18 ft. | 426 lbs. |
| N60-02 x 48 x 67 | 1/16" x 48" | 67 ft. | 132 lbs. |
| * N60-02 x 48 x 100 | 1/16" x 48" | 100 ft. | 197 lbs. |
| N60-03 x 48 x 67 | 3/32" x 48" | 67 ft. | 200 lbs. |
| N60-04 x 48 x 36 | 1/8" x 48" | 36 ft. | 142 lbs. |
| * N60-04 x 48 x 50 | 1/8" x 48" | 50 ft. | 197 lbs. |
| N60-06 x 48 x 36 | 3/16" x 48" | 36 ft. | 213 lbs. |
| * N60-06 x 48 x 40 | 3/16" x 48" | 40 ft. | 236 lbs. |
| * N60-06 x 48 x 50 | 3/16" x 48" | 50 ft. | 296 lbs. |
| N60-08 x 48 x 18 | 1/4" x 48" | 18 ft. | 142 lbs. |
| * N60-08 x 48 x 40 | 1/4" x 48" | 40 ft. | 316 lbs. |
| * N60-08 x 48 x 50 | 1/4" x 48" | 50 ft. | 394 lbs. |
| N60-12 x 48 x 18 | 3/8" x 48" | 18 ft. | 213 lbs. |
| * N60-12 x 48 x 30 | 3/8" x 48" | 30 ft. | 355 lbs. |
| N60-16 x 48 x 18 | 1/2" x 48" | 18 ft. | 284 lbs. |
| * N60-16 x 48 x 25 | 1/2" x 48" | 25 ft. | 394 lbs. |
| N60-24 x 48 x 18 | 3/4" x 48" | 18 ft. | 425 lbs. |
| N60-32 x 48 x 18 | 1" x 48" | 18 ft. | 567 lbs. |
| N70-02 x 48 x 67 | 1/16" x 48" | 67 ft. | 132 lbs. |
| N70-04 x 48 x 36 | 1/8" x 48" | 36 ft. | 142 lbs. |
| N70-06 x 48 x 36 | 3/16" x 48" | 36 ft. | 213 lbs. |
| N70-08 x 48 x 18 | 1/4" x 48" | 18 ft. | 142 lbs. |

*New Stocked Lengths

NEOPRENE CLOTH-INSERTED SHEET

General Properties of Neoprene[†]

- Excellent physical properties.

[†] Properties shown based on Rubber Manufacturers Association Sheet Rubber Handbook, second edition.

SPECIFICATIONS:

Commercial grade black neoprene sheet, with nylon reinforcement:

Style NCI: 60 Duro hardness (Shore Durometer A)

Polymer: Chloroprene reinforced with 3.4 oz./sq. yd. nylon fabric

Common Name: Nylon-reinforced Neoprene Sheet

ISO/ASTM Designation: CR

| Style | ASTM Specification (SI units) | Temp. Range | Ply | Durometer | Tensile Strength (PSI) | Finish |
|-------|-------------------------------|-----------------|-----|-----------|------------------------|--------|
| NCI | D 2000 M2BC 607 | -20°F to +180°F | 1 | 55 – 65 | 1100 | Plate |
| NCI | D 2000 M2BC 607 | -20°F to +180°F | 2 | 55 – 65 | 1100 | Plate |

ORDERING INFORMATION:

| Item Number | Gauge x Width (Inches) | Fabric Plies | Avg. Length (Linear Ft./Roll) | Approx. Wt./Roll |
|--------------------|------------------------|--------------|-------------------------------|------------------|
| NCI-1P02 x 36 x 67 | 1/16" x 36" | 1 Ply | 67 ft. | 93 lbs. |
| NCI-2P04 x 36 x 36 | 1/8" x 36" | 2 Ply | 36 ft. | 98 lbs. |
| NCI-2P06 x 36 x 36 | 3/16" x 36" | 2 Ply | 36 ft. | 146 lbs. |
| NCI-2P08 x 36 x 36 | 1/4" x 36" | 2 Ply | 36 ft. | 196 lbs. |

NOTE: This product is also available in 48" width . . . contact Kuriyama of America.

NITRILE SHEET

General Properties of Nitrile[†]

- Excellent resistance to petroleum-based fluids
- Good physical properties.

[†] Properties shown based on Rubber Manufacturers Association Sheet Rubber Handbook, second edition.

SPECIFICATIONS:

Commercial grade black nitrile sheet:

Style B60: 60 Duro hardness (Shore Durometer A)

Polymer: Nitrile-Butadiene

Common Name: Nitrile, Buna-N

ISO/ASTM Designation: NBR

| Style | ASTM Specification (SI units) | Temp. Range | Durometer | Tensile Strength (PSI) | Elongation (%) | Finish |
|-------|-------------------------------|-----------------|-----------|------------------------|----------------|--------|
| B60 | D 2000 M5BG 607 | -30°F to +200°F | 55 – 65 | 1000 | 350% | Plate |

ORDERING INFORMATION:

| Item Number | Gauge x Width (Inches) | Avg. Length (Linear Ft./Roll) | Approx. Wt./Roll |
|--------------------|------------------------|-------------------------------|------------------|
| B60-01 x 36 x 67 | 1/32" x 36" | 67 ft. | 56 lbs. |
| B60-02 x 36 x 67 | 1/16" x 36" | 67 ft. | 100 lbs. |
| B60-03 x 36 x 67 | 3/32" x 36" | 67 ft. | 150 lbs. |
| B60-04 x 36 x 67 | 1/8" x 36" | 67 ft. | 200 lbs. |
| B60-06 x 36 x 36 | 3/16" x 36" | 36 ft. | 161 lbs. |
| B60-08 x 36 x 36 | 1/4" x 36" | 36 ft. | 215 lbs. |
| * B60-02 x 48 x 67 | 1/16" x 48" | 67 ft. | 133 lbs. |
| * B60-04 x 48 x 67 | 1/8" x 48" | 67 ft. | 266 lbs. |
| * B60-06 x 48 x 36 | 3/16" x 48" | 36 ft. | 215 lbs. |
| * B60-08 x 48 x 36 | 1/4" x 48" | 36 ft. | 287 lbs. |

*New Stocked Lengths

General Properties of Nitrile†

- Excellent resistance to petroleum-based fluids
- Good physical properties.

† Properties shown based on Rubber Manufacturers Association Sheet Rubber Handbook, second edition.

FDA WHITE NITRILE SHEET

SPECIFICATIONS:

Food grade white nitrile sheet, made from FDA-approved materials (Title 21 Food and Drug S 177.26000):

Style W60: 60 Duro hardness (Shore Durometer A)

Polymer: Nitrile-Butadiene

Common Name: Nitrile, Buna-N

ISO/ASTM Designation: NBR

| Style | ASTM Specification (SI units) | Temp. Range | Durometer | Tensile Strength (PSI) | Elongation (%) | Finish |
|-------|----------------------------------|-----------------|-----------|---------------------------|-------------------|--------|
| W60 | D 2000 M1BG 608 | -31°F to +230°F | 55 – 65 | 1100 | 400% | Plate |

ORDERING INFORMATION:

| Item Number | Gauge x Width (Inches) | Avg. Length (Linear Ft./Roll) | Approx. Wt./Roll |
|------------------|---------------------------|----------------------------------|---------------------|
| W60-02 x 36 x 67 | 1/16" x 36" | 67 ft. | 92 lbs. |
| W60-03 x 36 x 67 | 3/32" x 36" | 67 ft. | 137 lbs. |
| W60-04 x 36 x 36 | 1/8" x 36" | 36 ft. | 98 lbs. |
| W60-06 x 36 x 18 | 3/16" x 36" | 18 ft. | 74 lbs. |
| W60-08 x 36 x 18 | 1/4" x 36" | 18 ft. | 98 lbs. |
| W60-02 x 48 x 36 | 1/16" x 48" | 36 ft. | 66 lbs. |
| W60-04 x 48 x 36 | 1/8" x 48" | 36 ft. | 131 lbs. |
| W60-06 x 48 x 18 | 3/16" x 48" | 18 ft. | 98 lbs. |
| W60-08 x 48 x 18 | 1/4" x 48" | 18 ft. | 131 lbs. |

General Properties of SBR†

- Excellent physical properties.

† Properties shown based on Rubber Manufacturers Association Sheet Rubber Handbook, second edition.

BLACK CLOTH-INSERTED SBR SHEET

SPECIFICATIONS:

Commercial grade black SBR sheet, with cloth reinforcement:

Style CI: 60 Duro hardness (Shore Durometer A)

Polymer: Styrene-Butadiene Rubber reinforced with 3.4 oz./sq. yd. nylon fabric

Common Name: Cloth-reinforced Black Rubber Sheet

ISO/ASTM Designation: SBR

| Style | ASTM Specification (SI units) | Temp. Range | Ply | Durometer | Tensile Strength (PSI) | Finish |
|-------|----------------------------------|-----------------|-----|-----------|---------------------------|--------|
| CI | D 2000 M2AA 603 | -20°F to +170°F | 1 | 55 – 65 | 600 | Plate |
| CI | D 2000 M2AA 603 | -20°F to +170°F | 2 | 55 – 65 | 600 | Plate |
| CI | D 2000 M2AA 603 | -20°F to +170°F | 3 | 55 – 65 | 600 | Plate |
| CI | D 2000 M2AA 603 | -20°F to +170°F | 4 | 55 – 65 | 600 | Plate |

ORDERING INFORMATION:

| Item Number | Gauge x Width (Inches) | Fabric Plies | Avg. Length (Linear Ft./Roll) | Approx. Wt./Roll |
|-------------------|---------------------------|-----------------|----------------------------------|---------------------|
| CI-1P02 x 48 x 67 | 1/16" x 48" | 1 Ply | 67 ft. | 132 lbs. |
| CI-1P04 x 48 x 36 | 1/8" x 48" | 1 Ply | 36 ft. | 140 lbs. |
| CI-2P04 x 48 x 36 | 1/8" x 48" | 2 Ply | 36 ft. | 140 lbs. |
| CI-2P06 x 48 x 18 | 3/16" x 48" | 2 Ply | 18 ft. | 107 lbs. |
| CI-2P08 x 48 x 18 | 1/4" x 48" | 2 Ply | 18 ft. | 140 lbs. |
| CI-3P06 x 48 x 18 | 3/16" x 48" | 3 Ply | 18 ft. | 107 lbs. |
| CI-4P08 x 48 x 18 | 1/4" x 48" | 4 Ply | 18 ft. | 140 lbs. |

BLACK SBR SHEET

General Properties of SBR†

- Good physical properties.

† Properties shown based on Rubber Manufacturers Association Sheet Rubber Handbook, second edition.

SPECIFICATIONS:

Commercial grade black SBR sheet:

Style BL60: 65 Duro hardness (Shore Durometer A)

Polymer: Styrene-Butadiene

Common Name: Black Rubber Sheet

ISO/ASTM Designation: SBR

| Style | ASTM Specification (SI units) | Temp. Range | Durometer | Tensile Strength (PSI) | Elongation (%) | Finish |
|-------|-------------------------------|-----------------|-----------|------------------------|----------------|--------|
| BL60 | D 2000 M1AA 604 | -13°F to +158°F | 60 – 70 | 600 | 200% | Plate |

ORDERING INFORMATION:

| Item Number | Gauge x Width (Inches) | Avg. Length (Linear Ft./Roll) | Approx. Wt./Roll |
|-------------------|------------------------|-------------------------------|------------------|
| BL60-02 x 48 x 67 | 1/16" x 48" | 67 ft. | 131 lbs. |
| BL60-04 x 48 x 36 | 1/8" x 48" | 36 ft. | 140 lbs. |
| BL60-08 x 48 x 18 | 1/4" x 48" | 18 ft. | 140 lbs. |

RED SBR SHEET Plate & Fabric Finish

General Properties of SBR†

- Good physical properties.

† Properties shown based on Rubber Manufacturers Association Sheet Rubber Handbook, second edition.

SPECIFICATIONS:

**Commercial grade red SBR sheet,
Plate or Fabric Finish:**

Style R75: 70 Duro hardness (Shore Durometer A)

Style RF75: 70 Duro hardness (Shore Durometer A)

Polymer: Styrene-Butadiene

Common Name: Red Rubber Sheet

ISO/ASTM Designation: SBR

Meets D1330 Grade 1

| Style | ASTM Specification (SI units) | Temp. Range | Durometer | Tensile Strength (PSI) | Elongation (%) | Finish |
|-------|-------------------------------|-----------------|-----------|------------------------|----------------|-------------------|
| R75 | D 2000 M1AA 705 | -22°F to +158°F | 65 – 75 | 600 | 200% | Plate |
| RF75 | D 2000 M1AA 705 | -22°F to +158°F | 65 – 75 | 600 | 200% | Fabric Impression |

ORDERING INFORMATION:

| Item Number | Gauge x Width (Inches) | Avg. Length (Linear Ft./Roll) | Approx. Wt./Roll |
|------------------|------------------------|-------------------------------|------------------|
| Plate Finish | Fabric Impression | | |
| R75-02 x 36 x 67 | RF75-02 x 36 x 67 | 1/16" x 36" | 106 lbs. |
| R75-04 x 36 x 36 | RF75-04 x 36 x 36 | 1/8" x 36" | 114 lbs. |
| R75-06 x 36 x 36 | RF75-06 x 36 x 36 | 3/16" x 36" | 171 lbs. |
| R75-08 x 36 x 18 | RF75-08 x 36 x 18 | 1/4" x 36" | 114 lbs. |
| R75-02 x 48 x 67 | RF75-02 x 48 x 67 | 1/16" x 48" | 141 lbs. |
| R75-03 x 48 x 67 | RF75-03 x 48 x 67 | 3/32" x 48" | 211 lbs. |
| R75-04 x 48 x 36 | RF75-04 x 48 x 36 | 1/8" x 48" | 152 lbs. |
| R75-06 x 48 x 36 | RF75-06 x 48 x 36 | 3/16" x 48" | 228 lbs. |
| R75-08 x 48 x 18 | RF75-08 x 48 x 18 | 1/4" x 48" | 152 lbs. |

General Properties of VITON®

- Excellent resistance to many concentrated acids.
- Excellent resistance to heat.

† Properties shown based on Rubber Manufacturers Association Sheet Rubber Handbook, second edition.

SPECIFICATIONS:

Commercial grade black VITON® sheet:

Style VI70: 72 Duro hardness (Shore Durometer A)

| Style | ASTM Specification (SI units) | Temp. Range | Durometer | Tensile Strength (PSI) | Elongation (%) | Finish |
|-------|-------------------------------|-----------------|-----------|------------------------|----------------|--------|
| VI70 | D 2000 M1HK 704 | -14°F to +482°F | 72 | 600 | 165% | Plate |

ORDERING INFORMATION:

| Item Number | Gauge x Width (Inches) | Avg. Length (Linear Ft./Roll) | Approx. Wt./Roll |
|---------------------|------------------------|-------------------------------|------------------|
| VI70-01 x 36 x 30 | 1/32" x 36" | 30 ft. | 29 lbs. |
| * VI70-02 x 36 x 10 | 1/16" x 36" | 10 ft. | 19 lbs. |
| VI70-02 x 36 x 30 | 1/16" x 36" | 30 ft. | 58 lbs. |
| * VI70-03 x 36 x 10 | 3/32" x 36" | 10 ft. | 28 lbs. |
| VI70-03 x 36 x 30 | 3/32" x 36" | 30 ft. | 85 lbs. |
| * VI70-04 x 36 x 10 | 1/8" x 36" | 10 ft. | 37 lbs. |
| * VI70-04 x 36 x 15 | 1/8" x 36" | 15 ft. | 55 lbs. |
| VI70-04 x 36 x 30 | 1/8" x 36" | 30 ft. | 110 lbs. |
| * VI70-06 x 36 x 10 | 3/16" x 36" | 10 ft. | 57 lbs. |
| VI70-06 x 36 x 30 | 3/16" x 36" | 30 ft. | 170 lbs. |
| * VI70-08 x 36 x 10 | 1/4" x 36" | 10 ft. | 74 lbs. |
| * VI70-08 x 36 x 15 | 1/4" x 36" | 15 ft. | 111 lbs. |
| VI70-08 x 36 x 30 | 1/4" x 36" | 30 ft. | 222 lbs. |

*New Stocked Lengths

VITON® SHEET

Note: VITON® is a registered trademark of DuPont Dow Elastomers.

Polymer: Hexafluoropropylene Vinylidene Fluoride

Common Name: Viton

ISO/ASTM Designation: FKM

General Properties of HYPALON®

- Excellent resistance to oxidation and outstanding resistance to strong sunlight and ozone.
- Good resistance to general acids, oils and greases.

† Properties shown based on Rubber Manufacturers Association Sheet Rubber Handbook, second edition.

SPECIFICATIONS:

HYPALON® rubber sheet:

Style HY60: 60 Duro hardness (Shore Durometer A)

| Style | ASTM Specification (SI units) | Temp. Range | Durometer | Tensile Strength (PSI) | Elongation (%) | Finish |
|-------|-------------------------------|-----------------|-----------|------------------------|----------------|--------|
| HY60 | D 2000 M1CE 614 | -31°F to +257°F | 55 – 65 | 1400 | 350% | Plate |

ORDERING INFORMATION:

| Item Number | Gauge x Width (Inches) | Avg. Length (Linear Ft./Roll) | Approx. Wt./Roll |
|-------------------|------------------------|-------------------------------|------------------|
| HY60-02 x 36 x 67 | 1/16" x 36" | 67 ft. | 88 lbs. |
| HY60-04 x 36 x 67 | 1/8" x 36" | 67 ft. | 176 lbs. |
| HY60-06 x 36 x 36 | 3/16" x 36" | 36 ft. | 142 lbs. |
| HY60-08 x 36 x 36 | 1/4" x 36" | 36 ft. | 190 lbs. |

HYPALON® SHEET

Note: HYPALON® is a registered trademark of DuPont Dow Elastomers.

Polymer: Chlorosulphonated Polyethylene

Common Name: Hypalon

ISO/ASTM Designation: CSM

EPDM SHEET

General Properties of EPDM[†]

- Good ozone, chemical and aging resistance

[†] Properties shown based on Rubber Manufacturers Association Sheet Rubber Handbook, second edition.

SPECIFICATIONS:

Commercial grade black EPDM sheet:

Style E60: 60 Duro hardness (Shore Durometer A)

Polymer: Ethylene-Propylene-Diene-Monomer

Common Name: Ethylene-Propylene Rubber

ISO/ASTM Designation: EPDM

| Style | ASTM Specification (SI units) | Temp. Range | Durometer | Tensile Strength (PSI) | Elongation (%) | Finish |
|-------|-------------------------------|-----------------|-----------|------------------------|----------------|--------|
| E60 | D 2000 M2BA 608 | -20°F to +230°F | 55 – 65 | 1100 | 350% | Plate |

ORDERING INFORMATION:

| Item Number | Gauge x Width (Inches) | Avg. Length (Linear Ft./Roll) | Approx. Wt./Roll |
|------------------|------------------------|-------------------------------|------------------|
| E60-02 x 36 x 67 | 1/16" x 36" | 67 ft. | 92 lbs. |
| E60-04 x 36 x 67 | 1/8" x 36" | 67 ft. | 183 lbs. |
| E60-06 x 36 x 36 | 3/16" x 36" | 36 ft. | 148 lbs. |
| E60-08 x 36 x 36 | 1/4" x 36" | 36 ft. | 197 lbs. |
| E60-02 x 48 x 67 | 1/16" x 48" | 67 ft. | 122 lbs. |
| E60-04 x 48 x 67 | 1/8" x 48" | 67 ft. | 244 lbs. |
| E60-06 x 48 x 36 | 3/16" x 48" | 36 ft. | 197 lbs. |
| E60-08 x 48 x 36 | 1/4" x 48" | 36 ft. | 263 lbs. |

SILICONE SHEET

General Properties of Silicone[†]

- Excellent resistance to heat.
- Good physical properties.

[†] Properties shown based on Rubber Manufacturers Association Sheet Rubber Handbook, second edition.

SPECIFICATIONS:

Commercial grade red silicone sheet:

Style SIL60: 60 Duro hardness (Shore Durometer A)

Polymer: Polydimethylsiloxane

Common Name: Silicone

ISO/ASTM Designation: FE

| Style | ASTM Specification (SI units) | Temp. Range | Durometer | Tensile Strength (PSI) | Elongation (%) | Finish |
|-------|-------------------------------|-----------------|-----------|------------------------|----------------|--------|
| SIL60 | D 2000 M2FE 607 B37 | -94°F to +392°F | 55 – 65 | 1100 | 300% | Plate |

ORDERING INFORMATION:

| Item Number | Gauge x Width (Inches) | Avg. Length (Linear Ft./Roll) | Approx. Wt./Roll |
|--------------------|------------------------|-------------------------------|------------------|
| SIL60-01 x 36 x 35 | 1/32" x 36" | 35 ft. | 22 lbs. |
| SIL60-02 x 36 x 35 | 1/16" x 36" | 35 ft. | 44 lbs. |
| SIL60-03 x 36 x 35 | 3/32" x 36" | 35 ft. | 67 lbs. |
| SIL60-04 x 36 x 35 | 1/8" x 36" | 35 ft. | 89 lbs. |
| SIL60-06 x 36 x 35 | 3/16" x 36" | 35 ft. | 133 lbs. |
| SIL60-08 x 36 x 35 | 1/4" x 36" | 35 ft. | 178 lbs. |
| SIL60-01 x 48 x 35 | 1/32" x 48" | 35 ft. | 30 lbs. |
| SIL60-02 x 48 x 35 | 1/16" x 48" | 35 ft. | 59 lbs. |
| SIL60-03 x 48 x 35 | 3/32" x 48" | 35 ft. | 89 lbs. |
| SIL60-04 x 48 x 35 | 1/8" x 48" | 35 ft. | 118 lbs. |
| SIL60-06 x 48 x 35 | 3/16" x 48" | 35 ft. | 178 lbs. |
| SIL60-08 x 48 x 35 | 1/4" x 48" | 35 ft. | 237 lbs. |

General Properties of Pure Gum†

- Excellent physical properties
- Excellent abrasion-resistance
- Excellent low temperature resistance
- Good resistance to most acids

† Properties shown based on Rubber Manufacturers Association Sheet Rubber Handbook, second edition.

TAN PURE GUM SHEET

SPECIFICATIONS:

Tan pure gum rubber sheet:

Style GF40: 40 Duro hardness (Shore Durometer A)

Polymer: Isoprene rubber (natural)

Common Name: Natural Rubber Sheet

ISO/ASTM Designation: NR

| Style | ASTM Specification (SI units) | Temp. Range | Durometer | Tensile Strength (PSI) | Elongation (%) | Finish |
|-------|----------------------------------|-----------------|-----------|---------------------------|-------------------|--------|
| GF40 | D 2000 M1AA 424 | -40°F to +176°F | 35 – 45 | 3400 | 600% | Plate |

ORDERING INFORMATION:

| Item Number | Gauge x Width (Inches) | Avg. Length (Linear Ft./Roll) | Approx. Wt./Roll |
|-------------------|---------------------------|----------------------------------|---------------------|
| GF40-02 x 36 x 67 | 1/16" x 36" | 67 ft. | 65 lbs. |
| GF40-04 x 36 x 67 | 1/8" x 36" | 67 ft. | 131 lbs. |
| GF40-06 x 36 x 67 | 3/16" x 36" | 67 ft. | 196 lbs. |
| GF40-08 x 36 x 36 | 1/4" x 36" | 36 ft. | 140 lbs. |
| GF40-12 x 36 x 36 | 3/8" x 36" | 36 ft. | 211 lbs. |
| GF40-16 x 36 x 18 | 1/2" x 36" | 18 ft. | 140 lbs. |
| GF40-24 x 36 x 18 | 3/4" x 36" | 18 ft. | 211 lbs. |
| GF40-32 x 36 x 18 | 1" x 36" | 18 ft. | 281 lbs. |
| GF40-02 x 48 x 67 | 1/16" x 48" | 67 ft. | 87 lbs. |
| GF40-04 x 48 x 36 | 1/8" x 48" | 36 ft. | 94 lbs. |
| GF40-06 x 48 x 36 | 3/16" x 48" | 36 ft. | 140 lbs. |
| GF40-08 x 48 x 18 | 1/4" x 48" | 18 ft. | 94 lbs. |

General Properties of Red Gum†

- Excellent physical properties
- High abrasion-resistance
- Good resilience

† Properties shown based on Rubber Manufacturers Association Sheet Rubber Handbook, second edition.

RED PURE GUM SHEET

SPECIFICATIONS:

Red pure gum rubber sheet:

Style RG45: 45 Duro hardness (Shore Durometer A)

Polymer: Isoprene rubber (natural)

Common Name: Natural Rubber Sheet

ISO/ASTM Designation: NR

| Style | ASTM Specification (SI units) | Temp. Range | Durometer | Tensile Strength (PSI) | Elongation (%) | Finish |
|-------|----------------------------------|-----------------|-----------|---------------------------|-------------------|--------|
| RG45 | D 2000 M1AA 414 | -40°F to +185°F | 40 – 50 | 2400 | 600% | Plate |

ORDERING INFORMATION:

| Item Number | Gauge x Width (Inches) | Avg. Length (Linear Ft./Roll) | Approx. Wt./Roll |
|-------------------|---------------------------|----------------------------------|---------------------|
| RG45-12 x 48 x 25 | 3/8" x 48" | 25 ft. | 205 lbs. |
| RG45-16 x 48 x 25 | 1/2" x 48" | 25 ft. | 273 lbs. |
| RG45-24 x 48 x 25 | 3/4" x 48" | 25 ft. | 410 lbs. |
| RG45-32 x 48 x 25 | 1" x 48" | 25 ft. | 546 lbs. |

BLACK "V" CORRUGATED RUBBER MATTING

SPECIFICATIONS: Blended SBR/Natural Rubber

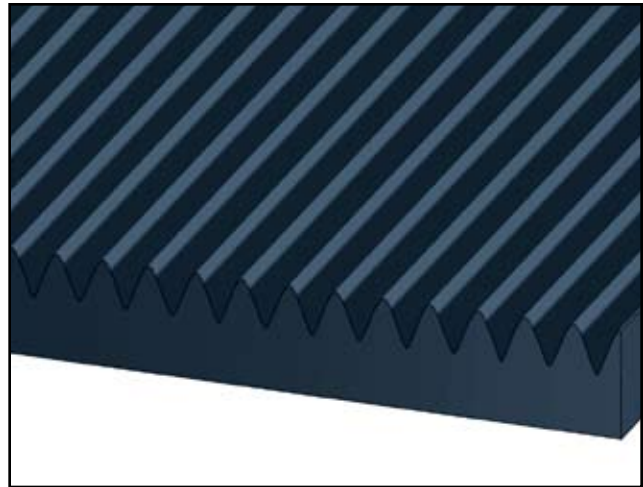

Provides floor protection in entrances and hallways in offices and plants. "V" corrugation allows for easy cleaning.

ORDERING INFORMATION:

| Item Number | Gauge x Width (Inches) | Temp. Range | Average Length (Linear Ft./Roll) | Approx. Wt./Roll |
|------------------|------------------------|-----------------|----------------------------------|------------------|
| MAT-04 X 24 X 75 | 1/8" X 24" | -13°F to +158°F | 75 ft. | 101 lbs. |
| MAT-04 X 36 X 75 | 1/8" X 36" | -13°F to +158°F | 75 ft. | 152 lbs. |
| MAT-04 X 48 X 75 | 1/8" X 48" | -13°F to +158°F | 75 ft. | 203 lbs. |

BLACK WIDE-RIBBED PREMIUM RUBBER MATTING



Made with a blend of SBR/Natural Rubber for tough, long lasting service.

This premium wide-ribbed rubber matting is ideal for many uses:

- Factory work stations ■ Hallway runners
- Protective covering for carpets

Features:

- Easy to maintain
- Easy to clean:
 - ★ Wet Mop
 - ★ Garden Hose
 - ★ Household Broom
 - ★ Vacuum Cleaner

ORDERING INFORMATION:

| Item Number | Gauge x Width (Inches) | Temp. Range | Average Length (Linear Ft./Roll) | Approx. Wt./Roll |
|----------------|------------------------|-----------------|----------------------------------|------------------|
| EZMAT-04X24X75 | 1/8" X 24" | -13°F to +158°F | 75 Ft. | 111 lbs. |
| EZMAT-04X36X75 | 1/8" X 36" | -13°F to +158°F | 75 Ft. | 167 lbs. |
| EZMAT-04X48X75 | 1/8" X 48" | -13°F to +158°F | 75 Ft. | 222 lbs. |

HONEYCOMB COMFORT MATTING

General Properties of Nitrile[†]

- Excellent resistance to petroleum-based fluids
- Good physical properties.

General Properties of SBR[†]

- Good physical properties.

[†] Properties shown based on Rubber Manufacturers Association Sheet Rubber Handbook, second edition.

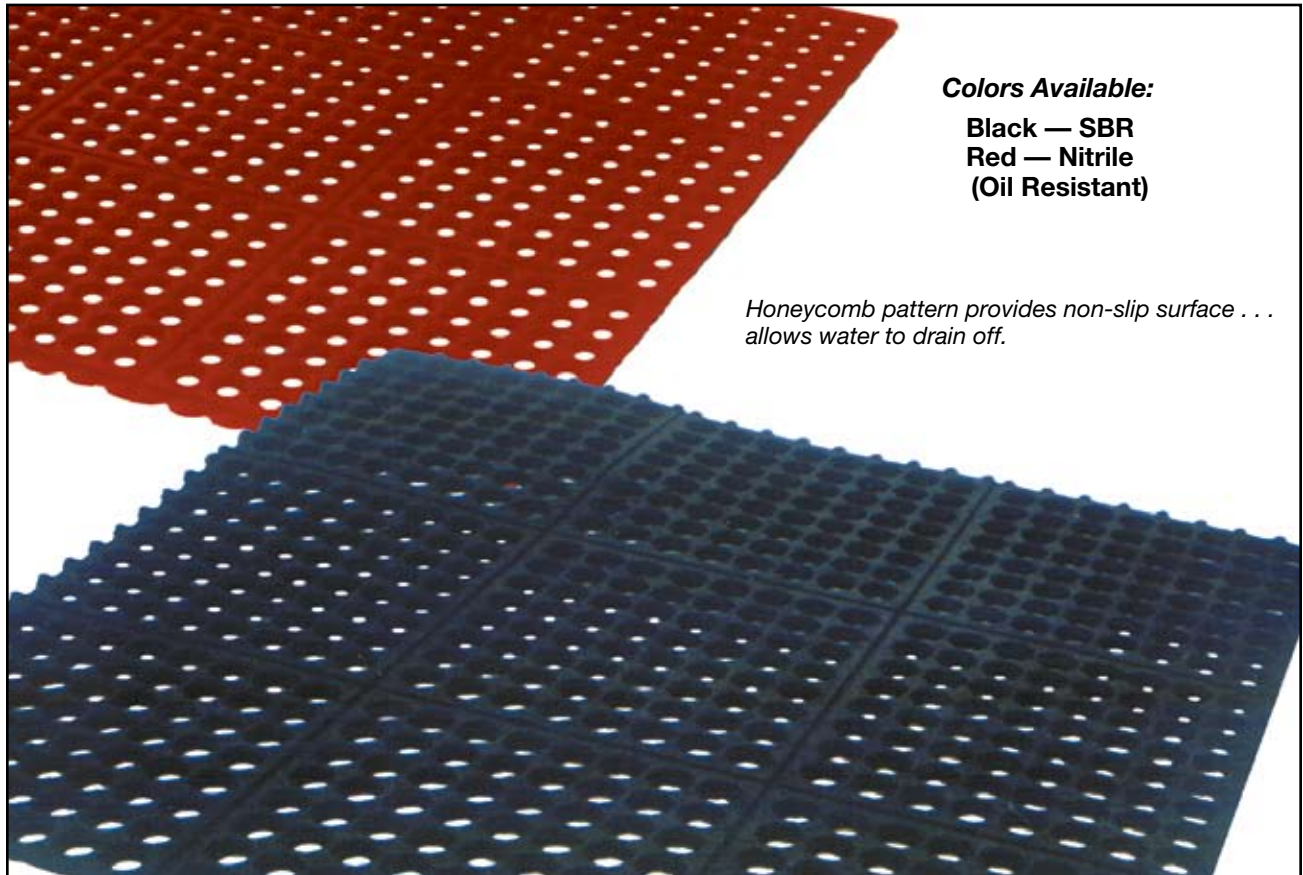

Colors Available:

Black — SBR
Red — Nitrile
(Oil Resistant)

Honeycomb pattern provides non-slip surface . . . allows water to drain off.

SPECIFICATIONS:

Hardness: 55 Duro hardness (Shore Durometer A)

Tensile Strength: 240 PSI

Elongation: 300%

Cold Resistance: -20° F.

Black Comfort Matting:

Polymer: Styrene-Butadiene

Common Name: Black Rubber

ISO/ASTM Designation: SBR

Red Comfort Matting:

Polymer: Nitrile-Butadiene

Common Name: Nitrile, Buna-N

ISO/ASTM Designation: NBR

| Item No. | Gauge Thickness | Size | Approx. Weight per Piece |
|--------------|-----------------|---------|--------------------------|
| BLKHCMAT-3X3 | 5/8" | 3' X 3' | 16 lbs. |
| REDHCMAT-3X3 | 5/8" | 3' X 3' | 16 lbs. |

SKIRTBOARD RUBBER

General Properties of Skirtboard Rubber

- Excellent abrasion-resistance
- Excellent weather-resistance

PACKAGING: 50 Ft. Rolls

SPECIFICATIONS:

Blended SBR/NR slit sheet,
Plate Finish:

Style SK60: 60 Duro hardness (Shore Durometer A)

Polymer: Styrene-Butadiene and Isoprene Rubber, Natural

Color: Black

Common Name: Skirtboard Rubber

ISO/ASTM Designation: SBR/NR

| Style | ASTM Specification (SI units) | Temp. Range | Durometer | Tensile Strength (PSI) | Elongation (%) | Finish |
|-------|-------------------------------|-----------------|-----------|------------------------|----------------|--------|
| SK60 | D 2000 M1AA 608 | -22°F to +158°F | 55 – 65 | 1100 | 400% | Plate |

ORDERING INFORMATION:

| Item Number | Gauge x Width (Inches) | Avg. Length (Linear Ft./Roll) | Approx. Wt./Roll |
|-------------------|------------------------|-------------------------------|------------------|
| SK60-08 x 3 x 50 | 1/4" x 3" | 50 ft. | 23 lbs. |
| SK60-08 x 4 x 50 | 1/4" x 4" | 50 ft. | 30 lbs. |
| SK60-08 x 5 x 50 | 1/4" x 5" | 50 ft. | 38 lbs. |
| SK60-08 x 6 x 50 | 1/4" x 6" | 50 ft. | 45 lbs. |
| SK60-08 x 8 x 50 | 1/4" x 8" | 50 ft. | 61 lbs. |
| SK60-08 x 10 x 50 | 1/4" x 10" | 50 ft. | 76 lbs. |
| SK60-08 x 12 x 50 | 1/4" x 12" | 50 ft. | 91 lbs. |
| SK60-12 x 3 x 50 | 3/8" x 3" | 50 ft. | 34 lbs. |
| SK60-12 x 4 x 50 | 3/8" x 4" | 50 ft. | 45 lbs. |
| SK60-12 x 5 x 50 | 3/8" x 5" | 50 ft. | 57 lbs. |
| SK60-12 x 6 x 50 | 3/8" x 6" | 50 ft. | 68 lbs. |
| SK60-12 x 8 x 50 | 3/8" x 8" | 50 ft. | 91 lbs. |
| SK60-12 x 10 x 50 | 3/8" x 10" | 50 ft. | 114 lbs. |
| SK60-12 x 12 x 50 | 3/8" x 12" | 50 ft. | 136 lbs. |
| SK60-16 x 3 x 50 | 1/2" x 3" | 50 ft. | 45 lbs. |
| SK60-16 x 4 x 50 | 1/2" x 4" | 50 ft. | 61 lbs. |
| SK60-16 x 5 x 50 | 1/2" x 5" | 50 ft. | 76 lbs. |
| SK60-16 x 6 x 50 | 1/2" x 6" | 50 ft. | 91 lbs. |
| SK60-16 x 8 x 50 | 1/2" x 8" | 50 ft. | 121 lbs. |
| SK60-16 x 10 x 50 | 1/2" x 10" | 50 ft. | 151 lbs. |
| SK60-16 x 12 x 50 | 1/2" x 12" | 50 ft. | 182 lbs. |
| SK60-24 x 3 x 50 | 3/4" x 3" | 50 ft. | 68 lbs. |
| SK60-24 x 6 x 50 | 3/4" x 6" | 50 ft. | 136 lbs. |
| SK60-24 x 8 x 50 | 3/4" x 8" | 50 ft. | 182 lbs. |
| SK60-24 x 9 x 50 | 3/4" x 9" | 50 ft. | 205 lbs. |
| SK60-24 x 10 x 50 | 3/4" x 10" | 50 ft. | 227 lbs. |
| SK60-24 x 12 x 50 | 3/4" x 12" | 50 ft. | 273 lbs. |
| SK60-32 x 3 x 50 | 1" x 3" | 50 ft. | 91 lbs. |
| SK60-32 x 6 x 50 | 1" x 6" | 50 ft. | 182 lbs. |
| SK60-32 x 8 x 50 | 1" x 8" | 50 ft. | 242 lbs. |
| SK60-32 x 10 x 50 | 1" x 10" | 50 ft. | 303 lbs. |
| SK60-32 x 12 x 50 | 1" x 12" | 50 ft. | 363 lbs. |
| SK60-48 x 10 x 50 | 1 1/2" x 10" | 50 ft. | 455 lbs. |

48" Wide Skirtboard Rubber Sheet

| | | | |
|-------------------|------------|--------|-----------|
| SK60-08 x 48 x 50 | 1/4" x 48" | 50 ft. | 363 lbs. |
| SK60-12 x 48 x 50 | 3/8" x 48" | 50 ft. | 545 lbs. |
| SK60-16 x 48 x 50 | 1/2" x 48" | 50 ft. | 727 lbs. |
| SK60-24 x 48 x 50 | 3/4" x 48" | 50 ft. | 1090 lbs. |
| SK60-32 x 48 x 50 | 1" x 48" | 50 ft. | 1454 lbs. |

General Properties of 80 Durometer Skirtboard Rubber

- Excellent abrasion-resistance
- Excellent weather-resistance

80 DUROMETER SKIRTBOARD

PACKAGING: 50 Ft. Rolls

SPECIFICATIONS:

**Blended NR slit sheet,
Plate Finish:**

Style SK80: 80 Duro hardness (Shore Durometer A)

Polymer: Natural and Synthetic Rubber

Color: Black

Common Name: Skirtboard Rubber

ISO/ASTM Designation: NR

Tensile Strength: 600 PSI

Elongation: 200%

Applications:

Slit to width for Belt Wipers, Snow Plow Blades and Squeegee use.

| Style | ASTM Specification (SI units) | Temp. Range | Durometer | Tensile Strength (PSI) | Elongation (%) | Finish |
|-------|----------------------------------|-----------------|-----------|---------------------------|-------------------|--------|
| SK80 | D 2000 M1AA 802 | -22°F to +158°F | 75 – 85 | 600 | 200% | Plate |

ORDERING INFORMATION:

| Item Number | Gauge x Width (Inches) | Avg. Length (Linear Ft./Roll) | Approx. Wt./Roll |
|-------------------|---------------------------|----------------------------------|---------------------|
| SK80-16 x 4 x 50 | 1/2" x 4" | 50 ft. | 61 lbs. |
| SK80-16 x 6 x 50 | 1/2" x 6" | 50 ft. | 91 lbs. |
| SK80-16 x 8 x 50 | 1/2" x 8" | 50 ft. | 121 lbs. |
| SK80-24 x 6 x 50 | 3/4" x 6" | 50 ft. | 137 lbs. |
| SK80-24 x 8 x 50 | 3/4" x 8" | 50 ft. | 182 lbs. |
| SK80-32 x 6 x 50 | 1" x 6" | 50 ft. | 182 lbs. |
| SK80-32 x 8 x 50 | 1" x 8" | 50 ft. | 243 lbs. |
| SK80-32 x 10 x 50 | 1" x 10" | 50 ft. | 303 lbs. |
| SK80-32 x 12 x 50 | 1" x 12" | 50 ft. | 364 lbs. |

CHANNEL RUBBER STRIP



SPECIFICATIONS:

Commercial grade black EPDM channel:

Hardness: 65 Duro hardness (Shore Durometer A)

Tensile Strength: 1,650 PSI

Elongation: 310%

STYLE RTCHNL
Round Top

STYLE THCHNL
Tapered Hex
Flat Top

STYLE HFTCHNL
Hex Flat Top

This channel rubber strip is ideal for use as a protective edge on shaker screens and a variety of other types of industrial equipment.

Standard Round Top Channel

| Item Number | Size (Inches) | A | DIMENSION | | |
|---------------|---------------|-----|-----------|-----|------|
| | | | B | C | D |
| RTCHNL-04X200 | 1/4" | .25 | .81 | .44 | .56 |
| RTCHNL-06X200 | 3/8" | .38 | 1.00 | .50 | .50 |
| RTCHNL-08X100 | 1/2" | .50 | 1.25 | .56 | .63 |
| RTCHNL-12X100 | 3/4" | .75 | 1.20 | .63 | 1.40 |

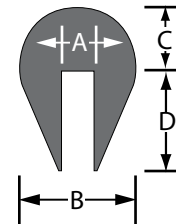

Tapered Hex-Flat Top Channel

| Item Number | Size (Inches) | A | DIMENSION | | |
|---------------|---------------|-----|-----------|-----|-----|
| | | | B | C | D |
| THCHNL-04X200 | 1/4" | .25 | .65 | .38 | .63 |
| THCHNL-06X200 | 3/8" | .38 | .85 | .50 | .63 |
| THCHNL-08X100 | 1/2" | .50 | 1.20 | .50 | .69 |
| THCHNL-12X100 | 3/4" | .75 | 1.45 | .50 | .75 |

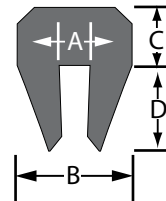

Hex-Flat Top Channel

| Item Number | Size (Inches) | A | DIMENSION | | |
|----------------|---------------|-----|-----------|-----|-----|
| | | | B | C | D |
| HFTCHNL-04X200 | 1/4" | .25 | .75 | .31 | .38 |
| HFTCHNL-06X200 | 3/8" | .38 | .88 | .31 | .44 |
| HFTCHNL-08X100 | 1/2" | .50 | 1.00 | .44 | .50 |
| HFTCHNL-12X100 | 3/4" | .75 | 1.25 | .50 | .63 |

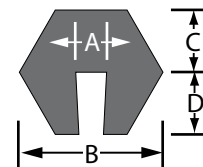

ORDERING INFORMATION:

| Item Number | Channel Size (Inches) | Roll Length Linear Ft. | Approx. Wt./Roll |
|----------------|-----------------------|------------------------|------------------|
| RTCHNL-04X200 | 1/4" | 200 | 50 lbs. |
| RTCHNL-06X200 | 3/8" | 200 | 70 lbs. |
| RTCHNL-08X100 | 1/2" | 100 | 51 lbs. |
| RTCHNL-12X100 | 3/4" | 100 | 70 lbs. |
| THCHNL-04X200 | 1/4" | 200 | 44 lbs. |
| THCHNL-06X200 | 3/8" | 200 | 64 lbs. |
| THCHNL-08X100 | 1/2" | 100 | 48 lbs. |
| THCHNL-12x100 | 3/4" | 100 | 62 lbs. |
| HFTCHNL-04X200 | 1/4" | 200 | 34 lbs. |
| HFTCHNL-06X200 | 3/8" | 200 | 42 lbs. |
| HFTCHNL-08X100 | 1/2" | 100 | 44 lbs. |
| HFTCHNL-12X100 | 3/4" | 100 | 40 lbs. |

SHEET RUBBER GLOSSARY

Adhesion: (1) Basically, the adhering, clinging, bonding or sticking of two material surfaces to one another, such as rubber to rubber, rubber to glass, rubber to metal, rubber to wood, rubber to fabric, rubber to cord, rubber to wire, etc. (2) Refers to the strength of bond between cured rubber surfaces or cured rubber surface and a non-rubber surface.

Aging: To undergo changes to physical properties with age or lapse of time.

Aging, Air Oven: A means of accelerating the change in physical properties of rubber compounds by exposing them to the action of air at an elevated temperature.

Ambient Temperature: The environment temperature surrounding the object under consideration.

Blemish: A mark, deformity, or injury which impairs the appearance.

Blisters: A raised spot on the surface or a separation between layers usually forming a void or air-filled space in the vulcanized article. (See bubbles, sinks and voids.)

Bloom: A coating or efflorescence creating a discoloration or change in appearance of the surface of a rubber product caused by the migration of a liquid or solid to the surface. Examples: Sulfur Bloom, Wax Bloom. Not to be confused with dust on the surface from external sources.

Calendered: Continuously sheeted or plied up rubber compound or fabric that is frictioned or coated with rubber compound on a machine equipped with three or more heavy internally heated or cooled rolls revolving in opposite direction.

Checking: Short, shallow cracks on the surface, generally due to effect of destructive action of environmental conditions.

C. I. (Cloth-inserted): An abbreviation used to indicate a sheet of rubber containing one or more plies of cloth or duck, in which the cloth is completely covered with rubber.

Cloth Impression: Same as fabric impression.

Coating: A layer of material covering a surface.

Compression Set: The deformation which remains in rubber after it has been subjected to and released from a specific compressive stress for a definite period of time at a prescribed temperature. Compression set measurements are made for the purpose of evaluating the

creep and stress relaxation properties of rubber.

Cracking: A sharp break or fissure in the surface. Generally due to excessive strain.

Crazing: A surface effect on rubber articles characterized by multitudinous minute cracks.

Cure: The act of vulcanization.

Curing Temperature: The temperature at which the rubber is vulcanized.

Diaphragm Sheet: Sheet (generally fabric-reinforced rubber) from which flat diaphragms may be cut.

Die Cut: Shaped articles punched from a sheet of rubber with a die.

Dielectric Strength: The measure of electric potential strength of a rubber product. Measure of its ability as an insulating compound to resist passage of a disruptive discharge produced by an electric stress. Measure as volts per mil of thickness.

Durometer: An instrument for measuring the hardness of rubber. Measures resistance to the penetration of an indenter point into the surface of the rubber.

Durometer Hardness: An arbitrary numerical value which measures the resistance to penetration of the indenter point of the durometer. Value may be taken immediately or after a very short specified time.

Elastomer: Macromolecular material that returns rapidly to approximately the initial dimensions and shape after substantial deformation by a weak stress and release of stress.

Elongation: Increase in length expressed numerically as a fraction or percentage of initial length.

Filler: (1) A material incorporated into a rubber compound to increase its bulk. (2) A compound built into a rubber product to increase its bulk and/or improve its appearance. (3) Sometimes erroneously used to mean "filling" in textiles.

Finish, Fabric: Same as impress, fabric.

Finish, Paper: Finish resulting from curing in contact with paper.

Finish Plate or Platen: Same as plate finish (sheet).

Foreign Material: Any extraneous matter such as wood, paper, metal, sand, dirt or pigment that should not normally be present in a particular rubber product or composition.

SHEET RUBBER GLOSSARY

Gauge: (1) The measure of thickness of the individual elements making up a rubber product. (2) A device for measuring. (See thickness.)

Grain: The effect on a rubber compound due to processing it through a tubing machine, calender, or mill.

Hardness: Property or extent of being hard. Measured by extent of failure of the indenter point of any one of a number of standard hardness testing instruments to penetrate the product.

Homogeneity: Uniformity of composition throughout the material.

Homogeneous: Of uniform composition throughout.

Impression: Design formed during vulcanization in the surface of any rubber article by a method of transfer, such as fabric impression or molded impression.

Impression, Fabric: Impression formed during cure by fabric wrap.

Laminated: Built up from thinner layers.

Modulus: In the physical testing of rubber, it is the ratio of stress to strain; that is, the load in pounds per square inch or kilograms per square centimeter of initial cross sectional-area necessary to produce a stated percentage elongation. It is a measure of stiffness.

Non-blooming: The absence of bloom.

Oxidation: The reaction of oxygen on a rubber product, usually detected by a change in the appearance or feel of the surface, or by a change in physical properties

Ozone Cracking: Surface cracks, checks or crazing caused by exposure to an atmosphere containing ozone. (See also ozone resistant.)

Ozone Resistant: Withstands the deteriorating effects of ozone, generally cracking.

Plate Finish (Sheet): A commercially smooth surface, the usual result of vulcanization between press plates (platens).

Ply: (1) A layer of rubberized fabric. (2) A layer consisting of multiple strands of cord or wire close spaced. (3) A single yarn in a composite yarn. (4) Used in processing as a layer of unvulcanized rubber compound.

Polymer: A very long chain of units of monomers, prepared by means of an addition and/or

condensation polymerization. The units may be the same or different. There are copolymers, di-polymers, tri or ter polymers, quadri-polymers, high polymers, etc. Natural rubber is a polymer of Isoprene.

Press Length: The length of a product which can be vulcanized at one time in a press, limited to the length measurement of the press.

Random Length: A unit of material which does not fall into any current classification for standard length.

Relative Humidity: The ratio of the quantity of water vapor actually present in the atmosphere to the greatest amount possible at the given temperature.

Roll: Sheet rubber and gasket material of a uniform width rolled up on itself from which gaskets and other products of lesser dimensions and various shapes may be cut.

Rubber: A material that is capable of recovering from large deformations quickly and forcibly, and can be, or already is, modified to a state in which it is essentially insoluble (but can swell) in boiling solvent, such as benzene, methyl ethyl ketone, and ethanol-toluene azeotrope.

Sinks: A collapsed blister or bubble leaving a depression in the product.

Slab: Thick sheet, generally laminated.

Specific Gravity: The ratio of the weight of a given substance to the weight of an equal volume of water at a specified temperature.

Tacky (Rubber Surface): Tending to adhere.

Tensile Strength: The maximum tensile stress applied during stretching a specimen to rupture.

Viscosity: A manifestation of internal friction opposed to mobility. The property of fluids and plastic solids by which they resist an instantaneous change of shape, i.e., resistant to flow.

Volume Swell: Increase in physical size caused by the swelling action of a liquid.

Vulcanization: Act or process of treating an elastomer or compound of same to improve its useful properties, usually accomplished by application of heat.

Warp: The yarns that run lengthwise in a woven fabric.

Waft: The crosswise threads in a fabric; filling threads. The threads or yarns running at right angle to the warp.

General properties of common polymers used in sheet rubber

| | Neoprene | Nitrile | EPDM | SBR | CI | Pure Gum | Silicone | Viton | Hypalon |
|------------------------------------|-----------|-----------|-----------|-----------|-----------|-------------|-----------|-----------|-----------|
| Heat Aging | Good | Good | Excellent | Good | Good | Good | Excellent | Excellent | Good |
| Abrasion Resistance | Excellent | Excellent | Very Good | Good | Good | Excellent | Poor | Fair | Fair |
| Compression Set | Fair | Fair | Fair | Good | Good | Good | Fair | Good | Good |
| Resilience | Excellent | Good | Good | Good | Good | Outstanding | Fair | Fair | Fair |
| Tear | Good | Good | Good | Fair | Good | Good | Good | Fair | Fair |
| Flame Resistance | Excellent | Poor | Very Poor | Very Poor | Very Poor | Very Poor | Fair | Good | Good |
| Weathering | Very Good | Fair | Excellent | Fair | Fair | Fair | Good | Excellent | Excellent |
| Ozone Resistance | Very Good | Very Poor | Good | Fair | Fair | Poor | Good | Excellent | Excellent |
| Gas Permeability Resistance | Good | Good | Good | Good | Good | Good | Poor | Poor | Poor |
| Oil Resistance | Good | Very Good | Very Poor | Poor | Poor | Very Poor | Fair | Good | Fair |
| Gas Resistance | Good | Excellent | Very Poor | Poor | Poor | Very Poor | Poor | Poor | Poor |
| Acid Resistance | Good | Good | Good | Fair | Fair | Good | Poor | Good | Good |
| Alkali Resistance | Good | Good | Good | Fair | Fair | Good | Poor | Good | Good |

TAKE NOTE!

The general properties shown in the chart above are not intended to be used to make final choices for a specific application. Exposure to heat, sunlight, chemicals, ozone and oils, as well as pressure, tension, binding, stretching and folding, will affect the performance of a rubber product.

Suitability must be determined by a qualified person. See Cautionary Statement on the next page.

Sheet Rubber Tolerances

(Tolerances conform to RMA standards, Durometer \pm 5 points.)

| Thickness | Tolerance | Thickness | Tolerance |
|-------------------------------------|-------------|------------------------------------|------------------|
| 1/32" but not including 1/16" | \pm .012" | 9/16" but not including 3/4" | \pm .062" |
| 1/16" but not including 1/8" | \pm .016" | 3/4" but not including 1" | \pm .094" |
| 1/8" but not including 3/16" | \pm .020" | 1" and Over..... | \pm 10% |
| 3/16" but not including 3/8" | \pm .031" | Width | Tolerance |
| 3/8" but not including 9/16" | \pm .047" | 36" and over | \pm 1.00" |