

# How to Properly Square a Belt End

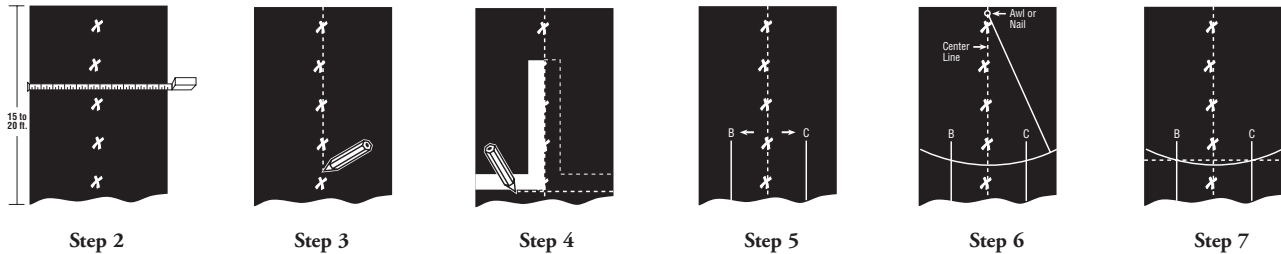

The following simple steps will help ensure that a belt is properly squared prior to mechanical fastener installation.

Step 1. Prior to any work on your conveyors, be certain that the power has been turned off and that the belt is “locked out.”

Step 2. Measure the belt width and establish center points at intervals of 3 to 5 feet (1 to 1.5 m). (A distance of 15 to 20 feet [4.5 to 6 m] back from the intended splice area is recommended.)

Step 3. Using either a steel straight edge or a chalk line, mark the average center line through the points measured in Step 2.

Step 4. Using a square, draw a line perpendicular to your average center line across the belt width.

Step 5. For even greater accuracy in preparing your squaring line – and on belts with worn edges – after completion of Step 3, mark two lines (B & C) equal distance from the center line in the area where the splice will be installed. Lines B & C must be parallel to the center line.

Step 6. Measure back from the intended splice area to a distance approximately equal to three times the belt width. At this point drive a nail or an awl on the center line. Using the nail or awl as a pivot point, swing an arc, marking the belt across its entire width.

Step 7. Where this arc intersects the two smaller lines (B & C) marked parallel to the belt center line, align a steel straight edge through these points and trace the line across the width of the belt. The resulting line is the true square.

Step 8. Cut the belt at this line using one of the specially engineered belt cutters from Flexco.

Step 9. Repeat Steps 1-8 on the other belt end.

Australia: 61-2-9680-3322 • England: 44-1457-891000 • Germany: 49-7428-9406-0  
Mexico: 52-55-5674-5326 • New Zealand: 64-9-415-4488 • Republic of South Africa: 27-11-974-2771

© 2003 Flexible Steel Lacing Company. 7/03, Part#X0755  
Flexco® is a registered trademark of Flexible Steel Lacing Company.



**Flexible Steel Lacing Company**  
2525 Wisconsin Avenue  
Downers Grove, IL 60515-4200 U.S.A.  
Telephone: (630) 971-0150  
Fax: (630) 971-1180  
E-mail: [advertising@flexco.com](mailto:advertising@flexco.com)  
Visit our Web site at: [www.flexco.com](http://www.flexco.com)

