

Couplings

Field Attachable 100 'B' Series Barb-Tite™

Use Hose H201/Easy Couple

Hose End Series: 100 'B' Series

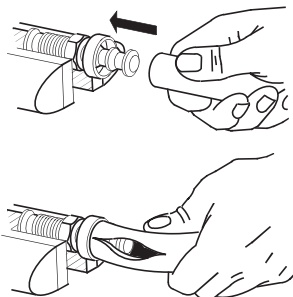

Note:

Refer to current price list for availability of cataloged items. Configurations and dimensions subject to change without notice.

Assembly Equipment

See page 185 for optional Assembly Tools.

CAUTION
Sealing integrity may be damaged by the use of clamps.

Typical Application: Low pressure shop or service air lines. Often used for low pressure lube and oil lines.

Compatible Hose: H201/Easy Couple

Pressure: Determined by maximum working pressure for hose size.

Material: CA360 brass

Advantages: Easy to assemble – just push the fitting onto the hose. No clamps needed! Low cost and a wide selection of configurations and sizes.

Ordering Information: Order individually by catalog number.

Assembly Instructions:

1. Lubricate insert.
2. Hold hose at angle as shown and push on and up over first barb.
3. Continue to push straight on until hose is seated under protective plastic cap. (Keep hand back from hose end area so that hose can expand.)

Disassembly Instructions:

1. Split hose as shown. Do not cut completely through hose. Sealing edge of barb could be damaged.
2. Bend hose and remove with quick pull.

Refer to important safety information found on pages 3-4 of this catalog.

Label Set: FS-500

Male Pipe Rigid

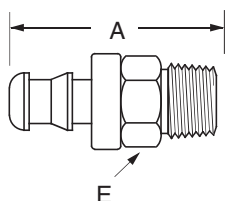

HOSE I.D.	PIPE SIZE	CATALOG NUMBER	THREAD SIZE	A	HOSE CUT-OFF FACTOR†	HOLE DIA.	HEX E
1/4	1/8	10004B-102	1/8-27	1.29	.65	.172	7/16
1/4	1/4	10004B-104	1/4-18	1.52	.88	.172	9/16
5/16	1/8	10005B-102	1/8-27	1.36	.69	.234	1/2
5/16	1/4	10005B-104	1/4-18	1.57	.87	.234	9/16
3/8	1/8	10006B-102	1/8-27	1.46	.69	.297	1/2
3/8	1/4	10006B-104	1/4-18	1.65	.88	.297	9/16
3/8	3/8	10006B-106	3/8-18	1.65	.88	.297	11/16
1/2	3/8	10008B-106	3/8-18	1.85	.94	.391	11/16
1/2	1/2	10008B-108	1/2-14	2.10	1.19	.391	7/8
5/8	1/2	10010B-108	1/2-14	2.60	1.19	.484	7/8
3/4	3/4	10012B-112	3/4-14	2.66	1.25	.609	1-1/16

SAE 45° Flare Male Rigid

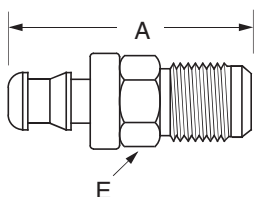

HOSE I.D.	PIPE SIZE	CATALOG NUMBER	THREAD SIZE	A	HOSE CUT-OFF FACTOR†	HOLE DIA.	HEX E
1/4	1/4	10004B-304	7/16-20	1.45	.81	.172	7/16
1/4	5/16	10004B-305	1/2-20	1.54	.94	.172	1/2
5/16	5/16	10005B-305	1/2-20	1.60	.94	.220	1/2
3/8	3/8	10006B-306	5/8-18	1.73	1.00	.297	5/8

†To determine the correct length of hose, subtract the cut-off factor for each end fitting from the overall length of assembly.