

**Reducing Nuts 41FS**

PART NO.	TUBE SIZE	STRAIGHT THREAD	C HEX	D	L
41FS-6-4	3/8 to 1/4	5/8-18	3/4	.257	1.00
41FS-8-6	1/2 to 3/8	3/4-16	7/8	.382	1.09
41FS-10-8	5/8 to 1/2	7/8-14	1-1/16	.507	1.25

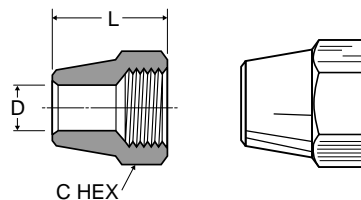

**Union 42F**

Ref. SAE 010101 \*Thread Protectors

PART NO.	TUBE SIZE	STRAIGHT THREAD	C HEX	L	D
42F-2	1/8	5/16-24	5/16	.90	.079
42F-3	3/16	3/8-24	3/8	1.04	.125
42F-4	1/4	7/16-20	7/16	1.17	.188
42F-5	5/16	1/2-20	1/2	1.32	.219
42F-6	3/8	5/8-18	5/8	1.48	.281
42F-8	1/2	3/4-16	3/4	1.79	.408
42F-10	5/8	7/8-14	7/8	2.10	.502
42F-12*	3/4	1-1/16-14	1-1/16	2.42	.626
42F-14*	7/8	1-1/4-12	1-1/4	2.72	.752

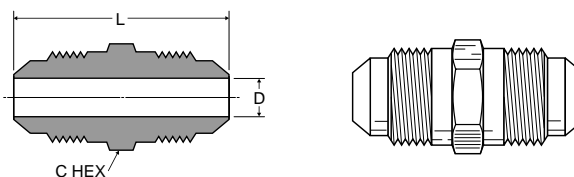

**Union Reducers 42F**

Ref. SAE 010101

PART NO.	1 TUBE SIZE	2 TUBE SIZE	1 STRAIGHT THREAD	2 STRAIGHT THREAD	C HEX	L	FLOW DIA. D1	FLOW DIA. D2
42F-6-4	1/4	3/8	7/16-20	5/8-18	5/8	1.36	.188	.281
42F-6-5	5/16	3/8	1/2-20	5/8-18	5/8	1.42	.219	.281
42F-8-4	1/4	1/2	7/16-20	3/4-16	3/4	1.54	.188	.408
42F-8-6	3/8	1/2	5/8-18	3/4-16	3/4	1.67	.281	.408
42F-10-6	3/8	5/8	5/8-18	7/8-14	7/8	1.86	.281	.502
42F-10-8	1/2	5/8	3/4-16	7/8-14	7/8	1.98	.408	.502

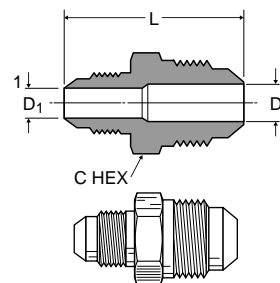

**Flare to Solder 43F**

Ref. SAE 010104

PART NO.	TUBE SIZE	SOLDER OD	STRAIGHT THREAD	C HEX	L	FLOW DIA. D
43F-4-4	1/4	1/4	7/16-20	7/16	.98	.189
43F-4-5	1/4	5/16	7/16-20	7/16	.98	.189
43F-4-6	1/4	3/8	7/16-20	1/2	.98	.189
43F-6-4	3/8	1/4	5/8-18	5/8	1.17	.189
43F-6-5	3/8	5/16	5/8-18	5/8	1.17	.252
43F-6-6	3/8	3/8	5/8-18	5/8	1.17	.283
43F-6-8	3/8	1/2	5/8-18	5/8	1.23	.283
43F-6-10	3/8	5/8	5/8-18	3/4	1.36	.283
43F-8-6	1/2	3/8	3/4-16	3/4	1.36	.314
43F-8-8	1/2	1/2	3/4-16	3/4	1.42	.408
43F-8-10	1/2	5/8	3/4-16	3/4	1.54	.408
43F-10-8	5/8	1/2	7/8-14	7/8	1.60	.440
43F-10-10	5/8	5/8	7/8-14	7/8	1.73	.502
43F-10-12	5/8	3/4	7/8-14	7/8	1.86	.502
43F-10-14	5/8	7/8	7/8-14	1	1.98	.502
43F-12-12	3/4	3/4	1-1/16-14	1-1/16	2.04	.627
43F-12-14	3/4	7/8	1-1/16-14	1-1/16	2.17	.627

