

20090 Replacement Socket for Field Attachable Fittings

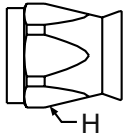

Steel Socket Part Number	Stainless Steel Socket Part Number	H Hex
#	#	
20090-4	20090-4C	9/16
20090-5	20090-5C	5/8
20090-6	20090-6C	11/16
20090-8	20090-8C	7/8
20090-10	20090-10C	1
20090-12	20090-12C	1-1/8
20090-16	20090-16C	1-3/8
20090-20	20090-20C	1-3/4

60 HAB SAE Compression Airbrake Sleeve

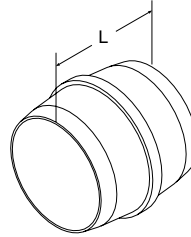

*Part Number	Tube Size	L
#		
60HAB-4	1/4	.250
60HAB-6	3/8	.313
60HAB-8	1/2	.375
60HAB-10	5/8	.438
60HAB-12	3/4	.500

*Brass
*To be used with "34" Fittings

090 Replacement Ferrule for 90 Series Field Attachable Fittings

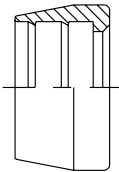

Brass Ferrule Part Number	Stainless Steel Ferrule Part Number	Hose Size
#	#	
090-4B	090-4C	-4
090-5B	090-5C	-5
090-6B	090-6C	-6
090-8B	090-8C	-8
090-10B	090-10C	-10
090-12B	090-12C	-12
090-16B	090-16C	-16
090-20B	090-20C	-20

61 HAB SAE Compression Airbrake Nut

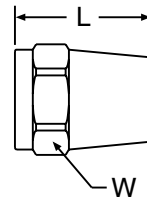

*Part Number	Thread Size	Tube Size	E		H Hex
#					
Hose Fitting		inch	inch	mm	inch
61HAB-4	7/16-24	1/4	0.75	19	9/16
61HAB-6	7/32-24	3/8	1.13	29	5/8
61HAB-8	11/16-20	1/2	1.25	32	13/16
61HAB-10	13/16-18	5/8	1.38	35	15/16
61HAB-12	1-18	3/4	1.56	40	1-1/8

*Brass
*To be used with "34" Fittings

(+) Non Standard. See page ii for information on non-standard products.