

Industrial Interchange Nipples

Pneumatic Quick Couplings

Features

- Parker Industrial Interchange nipples are for use with any Parker 20 Series, HF Series, 30 Series, Universal, HF or E-z-mate couplers.
- Parker Industrial Interchange nipples are interchangeable with similar nipples manufactured by other quick coupling manufacturers conforming to A-A-59439 (formerly known as MIL-C4109), ANSI/(NFPA) T3.20.14-1990, or ISO6150-B requirements.
- Hardened wear points** and solid barstock construction provide extended service life.
- Precision machined surfaces and hardened load-bearing areas** resist the effects of mechanical shock in the most rugged applications.
- The 20 Series, HF Series, 30 Series, Universal and E-z-mate couplers that mate with the Industrial Interchange nipples are located in their respective coupling "Type" (e.g. Manual Type) as noted in the Table of Contents.

** steel nipples only

Female Pipe Thread

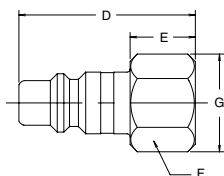
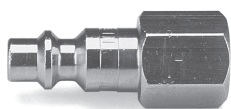

Body Size (in.)	Part No. Brass	Part No. Steel	Part No. Type 303 Stainless	Thread Size NPTF	Overall Length	Dimensions (in.)				Wt. (LB.) P/Piece
						Exposed Length*	Hex Size	Largest Diameter		
					D	E	F	G		
1/4	–	H1C	–	1/8-27	1.38	0.61	0.50	0.58	0.03	
1/4	BH3C	H3C	SH3C	1/4-18	1.56	0.80	0.62	0.72	0.05	
1/4	–	H3C-E	SH3C-E	3/8-18	1.60	0.83	0.81	0.94	0.08	
3/8	–	H1E	–	1/4-18	1.60	0.65	0.62	0.72	0.06	
3/8	BH3E	H3E	–	3/8-18	1.69	0.74	0.81	0.94	0.10	
3/8	–	H3E-F	–	1/2-14	1.84	0.90	1.00	1.16	0.13	
1/2	–	H1F	–	3/8-18	2.03	0.79	0.81	0.94	0.12	
1/2	BH3F	H3F	–	1/2-14	2.25	1.01	1.00	1.16	0.19	
1/2	–	H3F-G	–	3/4-14	2.38	1.13	1.25	1.44	0.26	
3/4	–	H3G-F	–	1/2-14	2.22	1.06	1.31	1.52	0.23	
3/4	–	H3G	–	3/4-14	2.22	1.06	1.31	1.52	0.34	
3/4	–	H3G-J	–	1-11 1/2	2.41	1.25	1.56	1.80	0.47	

*This dimension represents portion of nipple that is exposed when nipple is inserted in a Parker 20 Series coupler.

Male Pipe Thread

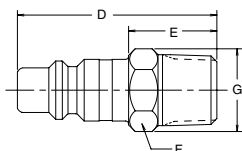

Body Size (in.)	Part No. Brass	Part No. Steel	Part No. Type 303 Stainless	Thread Size NPTF	Overall Length	Dimensions (in.)				Wt. (LB.) P/Piece
						Exposed Length*	Hex Size	Largest Diameter		
					D	E	F	G		
1/4	–	H0C	–	1/8-27	1.56	0.80	0.50	0.58	0.05	
1/4	BH2C	H2C	SH2C	1/4-18	1.66	0.89	0.56	0.65	0.06	
1/4	–	H2C-E	SH2C-E	3/8-18	1.81	1.05	0.69	0.80	0.07	
3/8	–	H00E	–	1/8-27	1.72	0.77	0.62	0.72	0.08	
3/8	–	H0E	–	1/4-18	1.88	0.93	0.62	0.72	0.08	
3/8	BH2E	H2E	–	3/8-18	1.91	0.96	0.69	0.80	0.09	
3/8	–	H2E-F	–	1/2-14	2.12	1.18	0.88	1.02	0.15	
1/2	–	H0F	–	3/8-18	2.31	1.07	0.69	0.79	0.16	
1/2	BH2F	H2F	–	1/2-14	2.48	1.22	0.88	1.01	0.18	
1/2	–	H2F-G	–	3/4-14	2.53	1.29	1.13	1.30	0.24	
3/4	–	H2G-F	–	1/2-14	2.32	1.16	1.00	1.16	0.22	
3/4	BH2G	H2G	–	3/4-14	2.38	1.22	1.06	1.22	0.28	
3/4	–	H2G-J	–	1-11 1/2	2.56	1.40	1.31	1.52	0.36	

*This dimension represents portion of nipple that is exposed when nipple is inserted in a Parker 20 Series coupler.

Quick Coupling Division