

## DT Series

### Check Valves

#### Specifications

The DT Series check valves have a Maximum Operating Pressure of 5000 PSI. Standard Crack Pressure is 5 PSI. Optional Crack Pressures up to 200 PSI in 5 PSI increments.

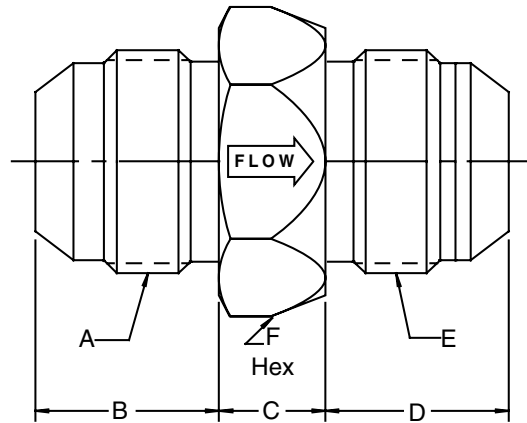

FITTING COMBINATION	DIMENSIONS	Valve Sizes				
		370	500	750	1000	1250
MFMF	"A"	.562-18UNF-2A	.750-16UNF-2A	1.062-12UN-2A	1.312-12UN-2A	1.625-12UN-2A
	"B"	.56	.66	.86	.91	.96
	"C"	.44	.50	.50	.62	1.06
	"D"	.56	.66	.86	.91	.96
	"E"	.562-18UNF-2A	.750-16UNF-2A	1.062-12UN-2A	1.312-12UN-2A	1.625-12UN-2A
	"F" HEX	.75	.88	1.25	1.50	1.88
MFMO	"A"	.562-18UNF-2A	.750-16UNF-2A	1.062-12UN-2A	1.312-12UN-2A	1.625-12UN-2A
	"B"	.56	.66	.86	.91	.96
	"C"	.44	.50	.50	.62	1.06
	"D"	.47	.55	.73	.73	.73
	"E"	.562-18UNF-2A	.750-16UNF-2A	1.062-12UN-2A	1.312-12UN-2A	1.625-12UN-2A
	"F" HEX	.75	.88	1.25	1.50	1.88
MOMF	"A"	.562-18UNF-2A	.750-16UNF-2A	1.062-12UN-2A	1.312-12UN-2A	1.625-12UN-2A
	"B"	.47	.55	.73	.73	.73
	"C"	.44	.50	.50	.62	1.06
	"D"	.56	.66	.86	.91	.96
	"E"	.562-18UNF-2A	.750-16UNF-2A	1.062-12UN-2A	1.312-12UN-2A	1.625-12UN-2A
	"F" HEX	.75	.88	1.25	1.50	1.88
MOMS	"A"	.562-18UNF-2A	.750-16UNF-2A	1.062-12UN-2A	1.312-12UN-2A	1.625-12UN-2A
	"B"	.47	.55	.73	.73	.73
	"C"	.44	.50	.50	.62	1.06
	"D"	.44	.50	.67	.69	.69
	"E"	.688-16UN-2A	.812-16UN-2A	1.188-12UN-2A	1.438-12UN-2A	1.688-12UN-2A
	"F" HEX	.75	.88	1.25	1.50	1.88
MSMO	"A"	.688-16UN-2A	.812-16UN-2A	1.188-12UN-2A	1.438-12UN-2A	1.688-12UN-2A
	"B"	.44	.50	.67	.69	.69
	"C"	.44	.50	.50	.62	1.06
	"D"	.47	.55	.73	.73	.73
	"E"	.562-18UNF-2A	.750-16UNF-2A	1.062-12UN-2A	1.312-12UN-2A	1.625-12UN-2A
	"F" HEX	.75	.88	1.25	1.50	1.88
MSMS	"A"	.688-16UN-2A	.812-16UN-2A	1.188-12UN-2A	1.438-12UN-2A	1.688-12UN-2A
	"B"	.44	.50	.67	.69	.69
	"C"	.44	.50	.50	.62	1.06
	"D"	.44	.50	.67	.69	.69
	"E"	.688-16UN-2A	.812-16UN-2A	1.188-12UN-2A	1.438-12UN-2A	1.688-12UN-2A
	"F" HEX	.75	.88	1.25	1.50	1.88