

Check Valves

Specifications

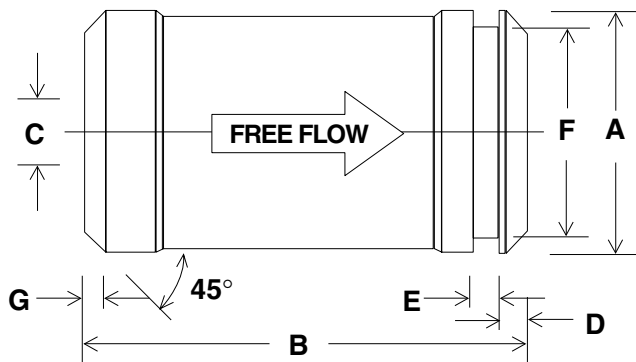

Flow Data

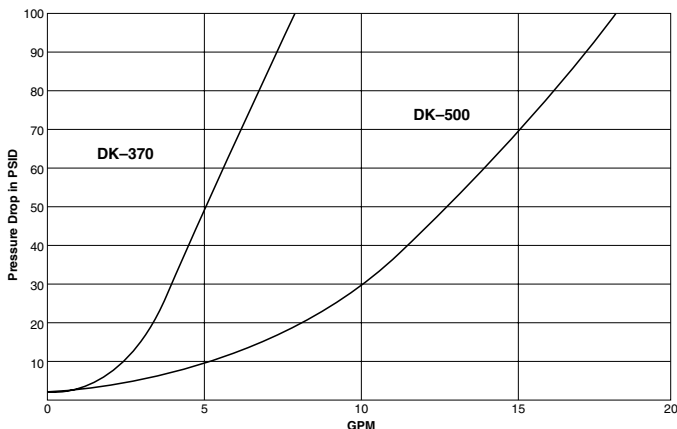

PART NUMBER	NOMINAL SIZE	A* DIA.	B*	C DIA.	D	E	F* DIA.	G	O-RING SIZE	NET WEIGHT	OPERATING PRESSURE	CRACK PRESSURE RANGE
DK-370	3/8"	.655 (Max) .650 (Min)	1.225 (Max) 1.215 (Min)	.19	.13	.11	.543 (Max) .538 (Min)	.09	015	.03 KG	3,000 PSI	5-85 PSI
DK-500	1/2"	.811 (Max) .806 (Min)	1.500 (Max) 1.490 (Min)	.30	.13	.11	.699 (Max) .695 (Min)	.09	017	.07 KG	3,000 PSI	5-100 PSI

* Min & Max designates manufacturing tolerance range.

Ordering Information
DK Series

Check Valves

DK - * * * - * *

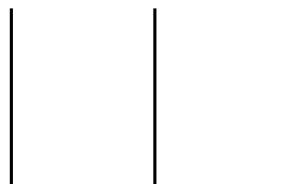

Standard Crack Pressure is 5 PSI.
Designate in 5 PSI increments.
Not to exceed Crack Pressure Range
for designated size.
Example: 5 = 5 PSI, 10 = 10 PSI.

SERIES SIZE

370 - 3/8"
500 - 1/2"

E Check Valves