

**4079 SERIES**

**FORGED BRASS MINI BALL VALVES  
(200 WOG) - ISO 9001**

Designed for commercial and industrial use with water, oil or gas. Extruded brass bar stock construction in a compact design makes this solid brass chrome plated valve versatile for many applications in small lines. This approved Webstone valve is actuated by a blowout proof stem and features reinforced Teflon® seats. Handle is made of zinc with an epoxy coating.

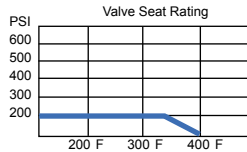
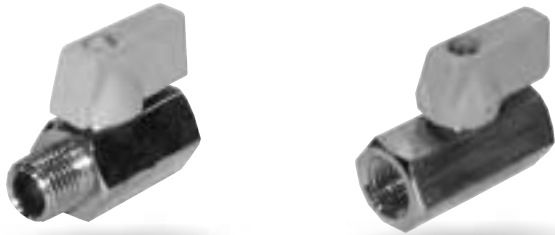

all Teflon® seated valves  
\*Maximum Temperature is 400°F @ 100 PSI\*

**PRESSURE RATING**  
200 WOG non-shock

1. Threaded ends comply with ANSI B1.20.1 (IPS threads only)
2. Teflon® seats withstand temperatures from -40°F to 400°F
3. Manufactured in an ISO 9001 Facility

Teflon® is a registered trademark of Dupont.

**40790 - 40792,  
40798  
(FIP x MIP)**

**40793 - 40796  
(FIP x FIP)**

**THIS SPACE FOR ARCHITECT / ENGINEER APPROVAL**

Job/Customer _____	Date _____	Contractor _____
Model Specified _____	Qty _____	Approved By _____
Designer/Engineer _____	Date _____	Contractor's PO # _____
Submitted by _____	Date _____	Other _____

1.	<b>BODY</b>	EXTRUDED BRASS BAR STOCK (ASTM B124-C37700)
2.	<b>CAP/BUSHING</b>	BRASS (ASTM B124-C37700)
3.	<b>SEATS</b>	TEFLON® (PTFE)
4.	<b>BALL</b>	BRASS / HARD CHROME PLATE
5.	<b>STEM</b>	BRASS (ASTM B124-C37700)
6.	<b>O-RING</b>	NEOPRENE
7.	<b>HANDLE</b>	ZINC w/EPOXY COATING
8.	<b>SCREW</b>	BRASS

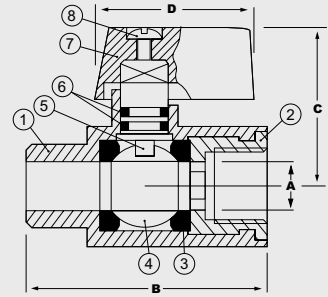

ITEM	SIZE	CTN/CS	A	B	C	D	Cv
40790	1/8" Mx 1/8" F	12/144	3/16	1 3/8	1 1/16	1 1/16	5.74
40791	1/4" Mx 1/4" F	12/144	1/8	1 9/16	1	1 1/16	7.51
40792	3/8" Mx 3/8" F	12/144	5/16	1 9/16	1 1/8	1 1/16	7.72
40798	1/2" Mx 1/2" F	12/144	3/8	1 3/4	1 1/4	1 1/4	7.72

Cv The number of gallons of water per minute that pass through the valve at a 1lb pressure drop.

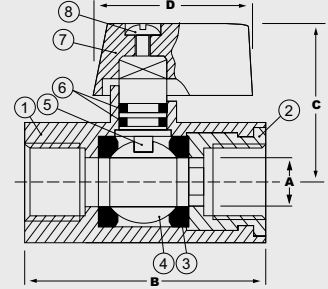

ITEM	SIZE	CTN/CS	A	B	C	D	Cv
40793	1/8" Fx 1/8" F	12/144	3/16	1 7/16	1 1/16	1 1/16	5.74
40794	1/4" Fx 1/4" F	12/144	1/4	1 9/16	1 1/16	1 1/16	7.51
40795	3/8" Fx 3/8" F	12/144	5/16	1 5/8	1 1/16	1 1/8	7.72
40796	1/2" Fx 1/2" F	12/144	3/8	1 3/4	1 1/4	1 1/4	7.51

Cv The number of gallons of water per minute that pass through the valve at a 1lb pressure drop.

**4078 SERIES**

**FORGED BRASS MINI PEX BALL VALVE  
INSERT x INSERT (FOR USE WITH PEX TUBING)  
(200 WOG) - ISO 9001**

Designed for residential or commercial use with PEX tubing. Extruded brass bar stock construction with an extra hard chrome plated brass ball sealed with reinforced Teflon® seats. This approved Webstone valve is actuated by a blowout proof stem. Handle is made of zinc with an epoxy coating.

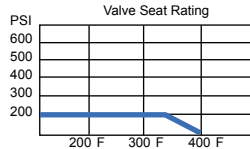

all Teflon® seated valves  
\*Maximum Temperature is 400°F @ 100 PSI\*

**PRESSURE RATING**  
200 WOG non-shock  
not for use with steam

1. Complies with NSF61-9
2. Teflon® seats withstand temperatures from -40°F to 400°F
3. Manufactured in an ISO 9001 Facility

Teflon® is a registered trademark of Dupont.

**THIS SPACE FOR DESIGNER / ENGINEER APPROVAL**

Job/Customer _____	Date _____	Contractor _____
Model Specified _____	Qty _____	Approved By _____
Designer/Engineer _____	Date _____	Contractor's PO # _____
Submitted by _____	Date _____	Other _____

1.	<b>BODY</b>	EXTRUDED BRASS BAR STOCK (ASTM B124-C37700)
2.	<b>SEATS</b>	TEFLON® (PTFE)
3.	<b>BALL</b>	BRASS / HARD CHROME PLATE
4.	<b>STEM</b>	BRASS (ASTM B62-C836000)
5.	<b>O-RING</b>	NEOPRENE
6.	<b>HANDLE</b>	ZINC w/EPOXY COATING
7.	<b>SCREW</b>	BRASS

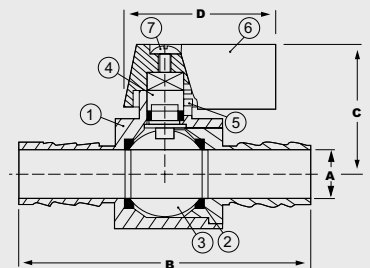

ITEM	SIZE	CTN/CS	A	B	C	D
40782	1/2" x 1/2"	12/144	3/8	2 1/4	1 1/4	1 1/8