

HDPE transition fitting set	part number	weight (lbs.)	list price
2" HDPE Transition Assembly	910 HDTGA2	5.00	192.53
3" HDPE Transition Assembly	910 HDTGA3	10.50	221.68
4" HDPE Transition Assembly	910 HDTGA4	19.00	276.66
6" HDPE Transition Assembly	910 HDTGA6	39.00	418.87
8" HDPE Transition Assembly	910 HDTGA7	58.00	706.73
10" HDPE Transition Assembly	911 HDTGA10	79.00	857.10
12" HDPE Transition Assembly	911 HDTGA12	160.00	1,116.43

10 & 12 inch transition fittings are A-Style fittings.

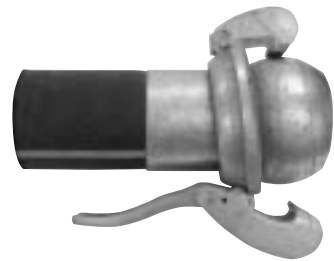

HDPE transition male fitting	part number	weight (lbs.)	list price
2" HDPE Transition Male	920 HDPEMG2	2.00	103.49
3" HDPE Transition Male	920 HDPEMG3	4.00	122.80
4" HDPE Transition Male	920 HDPEMG4	7.50	158.00
6" HDPE Transition Male	920 HDPEMG6	15.00	244.00
8" HDPE Transition Male	920 HDPEMG8	23.00	413.46
10" HDPE Transition Male	921 HDPEMG10	35.00	436.99
12" HDPE Transition Male	921 HDPEMG12	73.00	551.28

Price Includes Locking Rings.



HDPE transition female fitting	part number	weight (lbs.)	list price
2" HDPE Transition Female	940 HDPEFG2	2.00	89.05
3" HDPE Transition Female	940 HDPEFG3	4.00	98.88
4" HDPE Transition Female	940 HDPEFG4	7.50	118.67
6" HDPE Transition Female	940 HDPEFG6	15.00	173.99
8" HDPE Transition Female	940 HDPEFG8	23.00	293.27
10" HDPE Transition Female	941 HDPEFG10	35.00	420.11
12" HDPE Transition Female	941 HDPEFG12	73.00	565.15

10 & 12 inch transition fittings are A-Style fittings.

HDPE Fused Transition, High Pressure Fittings

stub ends HDPE SDR11  
inserts tapped & coned



completed fused hdpe pipe

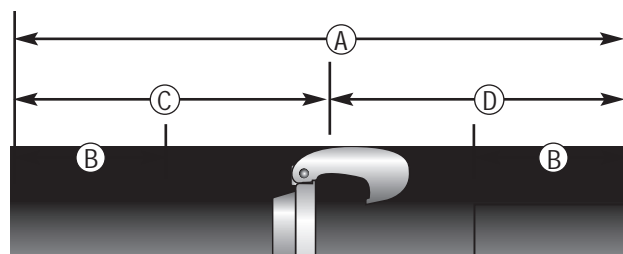

HDPE transition specs.	A	B	C	D
2" HDPE Transition	22.25	6.00	12.00	10.75
3" HDPE Transition	23.25	6.00	13.00	11.00
4" HDPE Transition	25.50	6.00	14.25	11.75
6" HDPE Transition	27.00	6.00	15.50	12.50
8" HDPE Transition	32.25	6.00	18.00	15.25



B-style fitting shown.

B-Style HDPE insert fittings	part number	weight (lbs.)	list price
2" Hose Set Assembly	275 HSA2	2.60	38.05
3" Hose Set Assembly	275 HSA3	5.30	59.40
4" Hose Set Assembly	275 HSA4	11.70	106.25
6" Hose Set Assembly	275 HSA6	21.70	189.40
8" Hose Set Assembly	275 HSA8	35.70	369.75



A-Style HDPE insert fittings	part number	weight (lbs.)	list price
10" Hose Set Assembly	276 HSA10	55.04	434.35
12" Hose Set Assembly*	276 HSA12	89.60	721.80

\* 12" Hose Set Assembly comes with a locking bar.

HDPE single bolt clamps	part number	weight (lbs.)	list price
2" HDPE Clamp	302 CS2	59-63	5.00
3" HDPE Clamp	302 CS3	85-91	8.00
4" HDPE Clamp	302 CS4	112-121	9.20
6" HDPE Clamp	302 CS6	162-174	14.50
8" HDPE Clamp	302 CS8	213-226	16.00
10" HDPE Clamp	302 CS10	265-278	38.00
12" HDPE Clamp	302 C12	317-330	45.20

HDPE Press-In Fittings

male hose barb

female hose barb



offset clamps between hose bars

HDPE specs.	P.S.I.*	Weight/Ft.	Clamp
2" SDR 11 / SDR 17	160/100	0.64/0.43	59-63
3" SDR 17 / SDR 21	100/80	0.93/0.77	85-91
4" SDR 17 / SDR 21 / SDR 26	100/80/64	1.54/1.26/1.03	112-121
6" SDR 17 / SDR 21 / SDR 26	100/80/64	3.34/2.73/2.23	162-174
8" SDR 21 / SDR 26 / SDR 32.5	80/64/51	4.64/3.79/3.05	213-226